



# Application for Public Hearing

## SPECIAL USE PERMITS

YOU MUST PROVIDE THE FOLLOWING INFORMATION: IF ADDITIONAL SPACE IS NEEDED, ATTACH EXTRA PAGES TO THE PETITION.

**Name of Business (If applicable):** Oak Park and River Forest High School District 200

**Address/Location of Property in Question:** 501 Lake Street, Oak Park, IL 60302  
(field on South side of Lake Street between East and Scoville)

**Property Identification Number(s)(PIN):** 16-07-226-014-0000

**Name of Property Owner(s):** Oak Park and River Forest High School District 200

**Address of Property Owner(s):** 201 N. Scoville, Ave. Oak Park, IL 60302

**E-Mail of Property Owner(s):** [gjohnson@oprfs.org](mailto:gjohnson@oprfs.org) or [rcanderson@oprfs.org](mailto:rcanderson@oprfs.org)

**Phone:** 708.434.3211

**If Land Trust, name(s) of beneficial owners:** N/A  
(A Certificate of Trust must be filed.)

**Name of Applicant(s):**  
Ronald Anderson  
Executive Director of Operations  
OPRFHS District 200  
708.434.3220  
[rcanderson@oprfs.org](mailto:rcanderson@oprfs.org)

**Project Contact:** Same as applicants above.

**Property Interest of Applicant(s):** Owner

**Existing Zoning:** OS: Open Space District  
Legal Description of the Property---Lot 4, Block Six, etc.

**Describe Proposal:** OPRFHS is asking to remove the four existing light poles and replace them with six new energy efficient light poles with reduced light spillage. The School District will comply with all of the conditions from 2002-O-52 with the exception of requesting an extension of the lighting ordinance from 8:00 p.m. to 10:00 p.m., which will benefit the Oak Park community.

Please see attached documents, including:

1. Site plan
2. Light illumination plan

**Size of Parcel (from Plat of Survey):** 137,174 Square Feet

<b>Adjacent:</b>	<b>Zoning Districts</b>	<b>Land Uses</b>
To the North:	I Institutional	Current D200 Campus
To the South:	Railroad Tracks R7 Multi Family	Railroad tracks separate property from residential property on South Blvd.
To the East:	OS Open Space District	PDOP Property (Ridgeland Common)
To the West:	R7 Multi Family	Residential Apartments

**How the property in question is currently improved?**

☐ Residential    ☒ Non-Residential    ☐ Mixed Use    ☐ OTHER: \_\_\_\_\_

Describe Improvement: Sports field improvements as detailed in attached site plan.

**Is the property in question currently in violation of the Zoning Ordinance?** No

**Is the property in question presently subject to a Special Use Permit?** Yes

See Ordinance 2002-O-52 (attached).

**Is the subject property located within any Historic District?** No

**From what Section(s) of the Zoning Ordinance are you requesting approval / relief?**

Article 9: Site Development Standards, Section 9.2 (E) 3

**Explain why, in your opinion, the grant of this request will be in harmony with the neighborhood and not contrary to the intent and purpose of the Zoning Ordinance or Comprehensive Plan.**

This request for revised lighting is to allow for a revised, but similar use of this athletic field. The proposed lighting to be installed will not exceed the height of the existing lighting and will meet current zoning light spillage requirements. The proposed lights to be installed will be more energy efficient than the existing lights.

The proposed revised use for the South Field necessitating this change will enable the District to revise the use of the District's current baseball and softball fields to provide on-campus track and field facilities. This will benefit District students and families significantly by enabling the District to provide these sports on campus, but it will also benefit the surrounding community as a whole by making these new facilities available to the community when not in use by the District.

- The track and field complex that will be able to be installed on D200's back fields will be a community asset for the benefit of D97, PDOP, and our community at large, consistent with the intent and use of D200's existing fields. As already noted, there is no other track and field complex available in Oak Park, forcing D97 to train and compete in a variety of locations. While D97 would not be able to use the D200 track on a daily basis for its programming, there is significant possibility for limited use as a practice and competition hosting site.
- Additionally, the current 250M walking track on the South fields would be replaced by the new 8 lane 400M competition track. This track would be available to the community on off hours, similar to the current availability of the existing walking track.

Additionally, the District will work with the Park District through an Inter-Governmental Agreement allowing the District use of the Ridgeland Common Fields in exchange for Park District provide programming use for the community on all of school Districts fields immediately following school practices. This project as a whole will benefit the District, the Park District of Oak Park, and the surrounding community as a whole. It will replace aging facilities with new, improved facilities that should have a positive impact on property values and neighborhood aesthetics. Without the lights at the south field as detailed in this application, we would not be able to meet the usage needs of the park district and the entire project would not be feasible.

I (we) certify that all the above statements and the statements contained in any papers or plans submitted herewith are true to the best of my (our) knowledge and belief.

I (we) consent to the entry in or upon the premises described in this application by any authorized official of the Village of Oak Park for the purpose of securing information, posting, maintaining and removing such notices as may be required by law.

Ronald Anderson

\_\_\_\_\_  
(Printed Name) Applicant

\_\_\_\_\_  
(Signature) Applicant

6/29/2022

\_\_\_\_\_  
Date

Dr. Gregory Johnson

\_\_\_\_\_  
(Printed Name) Owner

\_\_\_\_\_  
(Signature) Owner

6/29/2022

\_\_\_\_\_  
Date

**Owner's Signature must be notarized**

SUBSCRIBED AND SWORN TO BEFORE ME THIS

29 DAY OF June, 2022

\_\_\_\_\_  
(Notary Public)



Updated August 2021

## Response to the Standards for Special Use

1. The establishment, maintenance, and operation of the proposed special use will not have a substantial or unduly adverse impact on the neighborhood or endanger the public health, safety, or welfare.

The proposed changes would replace an existing condition with a similar one. These lights pose no danger to public health safety, or welfare. There are four existing taller lights with greater light spill at the property line than the proposed six shorter lights. We expect this to be an improved condition for the neighborhood.
2. The proposed special use is compatible with the general land use of adjacent properties and other property within the immediate vicinity.

The adjacent properties are the District itself, Park District facilities, and multi-family residential properties. The use of the existing site would be of a similar type and duration as the existing use.
3. The special use in the specific location proposed is consistent with the spirit and intent of this Ordinance, adopted land use policies and the Comprehensive Plan.

The special use is consistent with the above stated items and is consistent with the current special use permit previously approved for this site.
4. The special use meets the requirements for such classification in this Ordinance.

The special use meets the requirements.



ELEVATION DATUM: VILLAGE OF OAK PARK VERTICAL DATUM (BASED ON CHICAGO CITY DATUM - (NGVD 1929 ELEVATIONS) (MONUMENT INFORMATION PROVIDED BY THE VILLAGE OF OAK PARK):

REFERENCE STATION: MONUMENT 2 - MAIN FIRE STATION, ROD WITH SLEEVE SET EAST OF EUCLID AVENUE AND NORTH OF NORTH BOULEVARD IN FRONT OF THE MAIN FIRE STATION IN OAK PARK, ILLINOIS. ELEVATION - 41.104

SITE BENCHMARKS:

SITE BM #1 - ARROW BOLT ON FIRE HYDRANT AT THE NORTHWEST CORNER OF LAKE STREET AND EAST AVENUE. ELEVATION - 42.48

SITE BM #2 - ARROW BOLT ON FIRE HYDRANT AT THE NORTHWEST CORNER OF LAKE STREET AND ELMWOOD AVENUE. ELEVATION - 41.53

# TOPOGRAPHIC SURVEY

OAK PARK RIVER FOREST HIGH SCHOOL CAMPUS  
OAK PARK, ILLINOIS

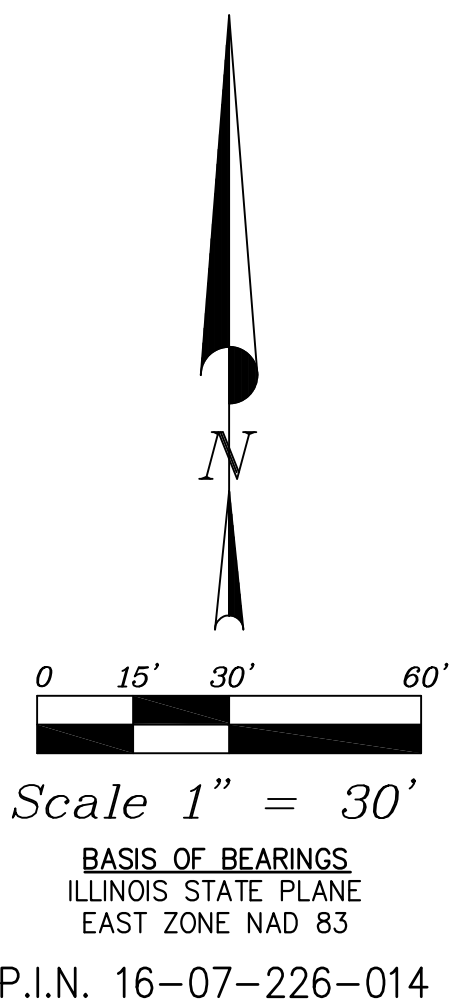

## LEGEND

- Bush (Deciduous)
- Bush (Evergreen)
- Cable TV Pedestal
- Drainage Structure Round
- Drainage Structure Square
- Electric Handhole
- Electric Transformer
- Electric Meter
- Electric Pedestal
- Fire Hydrant
- Flag Pole
- Gas Valve
- Light Pole
- Light Pole (Mast Arm)
- Post, Fence Corner
- Power Pole
- Power Pole Lighted
- Power Pole w/ Transformer
- Sanitary Sewer Manhole
- Sign
- Storm Sewer Manhole
- Telephone Manhole
- Telephone Pedestal
- Telephone Junction Box
- Traffic Signal
- Traffic Signal Cantilever
- Traffic Signal Box
- Traffic Signal Vault
- Tree Deciduous (X"= Size)
- Tree Evergreen (X"= Size)
- Water Valve
- Water Valve Vault

- OHE Overhead Electric Line
- E Underground Electric Line
- G Underground Gas Main
- S Sanitary Sewer
- ST Storm Sewer
- OHT Overhead Telephone Line
- T Underground Telephone Line
- W Underground Water Main
- X Fence Line

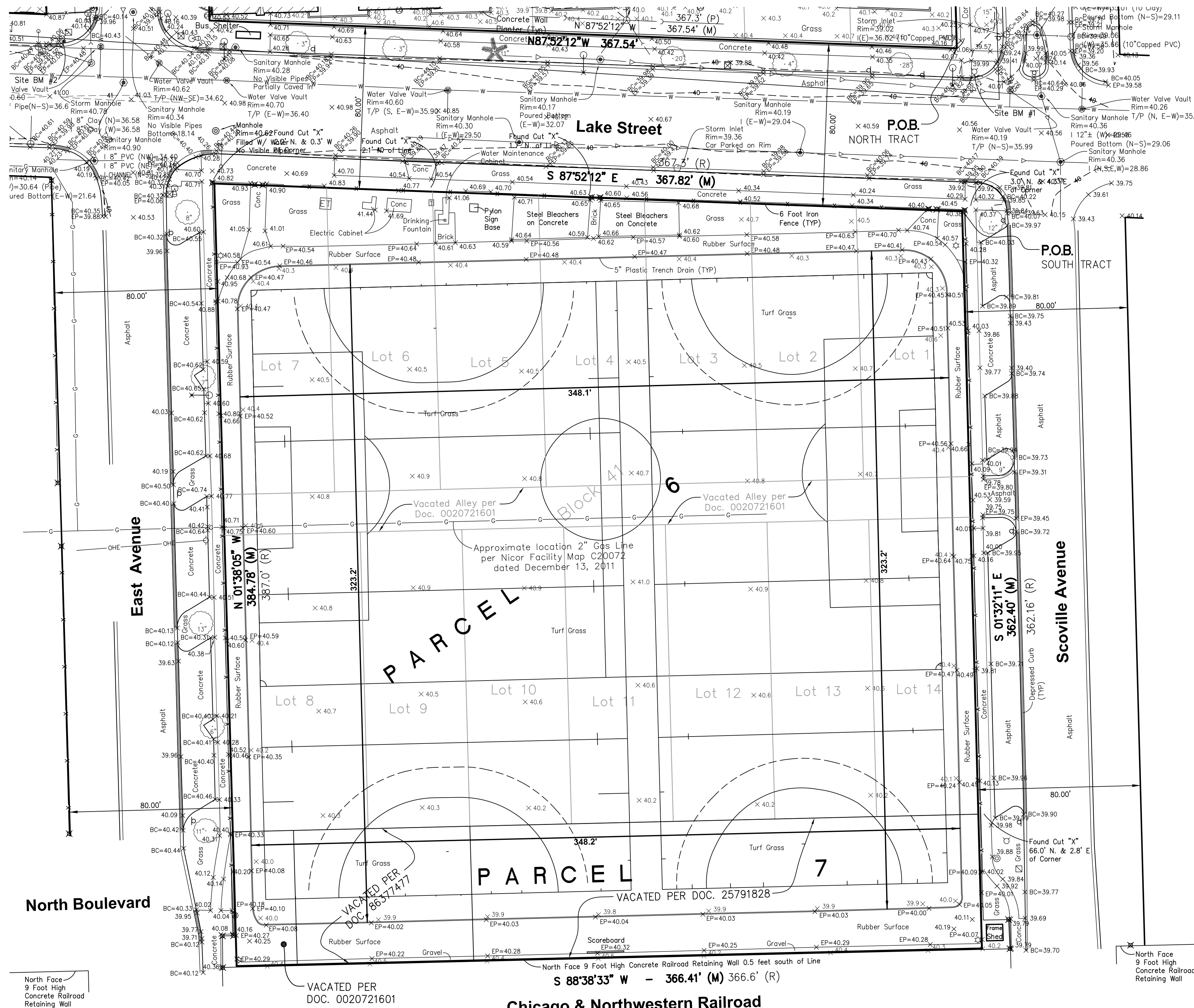

UTILITY STATEMENT  
J.U.L.I.E. Dig # X2231075

THE UNDERGROUND UTILITIES SHOWN HAVE BEEN LOCATED FROM THE FIELD SURVEY INFORMATION AND EXISTING DRAWINGS. THE SURVEYOR MAKES NO GUARANTEES THAT THE UNDERGROUND UTILITIES SHOWN COMPRISE ALL SUCH UTILITIES IN THE AREA, EITHER IN SERVICE OR ABANDONED. THE SURVEYOR FURTHER DOES NOT WARRANT THAT THE UNDERGROUND UTILITIES SHOWN ARE IN THE EXACT LOCATION INDICATED ALTHOUGH HE DOES CERTIFY THAT THEY ARE LOCATED AS ACCURATELY AS POSSIBLE FROM INFORMATION AVAILABLE. THE SURVEYOR HAS NOT PHYSICALLY LOCATED THE UNDERGROUND UTILITIES.

## NOTES:

ALL MEASUREMENTS ARE IN FEET AND DECIMALS THEREOF.

(R) DENOTES RECORD INFORMATION. (M) DENOTES MEASURED INFORMATION.

THIS SURVEY WAS PREPARED WITHOUT BENEFIT OF CURRENT TITLE COMMITMENTS.

ACCORDING TO A SCALED INTERPRETATION OF THE FEDERAL EMERGENCY MANAGEMENT AGENCY FLOOD INSURANCE RATE MAP HAVING A MAP NUMBER OF 17031C0395J FOR COOK COUNTY, ILLINOIS, AND INCORPORATED AREAS, THE SUBJECT TRACT FALLS WITHIN PANEL NUMBER 17031C0395J. ACCORDING TO THIS MAP INDEX SHEET WHICH HAS A MAP REVISION DATE OF AUGUST 19, 2008, PANEL NUMBER 17031C0395J WAS NOT PRINTED BECAUSE IT CONTAINS NO SPECIAL FLOOD HAZARD AREAS.

Surveyors Certificate

State of Illinois )  
County of DuPage )

I, Timothy G. Wolfe, an Illinois Professional Land Surveyor, do hereby certify that the Plat shown hereon is a correct representation of a Topographic Survey, performed at and under my direction, to the best of my knowledge and belief. Latest date of field activity for this sheet is September 27, 2012.

This professional service conforms to the current Illinois Minimum Standards for a boundary survey.

All dimensions shown in feet and decimal parts thereof.

Given under my hand and seal on this 14th day of December in the year 2015.

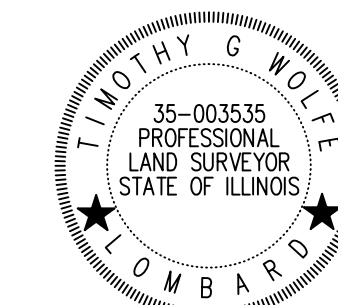

Timothy G. Wolfe  
Jacob & Hefner Associates, Inc.  
Illinois Professional Land Surveyor No. 035-003535  
My current license expires November 30, 2016

Survey No.:	E 8 4 8 e
Ordered By.:	Legat Architects
Description:	Topographic Survey
Date Prepared:	August 31, 2012
Scale:	1" = 30'
Field Work:	KW/BSS
Prepared By:	TGW/REW



**JACOB & HEFNER ASSOCIATES, INC.**  
1910 S. Highland Avenue, Suite 100, Lombard, IL 60148  
PHONE: (630) 652-4600, FAX: (630) 652-4601  
www.jacobandhefner.com  
Illinois Professional Design Firm  
License No. 184-003073 Exp. 4/30/17

# TOPOGRAPHIC SURVEY

OAK PARK RIVER FOREST HIGH SCHOOL CAMPUS  
OAK PARK, ILLINOIS

OAK PARK AND RIVER FOREST HIGH SCHOOL PROPERTY

NORTH TRACT

PARCEL 1:  
LOTS 1 TO 12, INCLUSIVE AND THE VACATED ALLEY LYING WITHIN (ACCORDING TO VACATION DOCUMENT NUMBERS 19207081, 19967755 AND 17970058) AND THE NORTH 1/2 OF VACATED ONTARIO STREET LYING SOUTH OF LOTS 6 AND 7 (ACCORDING TO THE VACATION DOCUMENT NUMBER 18679926) ALL IN BLOCK 21 IN JAMES SCOVILLE'S SUBDIVISION OF THE WEST 1/2 OF THE NORTHEAST 1/4 OF SECTION 7, TOWNSHIP 39 NORTH, RANGE 13, EAST OF THE THIRD PRINCIPAL MERIDIAN, IN COOK COUNTY, ILLINOIS.

PARCEL 2:  
LOTS 22 TO 43, INCLUSIVE AND THE VACATED ALLEY LYING WITHIN (ACCORDING TO VACATION DOCUMENT NUMBERS 5729644 AND 5738854) AND THE SOUTH 1/2 OF VACATED ONTARIO STREET LYING NORTH OF LOTS 22 AND 43 (ACCORDING TO VACATION DOCUMENT NUMBER 18679926) ALL IN BLOCK 22 IN C.B. SCOVILLE'S SUBDIVISION OF LOT 22 JAMES W. SCOVILLE'S SUBDIVISION OF THE WEST 1/2 OF THE NORTHEAST 1/4 OF SECTION 7, TOWNSHIP 39 NORTH, RANGE 13, EAST OF THE THIRD PRINCIPAL MERIDIAN, IN COOK COUNTY, ILLINOIS.

PARCEL 3:  
LOTS 1 TO 18, INCLUSIVE AND THE VACATED ALLEY LYING WITHIN (ACCORDING TO THE VACATION DOCUMENT NUMBER 5302734) AND THE NORTH 1/2 OF VACATED ONTARIO STREET LYING SOUTH OF LOTS 9 AND 10 (ACCORDING TO THE VACATION DOCUMENT NUMBER 19826002) ALL IN BLOCK 27 IN THE VILLAGE OF RIDGELAND, BEING SUBDIVISION OF THE EAST HALF OF THE EAST HALF OF SECTION 7, THE NORTH WEST QUARTER AND THE WEST HALF OF THE WEST OF THE SOUTH WEST QUARTER OF SECTION 8, ALL IN TOWNSHIP NORTH, RANGE 13, EAST OF THE THIRD PRINCIPAL MERIDIAN IN COOK COUNTY, ILLINOIS.

PARCEL 4:  
LOTS 1 TO 25, INCLUSIVE AND THE VACATED ALLEYS LYING WITHIN (ACCORDING TO THE VACATION DOCUMENT NUMBERS 9521350 AND 23510004) AND THE SOUTH 1/2 OF VACATED ONTARIO STREET LYING NORTH OF LOTS 1 AND 25 (ACCORDING TO THE VACATION DOCUMENT NUMBER 19826002) ALL IN BLOCK 28 IN THE VILLAGE OF RIDGELAND, BEING SUBDIVISION OF THE EAST HALF OF THE EAST HALF OF SECTION 7, THE NORTH WEST QUARTER AND THE WEST HALF OF THE WEST OF THE SOUTH WEST QUARTER OF SECTION 8, ALL IN TOWNSHIP NORTH, RANGE 13, EAST OF THE THIRD PRINCIPAL MERIDIAN IN COOK COUNTY, ILLINOIS.

PARCEL 5:  
THE EAST 1/2 OF VACATED EAST AVENUE FALLING WITHIN ONTARIO STREET AND THAT PART OF EAST AVENUE LYING WEST OF AND ADJOINING LOTS 17 TO 25, INCLUSIVE, IN BLOCK 28 AND LOTS 10 TO 18, INCLUSIVE, IN BLOCK 27 (ACCORDING TO THE VACATION DOCUMENT NUMBER 20629663) IN THE VILLAGE OF RIDGELAND, BEING SUBDIVISION OF THE EAST HALF OF THE EAST HALF OF SECTION 7, THE NORTH WEST QUARTER AND THE WEST HALF OF THE WEST OF THE SOUTH WEST QUARTER OF SECTION 8, ALL IN TOWNSHIP NORTH, RANGE 13, EAST OF THE THIRD PRINCIPAL MERIDIAN IN COOK COUNTY, ILLINOIS.

THE ABOVE FIVE PARCELS BEING BOUNDED AS FOLLOWS:

LOTS 1 TO 12, INCLUSIVE AND THE VACATED ALLEY LYING WITHIN (ACCORDING TO VACATION DOCUMENT NUMBERS 19207081, 19967755 AND 17970058) ALL IN BLOCK 21 IN JAMES W. SCOVILLE'S SUBDIVISION OF THE WEST 1/2 OF THE NORTHEAST 1/4 OF SECTION 7, ACCORDING TO THE PLAT RECORDED FEBRUARY 26, 1883, AS DOCUMENT NUMBER 450231; AND  
LOTS 22 TO 43, INCLUSIVE AND THE VACATED ALLEY LYING WITHIN (ACCORDING TO VACATION DOCUMENT NUMBERS 5729644 AND 5738854) ALL IN C.B. SCOVILLE'S SUBDIVISION OF LOT 22 IN JAMES W. SCOVILLE'S SUBDIVISION OF THE WEST 1/2 OF THE NORTHEAST 1/4 OF SECTION 7, ACCORDING TO THE PLAT RECORDED JUNE 20, 1911, AS DOCUMENT NUMBER 4779607; AND  
ALL OF VACATED ONTARIO STREET (FORMERLY CEDAR STREET) (ACCORDING TO THE VACATION DOCUMENT NUMBER 18679926) LYING SOUTH OF BLOCK 21 IN SAID JAMES W. SCOVILLE'S SUBDIVISION, LYING NORTH OF SAID C.B. SCOVILLE'S SUBDIVISION, LYING EAST OF LINDEN AVENUE AND LYING WEST OF EAST AVENUE; AND  
LOTS 1 TO 18, INCLUSIVE AND THE VACATED ALLEY LYING WITHIN (ACCORDING TO THE VACATION DOCUMENT NUMBER 5302734) ALL IN BLOCK 27 IN THE VILLAGE OF RIDGELAND, BEING A SUBDIVISION OF THE EAST HALF OF THE EAST HALF OF SECTION 7, AND THE NORTHWEST QUARTER AND THE WEST HALF OF THE WEST HALF OF THE SOUTHWEST QUARTER OF SECTION 8, ACCORDING TO THE PLAT RECORDED MARCH 2, 1872, AS DOCUMENT NUMBER 16125; AND  
LOTS 1 TO 25, INCLUSIVE AND THE VACATED ALLEYS LYING WITHIN (ACCORDING TO THE VACATION DOCUMENT NUMBERS 9521350 AND 23510004) ALL IN BLOCK 28 IN THE VILLAGE OF RIDGELAND, BEING A SUBDIVISION OF THE EAST HALF OF THE EAST HALF OF SECTION 7, AND THE NORTHWEST QUARTER AND THE WEST HALF OF THE WEST HALF OF THE SOUTHWEST QUARTER OF SECTION 8, ACCORDING TO THE PLAT RECORDED MARCH 2, 1872, AS DOCUMENT NUMBER 16125; AND  
ALL OF VACATED ONTARIO STREET (FORMERLY CEDAR STREET) (ACCORDING TO THE VACATION DOCUMENT NUMBER 19826002) LYING SOUTH OF BLOCK 27 IN SAID RIDGELAND SUBDIVISION, LYING NORTH OF BLOCK 28 IN SAID RIDGELAND SUBDIVISION, LYING EAST OF EAST AVENUE AND LYING WEST OF SCOVILLE AVENUE; AND  
ALL OF VACATED EAST AVENUE (ACCORDING TO THE VACATION DOCUMENT NUMBER 20629663) LYING EAST OF BLOCK 21 IN SAID JAMES W. SCOVILLE'S SUBDIVISION, LYING EAST OF SAID C.B. SCOVILLE'S SUBDIVISION, LYING WEST OF BLOCK 27 OF SAID RIDGELAND SUBDIVISION, LYING WEST OF BLOCK 28 OF SAID RIDGELAND SUBDIVISION, LYING SOUTH OF ERIE STREET (FORMERLY CHESTNUT STREET), AND LYING NORTH OF THE WESTERLY EXTENSION OF THE SOUTHERN LINE OF LOT 17 IN BLOCK 28 OF SAID RIDGELAND SUBDIVISION, ALL IN TOWNSHIP 39 NORTH, RANGE 13 EAST, OF THE THIRD PRINCIPAL MERIDIAN, IN COOK COUNTY, ILLINOIS, BEING BOUNDED AS FOLLOWS:

BEGINNING AT THE SOUTHEASTERN CORNER OF LOT 10 IN BLOCK 28 IN SAID RIDGELAND SUBDIVISION; THENCE NORTH 87 DEGREES 52 MINUTES 12 SECONDS WEST (ASSUMED BEARINGS) ALONG THE SOUTHERN LINE OF LOTS 10 THROUGH 16 INCLUSIVE OF BLOCK 28 OF SAID RIDGELAND SUBDIVISION 367.54 FEET TO THE SOUTHWESTERN CORNER OF SAID LOT 16; THENCE NORTH 01 DEGREES 39 MINUTES 46 SECONDS WEST ALONG THE WESTERN LINE OF SAID LOT 16 AND ITS NORTHERLY EXTENSION 150.32 FEET TO THE SOUTHWESTERN CORNER OF LOT 17 IN BLOCK 28 OF SAID RIDGELAND SUBDIVISION, SAID POINT ALSO BEING THE SOUTHEASTERN CORNER OF THE AFORESAID VACATED EAST AVENUE PER DOCUMENT NUMBER 20629663; THENCE SOUTH 88 DEGREES 19 MINUTES 26 SECONDS WEST ALONG THE SOUTHERN LINE OF SAID VACATED EAST AVENUE 80.00 FEET TO THE SOUTHWESTERN CORNER OF SAID VACATED EAST AVENUE, SAID POINT ALSO LYING ON THE EASTERN LINE OF LOT 35 IN SAID C.B. SCOVILLE'S SUBDIVISION; THENCE SOUTH 01 DEGREES 39 MINUTES 46 SECONDS EAST ALONG THE EASTERN LINE OF LOTS 35, 34 AND 33 OF SAID C.B. SCOVILLE'S SUBDIVISION 144.92 FEET TO THE SOUTHEASTERN CORNER OF SAID LOT 33; THENCE NORTH 87 DEGREES 53 MINUTES 37 SECONDS WEST ALONG THE SOUTHERN LINE OF LOTS 33 AND 32 IN SAID C.B. SCOVILLE'S SUBDIVISION 350.54 FEET TO THE SOUTHWESTERN CORNER OF SAID LOT 32; THENCE NORTH 01 DEGREES 34 MINUTES 21 SECONDS WEST ALONG THE WESTERN LINE OF LOTS 32 THROUGH 22 INCLUSIVE WITHIN SAID C.B. SCOVILLE'S SUBDIVISION 555.63 FEET TO THE NORTHWESTERN CORNER OF SAID LOT 22, SAID POINT ALSO BEING THE SOUTHWESTERN CORNER OF VACATED ONTARIO STREET PER VACATION DOCUMENT NUMBER 18679926; THENCE NORTH 01 DEGREES 19 MINUTES 21 SECONDS WEST ALONG THE WESTERN LINE OF SAID VACATED ONTARIO STREET 66.00 FEET TO THE NORTHWESTERN CORNER OF SAID VACATED ONTARIO STREET AND TO THE SOUTHWESTERN CORNER OF LOT 7 IN SAID BLOCK 21 IN JAMES W. SCOVILLE'S SUBDIVISION; THENCE NORTH 01 DEGREES 33 MINUTES 21 SECONDS WEST ALONG THE WESTERN LINE OF LOTS 7 THROUGH 12 IN SAID BLOCK 21 IN JAMES W. SCOVILLE'S SUBDIVISION 429.00 FEET TO THE NORTHWESTERN CORNER OF SAID LOT 12 IN SAID BLOCK 21 IN JAMES W. SCOVILLE'S SUBDIVISION; THENCE NORTH 88 DEGREES 27 MINUTES 17 SECONDS EAST ALONG THE NORTHERN LINE OF LOTS 12 AND 1 IN SAID BLOCK 21 IN JAMES W. SCOVILLE'S SUBDIVISION 349.00 FEET TO THE NORTHEASTERN CORNER OF SAID LOT 1, SAID POINT ALSO BEING THE NORTHWESTERN CORNER OF THE AFORESAID VACATED EAST AVENUE PER DOCUMENT 20629663; THENCE NORTH 88 DEGREES 32 MINUTES 36 SECONDS EAST ALONG THE NORTHERN LINE OF THE AFORESAID VACATED EAST AVENUE 80.00 FEET TO THE NORTHEASTERN CORNER OF THE AFORESAID VACATED EAST AVENUE, SAID POINT ALSO BEING THE NORTHWESTERN CORNER OF SAID LOT 18 IN BLOCK 27 OF RIDGELAND SUBDIVISION; THENCE NORTH 88 DEGREES 07 MINUTES 34 SECONDS EAST ALONG THE NORTHERN LINE OF LOT 18 AND LOT 1 A DISTANCE OF 367.55 FEET TO THE NORTHEASTERN CORNER OF LOT 1 IN SAID BLOCK 27 OF RIDGELAND SUBDIVISION; THENCE SOUTH 01 DEGREES 32 MINUTES 38 SECONDS EAST ALONG THE EASTERN LINE OF LOTS 1 THROUGH 9 INCLUSIVE IN BLOCK 27 OF SAID RIDGELAND SUBDIVISION 428.50 FEET TO THE SOUTHEASTERN CORNER OF SAID LOT 9, SAID POINT ALSO BEING THE NORTHEASTERN CORNER OF THE VACATED ONTARIO STREET PER THE VACATION DOCUMENT NUMBER 19826002; THENCE SOUTH 01 DEGREES 33 MINUTES 10 SECONDS EAST ALONG THE EASTERN LINE OF SAID VACATED ONTARIO STREET 66.00 FEET TO THE SOUTHEASTERN CORNER OF SAID VACATED ONTARIO STREET, SAID POINT ALSO BEING THE NORTHEASTERN CORNER OF LOT 1 OF BLOCK 28 IN SAID RIDGELAND SUBDIVISION; THENCE SOUTH 01 DEGREES 33 MINUTES 37 SECONDS EAST ALONG THE EASTERN LINE OF LOTS 1 THROUGH 10 INCLUSIVE IN BLOCK 28 OF SAID RIDGELAND SUBDIVISION 609.21 FEET TO THE POINT OF BEGINNING, CONTAINING 845,772 SQUARE FEET OR 19.416 ACRES, MORE OR LESS.

OAK PARK AND RIVER FOREST HIGH SCHOOL PROPERTY

SOUTH TRACT

PARCEL 6:  
LOTS 1 TO 14, INCLUSIVE AND THE VACATED ALLEY LYING WITHIN (ACCORDING TO VACATION DOCUMENT NUMBER 0020721601), ALL IN BLOCK 41 IN RIDGELAND, A SUBDIVISION OF THE EAST HALF OF THE EAST HALF OF SECTION 7, AND THE NORTHWEST QUARTER AND THE WEST HALF OF THE WEST HALF OF THE SOUTHWEST QUARTER OF SECTION 8, TOWNSHIP 39 NORTH, RANGE 13, EAST OF THE THIRD PRINCIPAL MERIDIAN, IN COOK COUNTY, ILLINOIS.

PARCEL 7:  
ALL OF VACATED NORTH BOULEVARD LYING SOUTH OF AND ADJOINING LOTS 8 THROUGH 14 INCLUSIVE (ACCORDING TO VACATION DOCUMENT NUMBERS 25791828, 86377477, AND 0020721601), ALL IN BLOCK 41 IN VILLAGE OF RIDGELAND, A SUBDIVISION OF THE EAST HALF OF THE EAST HALF OF SECTION 7, AND THE NORTHWEST QUARTER AND THE WEST HALF OF THE WEST HALF OF THE SOUTHWEST QUARTER OF SECTION 8, TOWNSHIP 39 NORTH, RANGE 13 EAST OF THE THIRD PRINCIPAL MERIDIAN IN COOK COUNTY, ILLINOIS.

THE ABOVE TWO PARCELS BEING BOUNDED AS FOLLOWS:

LOTS 1 TO 14, INCLUSIVE AND THE VACATED ALLEY LYING WITHIN (ACCORDING TO VACATION DOCUMENT NUMBER 0020721601) ALL IN BLOCK 41 IN RIDGELAND, A SUBDIVISION OF THE EAST HALF OF THE EAST HALF OF SECTION 7, AND THE NORTHWEST QUARTER AND THE WEST HALF OF THE WEST HALF OF THE SOUTHWEST QUARTER OF SECTION 8 ACCORDING TO THE PLAT RECORDED MARCH 2, 1872, AS DOCUMENT NUMBER 16125; AND  
ALL OF VACATED NORTH BOULEVARD (ACCORDING TO THE VACATION DOCUMENT NUMBERS 25791828, 86377477, AND 0020721601) LYING SOUTH OF LOTS 8 THROUGH 14 INCLUSIVE IN BLOCK 41 IN SAID RIDGELAND SUBDIVISION, LYING NORTH OF THE CHICAGO AND NORTHWESTERN RAILROAD, LYING EAST OF EAST AVENUE AND LYING WEST OF SCOVILLE AVENUE, ALL IN TOWNSHIP 39 NORTH, RANGE 13 EAST, OF THE THIRD PRINCIPAL MERIDIAN, IN COOK COUNTY, ILLINOIS, BEING BOUNDED AS FOLLOWS:

BEGINNING AT THE NORTHEASTERN CORNER OF LOT 1 IN BLOCK 41 OF SAID RIDGELAND SUBDIVISION;  
THENCE SOUTH 01 DEGREES 32 MINUTES 11 SECONDS EAST (ASSUMED BEARINGS) ALONG THE EASTERN LINE OF LOT 1 AND LOT 14 AND ITS SOUTHERLY EXTENSION 362.40 FEET TO THE SOUTHEASTERN CORNER OF THE VACATED NORTH BOULEVARD PER DOCUMENT NUMBER 25791828; THENCE SOUTH 88 DEGREES 38 MINUTES 33 SECONDS WEST ALONG THE SOUTHERN LINE OF VACATED NORTH BOULEVARD PER DOCUMENT NUMBERS 25791828, 86377477, AND 0020721601 A DISTANCE OF 366.41 FEET TO THE SOUTHWESTERN CORNER OF VACATED NORTH BOULEVARD PER DOCUMENT NUMBER 0020721601; THENCE NORTH 01 DEGREES 38 MINUTES 05 SECONDS WEST ALONG THE WESTERN LINE OF THE VACATED NORTH BOULEVARD PER SAID DOCUMENT NUMBER 0020721601 AND ALONG THE WESTERN LINE OF LOT 8 AND LOT 7 IN BLOCK 41 OF SAID RIDGELAND SUBDIVISION 384.78 FEET TO THE NORTHWESTERN CORNER OF SAID LOT 7; THENCE SOUTH 87 DEGREES 52 MINUTES 12 SECONDS EAST ALONG THE NORTHERN LINES OF LOTS 7 THROUGH 1 INCLUSIVE IN BLOCK 41 OF SAID RIDGELAND SUBDIVISION 367.82 FEET TO THE POINT OF BEGINNING, CONTAINING 137,004 SQUARE FEET OR 3.145 ACRES, MORE OR LESS.

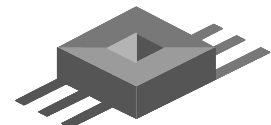

**JACOB & HEFNER**  
ASSOCIATES  
1910 S. Highland Avenue, Suite 100, Lombard, IL 60148  
PHONE: (630) 652-4600, FAX: (630) 652-4601  
www.jacobandhefner.com  
Illinois Professional Design Firm  
License No. 184-003073 Exp. 4/30/17

Survey No.:	E 8 4 8 e		
Ordered By.:	Legat Architects		
Description:	Topographic Survey		
Date Prepared:	August 16, 2016		
Scale:	1" = 30'	Field Work:	N/A
		Prepared By:	REW



# Oak Park and River Forest High School District 200

## PROJECT ADDRESS

**OWNER:**

# Oak Park and River Forest High School District 200

## OWNER ADDRESS

**ISSUANCE:**

ISSUED FOR SPECIAL USE PERMIT, June 29, 2022



**FGM Architects Inc.**  
1211 W 22nd St, Suite 700  
Oak Brook, Illinois 60523  
Phone : 630.574.8300  
Fax : 630.574.7070  
[www.fgmarchitects.com](http://www.fgmarchitects.com)

**Eriksson Engineering Associates, Ltd.**  
145 Commerce Dr, Suite A  
Grayslake, Illinois 60030  
Phone: 847.223.4804

**AMSCO Engineering**  
5115 Belmont Road  
Downers Grove, Illinois 60515  
Phone: 630.515.1555  
Fax: 630.515.1583

**Pepper Construction Company**  
411 Lake Zurich Road  
Barrington, IL 60010  
Phone: 847.381.2760  
Fax: 847.304.6510

EXPIRES:
SIGNATURE:
DATE SIGNED:

EXPIRES:	
SIGNATURE:	
DATE SIGNED:	

<div style="border: 1px solid black; height: 150px; width: 100%;"></div>
EXPIRES:
SIGNATURE:
DATE SIGNED:

<div style="border: 1px solid black; height: 150px; width: 100%;"></div>
EXPIRES:
SIGNATURE:
DATE SIGNED:

**fgma**

**FGM Architects Inc.**  
1211 W 22nd St, Suite 700  
Oak Brook, Illinois 60523

630.574.8300 OFFICE  
630.574.7070 FAX

ILLINOIS PROFESSIONAL DESIGN  
FIRM #184-000350

**CIVIL / LANDSCAPE**  
**Eriksson Engineering Associates, Ltd.**  
 145 Commerce Dr, Suite A  
 Grayslake, IL 60030  
 Phone: 847.223.4804

**M.E.P.**  
**AMSCO ENGINEERING**  
5115 BELMONT ROAD  
DOWNERS GROVE, ILLINOIS 60515  
Phone: 630.515.1555

**CONSTRUCTION MANAGER**  
**PEPPER CONSTRUCTION COMPANY**  
411 LAKE ZURICH ROAD  
BARRINGTON, ILLINOIS 60010  
Phone: 847.381.2760

[illegible]

<p><b>Oak Park and River Forest High School</b>  <b>District 200</b>  <b>TRACK AND FIELD - SOUTH FIELD LIGHTING</b>  Oak Park and River Forest High School District 200  201 N. Scoville Ave, Oak Park, IL 60302</p>	<p><b>ISSUED FOR SPECIAL USE PERMIT</b></p>
--	---

<b>COVER SHEET</b>	
<b>SHEET NO.</b>	
<b>G0.0.0</b>	
<b>JOB NO. 21-3098.05</b>	
<b>© 2022 FGM Architects Inc.</b>	

INDEX OF DRAWINGS	
SHEET NUMBER	SHEET NAME
GENERAL	
G0.0.0	COVER SHEET
CIVIL	
C1.1	SITE GEOMETRY PLAN
ELECTRICAL	
E0.01	PROJECT SUMMARY
E0.02	ILLUMINATION STUDY
E0.03	PROPERTY SPILL (HORIZONTAL FOOTCANDLES)
E0.04	PROPERTY SPILL (CANDELA PER FIXTURE)
	EQUIPMENT LOCATION





## LEGEND

1. The Location of Existing Underground Utilities, Such As Watermains, Sewers, Gas Lines Etc. As Shown On The Plans, Has Been Determined From The Best Available Information and Is Given For The Convenience Of The Contractor, However, The Owner and The Engineer Do Not Assume Responsibility For The Accuracy Of The Location. Construction, Utilities Other Than Those Shown May Be Encountered, and That The Actual Location of Those Which Are Shown May Be Different From The Location As Shown On The Drawings. Contact Engineer Immediately If Surface or Subsurface Features Are Different Than Shown On The Drawings.

Plat of Survey and Topography Provided By Marchese and Sons, Inc. For Oak Park & River Forest High School District 200 on November 11, 2019 (Revised December 24, 2019). Order Number 19-16630.

1. **Site Bench Mark No. 8**  
**Bolt on Fire Hydrant Located Near Southeast Corner of Intersection of N. East Avenue with +43.37 (NGVD29)**  
**Elevation = +622.61 (NAVD88) / +43.37 (NGVD29)**
2. **Site Bench Mark No. 9**  
**Bolt on Fire Hydrant Located Near Southeast Corner of Intersection of N. Scoville Avenue with Erie Street.**  
**Elevation = +621.13 (NAVD88) / +41.90 (NGVD29)**
3. **Site Bench Mark No. 11**  
**Bolt on Fire Hydrant Located Near Southeast Corner of Intersection of N. Scoville Avenue with Ontario Street.**  
**Elevation = +620.74 (NAVD88) / +41.46 (NGVD29)**
4. **Site Bench Mark No. 13**  
**Bolt on Fire Hydrant Located To West of South Carleton Building to East of Concrete Driveway**  
**Elevation = +621.05 (NAVD88) / +41.82 (NGVD29)**

Note: The Exact Location of All Utilities Shall Be Verified By the Contractor Prior to Construction Activities. For Utility Locations Call: J.U.L.I.E. 1 (800) 892-0123

**CIVIL / LANDSCAPE**  
**Eriksson Engineering Associates, Ltd.**  
145 Commertown Dr, Suite A  
Graylake, IL 60030  
Phone: 847.273.8404

**M.E.P.**  
**AMSCO ENGINEERING**  
5115 BELMONT ROAD  
DOWNERS GROVE, ILLINOIS 60515  
630.515.1555

**CONSTRUCTION MANAGER**  
**BARRINGTON CONSTRUCTION COMPANY**  
411 LAKE ZURICH ROAD  
BARRINGTON, ILLINOIS 60010  
847.381.2760

**Oak Park and River Forest High School  
District 200**

**TRACK AND FIELD - SOUTH FIELD LIGHTING**

Oak Park and River Forest High School District 200  
201 N. Scoville Ave, Oak Park, IL 60302

---

**ISSUED FOR SPECIAL USE PERMIT**

## SITE GEOMETRY PLAN

**SHEET NO.**

## C1.1





QTY	LOCATION	SIZE	GRADE ELEVATION	MOUNTING HEIGHT	LUMINAIRE TYPE	QTY / POLE	THIS GRID	OTHER GRIDS
2	A1-A2	80'	-	80' 15.5'	TLC-LED-900 TLC-BT-575	1 1	1 0	0
2	B1-B2	90'	-	80' 15.5'	TLC-LED-1200 TLC-BT-575	3 2	3 0	0
2	C1-C2	80'	-	90' 15.5'	TLC-LED-1200 TLC-BT-575	1 2	1 0	0
2				90' 15.5'	TLC-LED-1500 TLC-BT-575	5 2	5 0	0
6				80'	TLC-LED-1500	6	6	0
						42	42	0

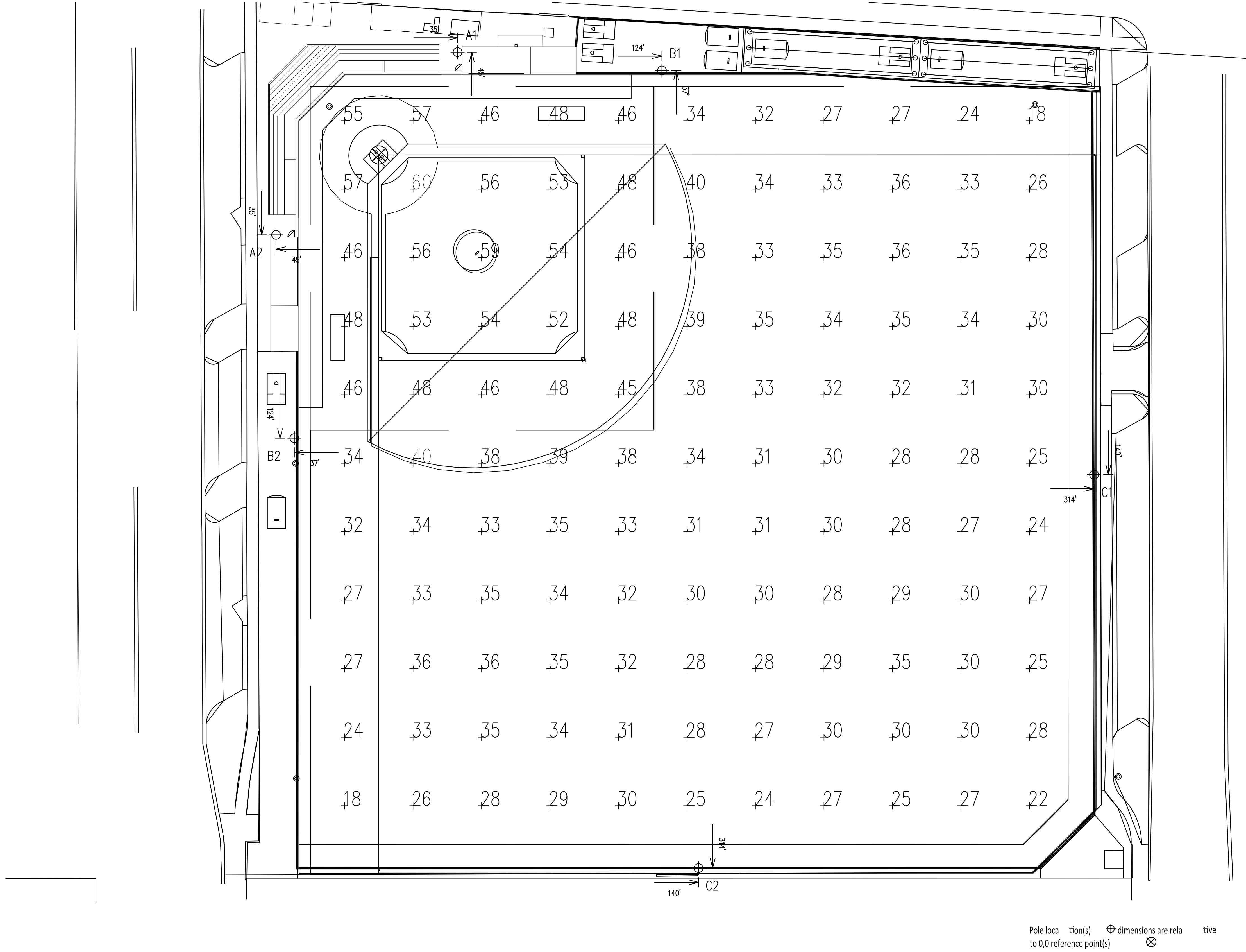

## 1 ILLUMINATION SUMMARY

<b>Name:</b>	<b>Baseball</b>	
<b>Size:</b>	<b>Irregular 316' / 425' / 315'</b>	
<b>Spacing:</b>	<b>30.0' x 30.0'</b>	
<b>Height:</b>	<b>3.0' above grade</b>	
	<b>In field</b>	<b>Out field</b>
<b>Guaranteed Average:</b>		
Scan Average:	50.92	30.78
Maximum:	60	40
Minimum:	45	18
Avg / Min:	1.14	1.76
<b>Guaranteed Max / Min:</b>		
Max / Min:	1.35	2.29
UG (adjacent pts):	1.24	1.49
CU:	0.75	
No. of Points:	25	96
Applied Circuits:	A	
No. of Luminaire:	42	
Total Load:	48.35 kW	

**Guaranteed Performance:** The ILLUMINATION described above is guaranteed per your Musco Warranty document and includes a 0.95 dirt depreciation factor.

**Field Measurements:** Individual field measurements may vary from computer-calculated predictions and should be taken in accordance with IESNA RP-6-15.

**Electrical System Requirements:** Refer to Amperage  
Draw Chart and/or the "Musco Control System Summary  
for electrical sizing.

**Installation Requirements:** Results assume  $\pm 3\%$  nominal voltage at line side of the driver and structures located within 3 feet (1m) of design locations

**CIVIL / LANDSCAPE**  
**Eriksson Engineering Associates, Ltd.**  
145 Commerce Dr. Suite A  
Grayslake, IL 60030  
Phone: 847.222.8804

---

**M.E.P.**  
**AMSCO ENGINEERING**  
5115 BELLEVUE ROAD  
DOWNERS GROVE, ILLINOIS 60515  
800.525.2905

---

**CONSTRUCTION MANAGER**  
**PEPPER CONSTRUCTION COMPANY**  
411 E. 48th STREET  
SARASOTA, FLORIDA 34233  
888.382.2700

[illegible]

**Oak Park and River Forest High School  
District 200**

**TRACK AND FIELD - SOUTH FIELD LIGHTING**

Oak Park and River Forest High School District 200  
201 N. Scoville Ave, Oak Park, IL 60302

**ISSUED FOR SPECIAL USE PERMIT**

# ILLUMINATION SUMMARY

SHEET NO.

## E0.02

JOB NO. 21-3098.05  
© 2022 FGM Architects Inc.



**AMSCO**  
ENGINEERING

5115 BELMONT ROAD  
DOWNERS GROVE, IL 60515

[www.amscoengineering.com](http://www.amscoengineering.com)

LICENSE:  
#184-001233(02-044077)

REPRODUCTION OF THIS DRAWING, BY ANY PHOTOGRAPHIC, XEROGRAPHIC OR OTHER SIMILAR TECHNIQUE, OR PROCESS, FOR INCORPORATING THE MATERIAL CONTAINED HEREIN INTO A SHOP DRAWING, IS STRICTLY PROHIBITED.

© 2022 AMSCO ENGINEERING INCORPORATED. ALL RIGHTS RESERVED.



<b>Name:</b>	<b>Property Spill</b>
<b>Spacing:</b>	<b>30.0'</b>
<b>Height:</b>	<b>3.0' above grade</b>
<b>En tire Grid</b>	
<b>Scan Average:</b>	<b>0.3685</b>
<b>Maximum:</b>	<b>0.90</b>
<b>Minimum:</b>	<b>0.00</b>
<b>No. of Points:</b>	<b>67</b>
<b>Applied Circuits:</b>	<b>A</b>
<b>No. of Luminaires:</b>	<b>42</b>
<b>Total Load:</b>	<b>48.35 kW</b>

**Guaranteed Performance:** The ILLUMINATION described above is guaranteed per your Musco Warranty document.

**Field Measurements:** Individual field measurements may vary from computer-calculated predictions and should be taken in accordance with IESNA RP-6-15.

**Electrical System Requirements:** Refer to Amperage Draw Chart and/or the "Musco Control System Summary" for electrical sizing.

**Installation Requirements:** Results assume  $\pm 3\%$  nominal voltage at line side of the driver and structures located within 3 feet (1m) of design locations.

630.574.8300 OFFICE  
630.574.7070 FAX

ILLINOIS PROFESSIONAL DESIGN  
FIRM #184-000350

CIVIL / LANDSCAPE

Commerce Dr., Suite A  
Myslake, IL 60093  
Phone: 8472234804

**M.E.P.**

**MSCO ENGINEERING**  
15 BELMONT ROAD  
WINNERS GROVE, ILLINOIS 60515  
312.255.2555

## CONSTRUCTION MANAGER

1 LAKE ZURICH ROAD  
BRISTOL, ILLINOIS 60013  
P. 383.2760

[illegible]

**Oak Park and River Forest High School**  
**District 200**  
**TRACK AND FIELD - SOUTH FIELD LIGHTING**  
Oak Park and River Forest High School District 200  
201 N. Scoville Ave, Oak Park, IL 60302

ISSUED FOR SPECIAL USE PERMIT

## PROPERTY SPILL

(HORIZONTAL FOOTCANDLES)

SHEET NO.

## E0.03

JOB NO. 21-3098.05  
© 2022 FGM Architects Inc.

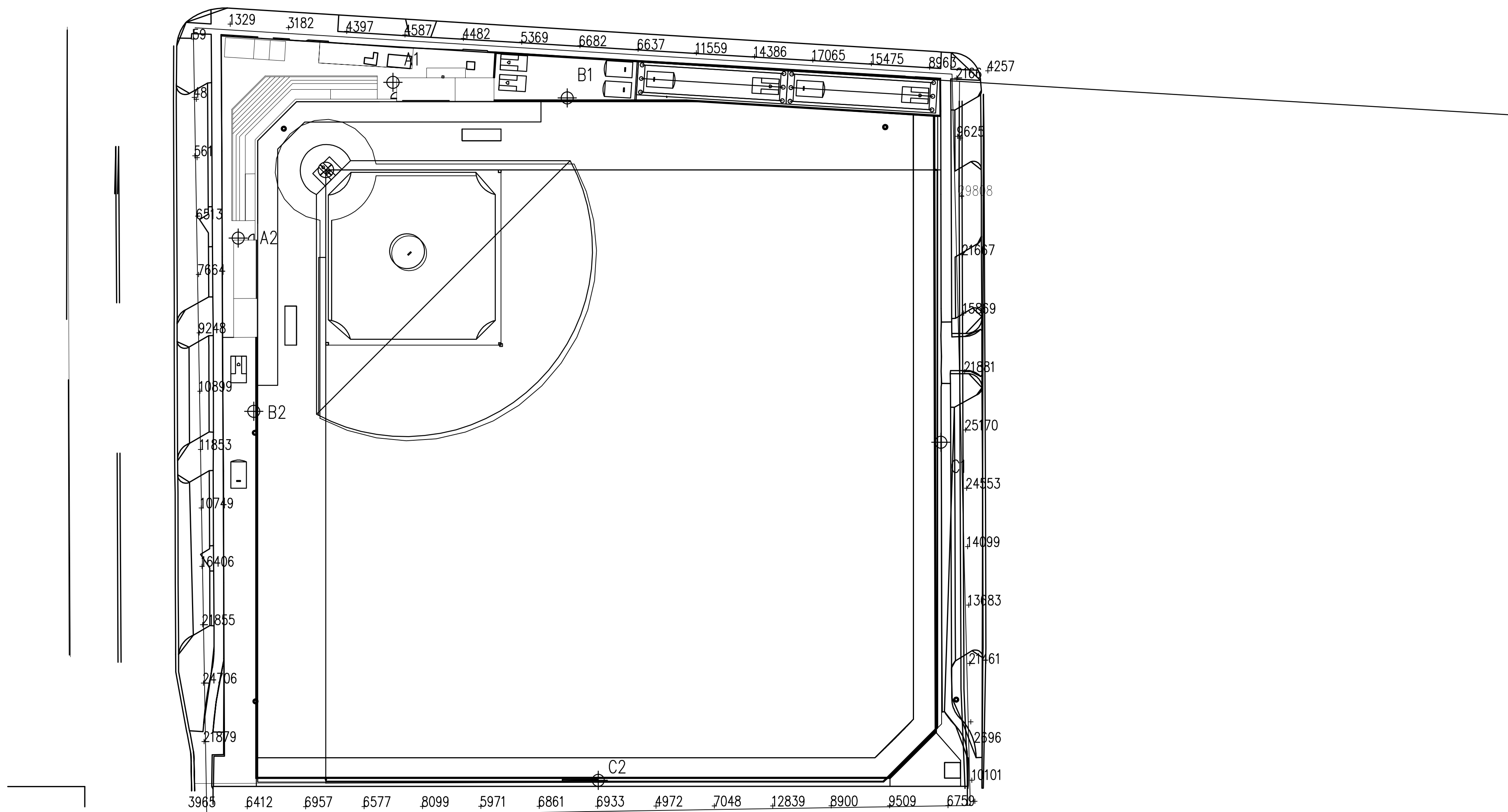

Pole location(s)  $\oplus$  dimensions are relative to 0,0 reference point(s)  $\otimes$

<b>Name:</b>	<b>Property Spill</b>
<b>Spacing:</b>	<b>30.0'</b>
<b>Height:</b>	<b>3.0' above grade</b>
<b>Scan Average:</b>	<b>En tire Grid</b>
<b>Maximum:</b>	<b>10685.8643</b>
<b>Minimum:</b>	<b>30051.01</b>
<b>No. of Points:</b>	<b>47.92</b>
	<b>67</b>
<b>Applied Circuits:</b>	<b>A</b>
<b>No. of Luminaires:</b>	<b>42</b>
<b>Total Load:</b>	<b>48.35 kW</b>

**Guaranteed Performance:** The ILLUMINATION described above is guaranteed per your Musco Warranty document.

**Field Measurements:** Individual field measurements may vary from computer-calculated predictions and should be taken in accordance with IESNA RP-6-15.

**Electrical System Requirements:** Refer to Amperage Draw Chart and/or the "Musco Control System Summary" for electrical sizing.

**Installation Requirements:** Results assume  $\pm 3\%$  nominal voltage at line side of the driver and structures located within 3 feet (1m) of design locations.

[illegible]

**Oak Park and River Forest High School  
District 200**

**TRACK AND FIELD - SOUTH FIELD LIGHTING**

Oak Park and River Forest High School District 200  
201 N. Scoville Ave, Oak Park, IL 60302

ISSUED FOR SPECIAL USE PERMIT

PROPERTY SPILL  
(CANDELA PER FIXTURE)

SHEET NO.

## EO.04

JOB NO. 21-3098.05  
© 2022 FGM Architects Inc.



**AMSCO**  
ENGINEERING

5115 BELMONT ROAD  
DOWNERS GROVE, IL 60515

[www.amscoengineering.com](http://www.amscoengineering.com)

LICENSE:  
#184-001233(02-044077)

REPRODUCTION OF THIS DRAWING, BY ANY PHOTOGRAPHIC, XEROGRAPHIC OR OTHER SIMILAR TECHNIQUE, OR PROCESS, FOR INCORPORATING THE MATERIAL CONTAINED HEREIN INTO A SHOP DRAWING, IS STRICTLY PROHIBITED.

© 2022 AMSCO ENGINEERING INCORPORATED. ALL RIGHTS RESERVED.





**INCLUDES:**

- Baseball

Electrical System Requirements:	Refer to Amperage
Draw Chart and/or the	"Musco Control System Summary"
for electrical sizing.	

**Installation Requirements:** Results assume  $\pm 3\%$  nominal voltage at line side of the driver and structures located within 3 feet (1m) of design locations.

QTY	LOCATION	SIZE	GRADE ELEVATION	MOUNTING HEIGHT	LUMINAIRE TYPE	QTY/ POLE
2	A1-A2	80'	-	80' 15.5'	TLC-LED-900 TLC-BT-575	1 1
2	B1-B2	90'	-	80' 15.5'	TLC-LED-1200 TLC-LED-1200	3 1
				90'	TLC-BT-575 TLC-LED-1500	2 5
2	C1-C2	80'	-	15.5' 80'	TLC-BT-575 TLC-LED-1500	2 6
6						42

Single Phase Voltage	208 (60)	220 (60)	240 (60)	277 (60)	347 (60)	380 (60)	480
TLC-LED-1200	7.0	6.6	6.1	5.2	4.2	4.0	3.0
TLC-LED-1500	8.5	8.1	7.4	6.4	5.1	4.7	3.7
TLC-BT-575	3.4	3.2	2.9	2.5	2.0	1.8	1.5
TLC-LED-900	5.3	5.0	4.6	4.0	3.2	2.9	2.3

[illegible]

**Oak Park and River Forest High School  
District 200**  
**TRACK AND FIELD - SOUTH FIELD LIGHTING**  
Oak Park and River Forest High School District 200  
201 N. Scoville Ave, Oak Park, IL 60302

EQUIPMENT LOCATION

SHEET NO.

## E0.05

JOB NO. 21-3098.05  
© 2022 FGM Architects Inc.

## TLC for LED® – Galvanized Steel Pole

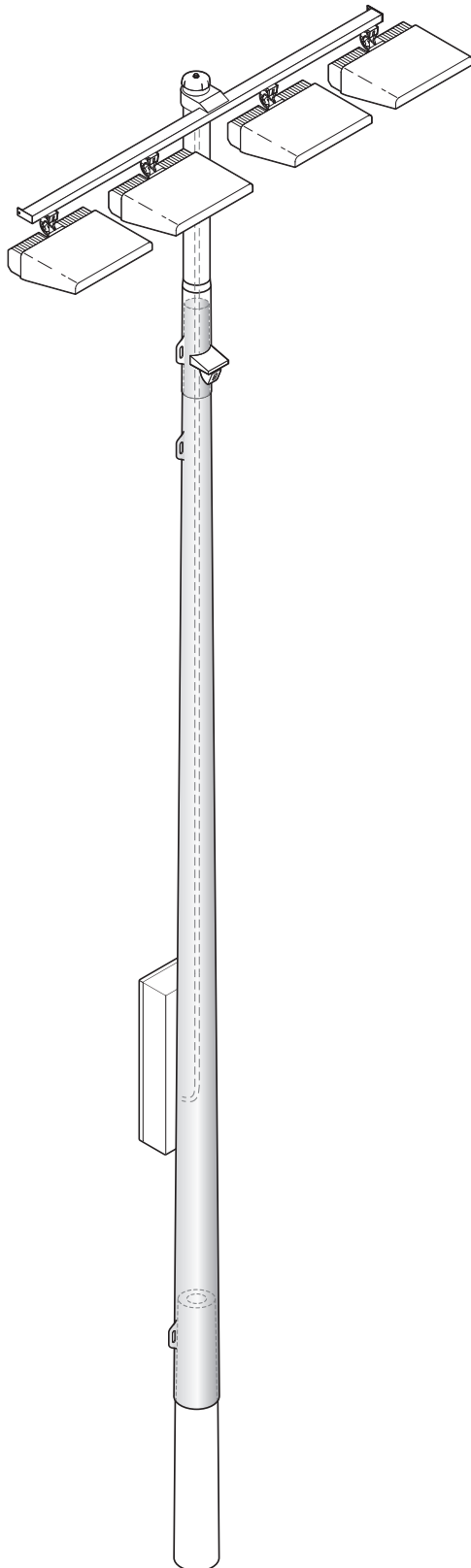

### Overview

The galvanized steel pole is designed to slip-fit together with the precast concrete base and the poletop luminaire assembly.

### Features

- Slip-fit connection allows pole assembly with come-alongs
- Built-in hardware for attaching electrical components enclosure
- Wire access from inside the pole (no exposed wiring or conduit)
- Shipped in sections for easier handling
- Labeled with pole identification for location on field

### Technical Specifications

Pole dimensions vary. For measurements refer to project specific pole configuration drawing.

### Construction

- Pole designs comply with all major building codes
- High strength, low alloy, tapered, round steel pole
- Hot-dip galvanizing inside and outside after fabrication meets ASTM-A123 and EN 1461 standards
- Conforms to AASHTO stress standards and BS EN 40-3-1
- Grounding lug—rated for aluminum (AL) or copper (CU) wiring
- Pole shipped in sections
- Stainless steel fasteners passivated and coated
- Material certifications are available

### Quality Assurance Tests

- Bending stress
- Minimum galvanizing thickness
- Straightness measurement

## TLC for LED® – Galvanized Steel Pole

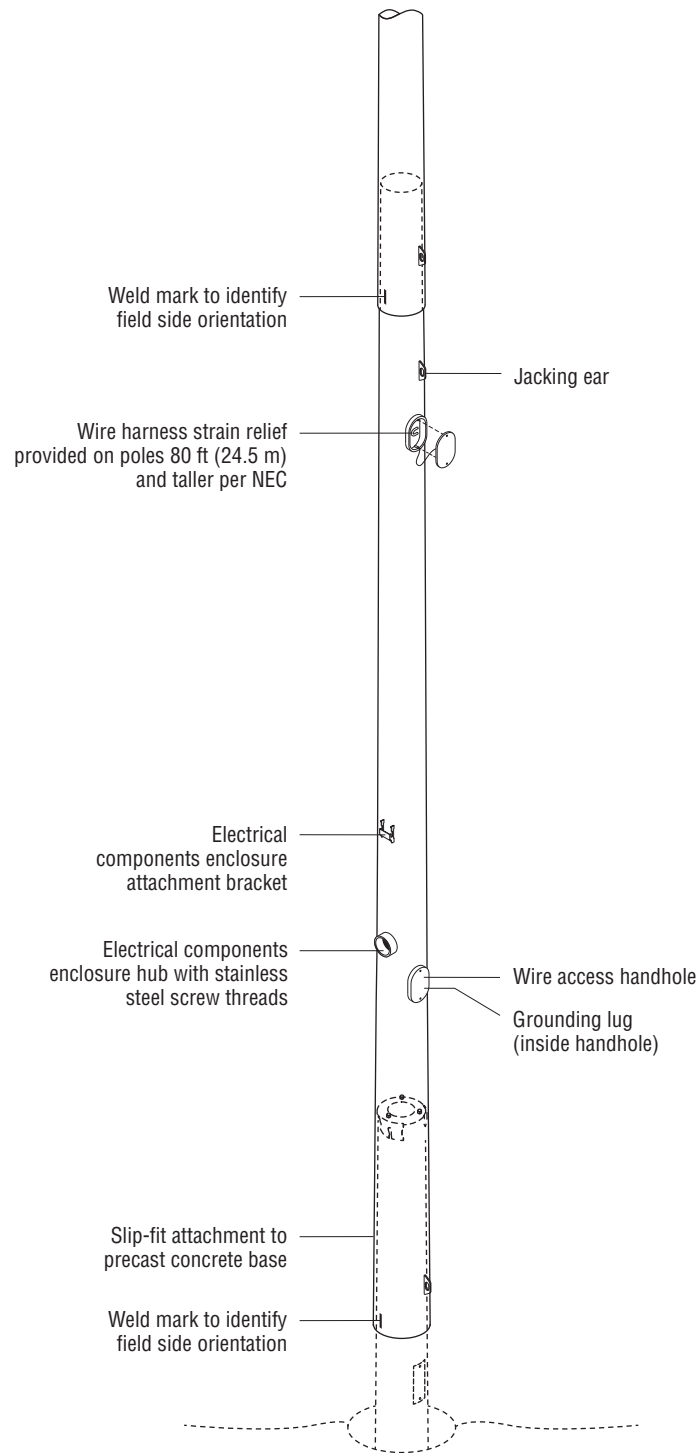

## TLC for LED® – Precast Concrete Base

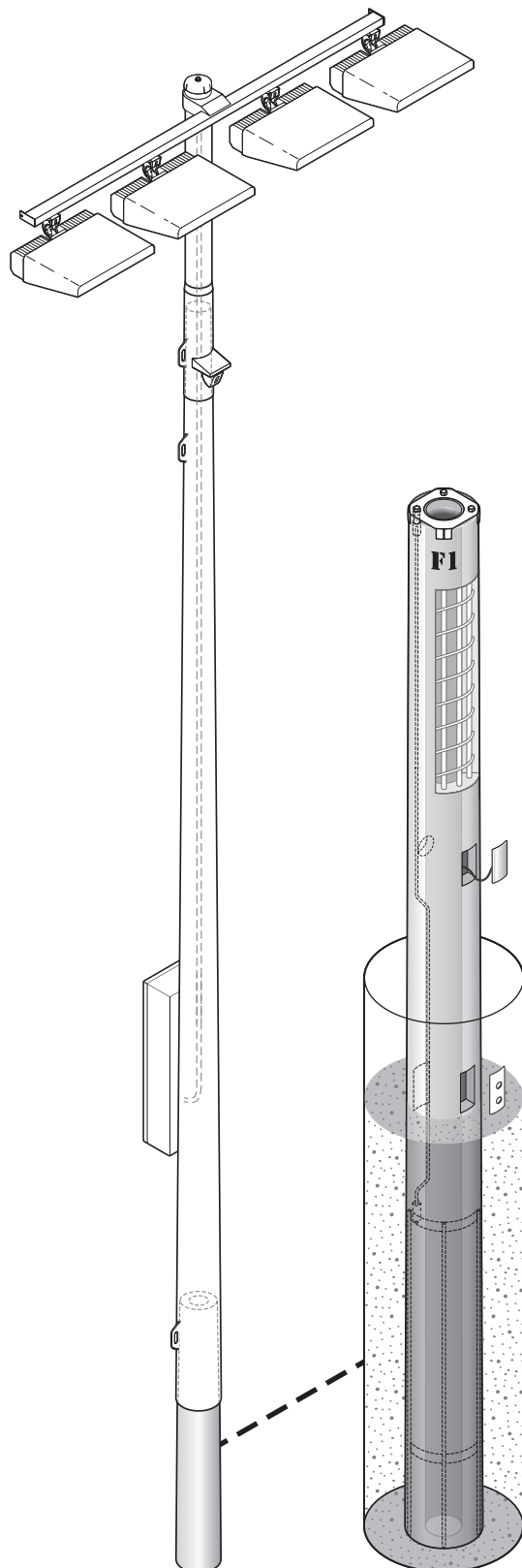

### Overview

The precast concrete base is set directly into the ground and backfilled with concrete. The base includes an integrated lightning ground system.

### Features

#### Base

- Set pole on base in 24 hours
- Tapered upper section for slip-fit steel pole
- Access holes for wire entry
- Epoxy-coated ends prevent water intrusion
- Lifting hole accepts load-rated steel rod provided by Musco

#### Integrated Lightning Ground System

- Complies with NFPA 780, UL 96A, and EN 62305 standards when installed per Musco installation instructions
- UL Listed, Class II Lightning Protection, file number E337467
- Tested up to 100 kA by independent laboratory
- Steel pole interfaces with integrated grounding system by means of the pole grounding connector
- 2/0 AWG (crosssectional area of 67.4 mm<sup>2</sup>) grounding electrode conductor
- Concrete-encased grounding electrode, 20 feet (6.1 m) total length, ½ inch (12.7 mm) diameter

### Technical Specifications

Base dimensions vary. For measurements refer to project-specific *Foundation and Pole Assembly* drawing.

#### Construction

- Spun concrete construction
- Prestressed steel vertical strands and coil spiral for strength throughout base
- Minimum design strength is 9500 lb/in<sup>2</sup> (65.5 MPa) at 28 days
- Meets ASTM C1804 design requirements

#### Quality Assurance Tests

- 28-day compressive strength
- Bending moment capacity
- Grounding system continuity

## TLC for LED® – Precast Concrete Base

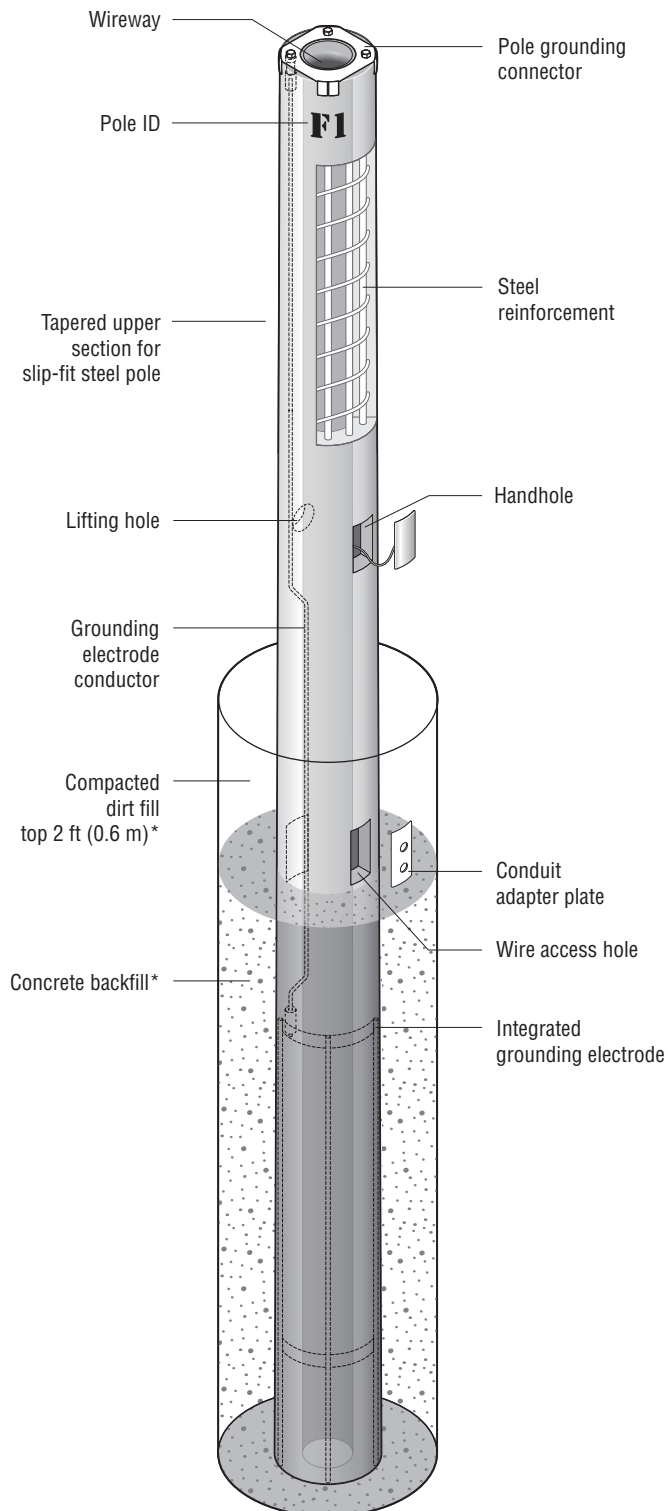

\*Standard pier foundation shown. Foundation and/or backfill may vary per alternate foundation design.

## Luminaire and Driver Components – TLC-BT-575

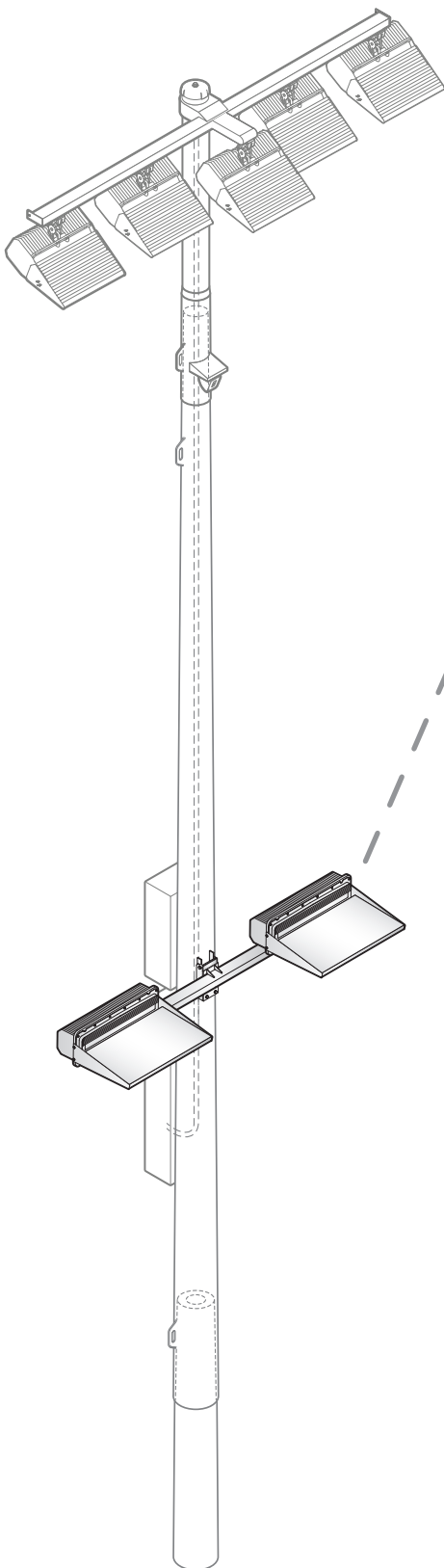

### Luminaire Data

Weight (luminaire)	34 lb (15 kg)
UL listing number	E338094
UL Listed for USA / Canada	UL1598 CSA-C22.2 No.250.0
Ingress protection, luminaire	IP65
Impact rating	IK07
Material and finish	Aluminum, powder-coat painted
Wind speed rating (aiming only)	150 mi/h (67 m/s)
UL, IEC ambient temperature rating, luminaire	50°C (122°F)

### Photometric Characteristics

Projected lumen maintenance per IES TM-21-11	
L90 (20k)	>120,000 h
L80 (20k)	>120,000 h
L70 (20k)	>120,000 h
Lumens <sup>1</sup>	52,000
CIE correlated color temperature	5700 K
Color rendering index (CRI)	75 typ, 70 min
LED binning tolerance	7-step MacAdam Ellipse

#### Footnotes:

1) Incorporates appropriate dirt depreciation factor for life of luminaire.

All components from foundation to poletop are designed to work together in Light-Structure System™ to ensure reliable, trouble-free operation.

## Luminaire and Driver Components – TLC-BT-575

### Driver Data

#### Electrical Data

Rated wattage<sup>1</sup>

Per driver 575 W

Per luminaire 575 W

Number of luminaires per driver 1

Starting (inrush) current <40 A, 256 µs

Fuse rating 15 A

UL, IEC ambient temperature rating, electrical components enclosure 50°C (122°F)

Ingress protection, electrical components enclosure IP54

Efficiency 95%

### Typical Wiring

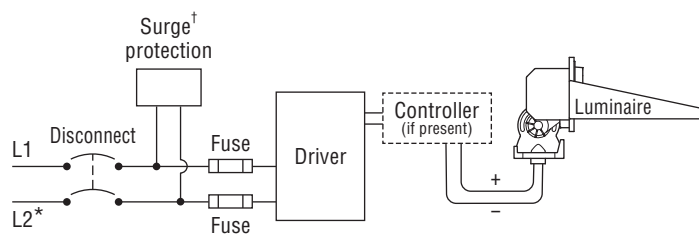

\* If L2 (com) is neutral then not switched or fused.

† Not present if indoor installation.

	200 Vac 50/60 Hz	208 Vac 60 Hz	220 Vac 50/60 Hz	230 Vac 50 Hz	240 Vac 50/60 Hz	277 Vac 60 Hz	347 Vac 60 Hz	380 Vac 50/60 Hz	400 Vac 50 Hz	415 Vac 50 Hz	480 Vac 60 Hz
<b>Max operating current<sup>2</sup> per luminaire</b>	3.48 A	3.35 A	3.16 A	3.03 A	2.90 A	2.51 A	2.01 A	1.83 A	1.74 A	1.68 A	1.45 A

#### Footnotes:

- 1) Rated wattage is the power consumption, including driver efficiency losses, at stabilized operation in 25°C ambient temperature environment.
- 2) Operating current includes allowance for 0.90 minimum power factor, operating temperature, and LED light source manufacturing tolerances.

#### Notes

1. Use thermal magnetic HID-rated or D-curve circuit breakers.
2. See *Musco Control System Summary* for circuit information.

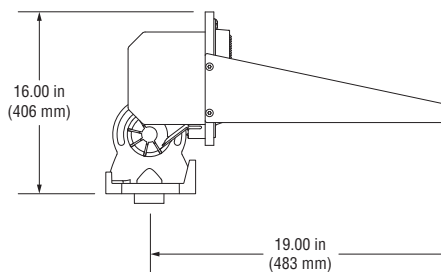
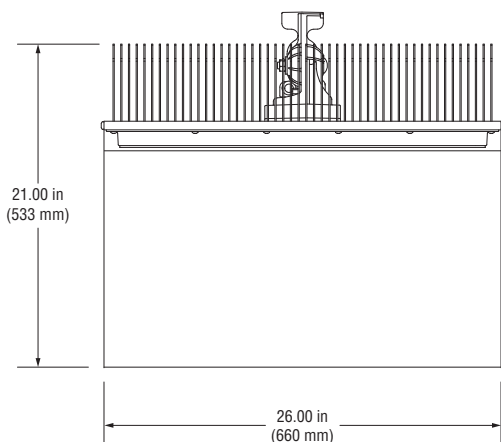

## Luminaire Data

Weight (luminaire)	40 lb (18 kg)
UL listing number	E338094
UL listed for USA / Canada	UL1598 CSA-C22.2 No.250.0
CE Declaration	LVD, EMC, RoHS
Ingress protection, luminaire	IP65
Impact rating	IK07
Material and finish	Aluminum, powder-coat painted
Wind speed rating (aiming only)	150 mi/h (67 m/s)
UL, IEC ambient temperature rating, luminaire	50°C (122°F)

## Photometric Characteristics

Projected lumen maintenance per IES TM-21-11

L90 (20k)	>120,000 h
L80 (20k)	>120,000 h
L70 (20k)	>120,000 h
Lumens <sup>1</sup>	89,600
CIE correlated color temperature	5700 K
Color rendering index (CRI)	75 typ, 70 min
LED binning tolerance	7-step MacAdam Ellipse

Footnotes:

1) Incorporates appropriate dirt depreciation factor for life of luminaire.

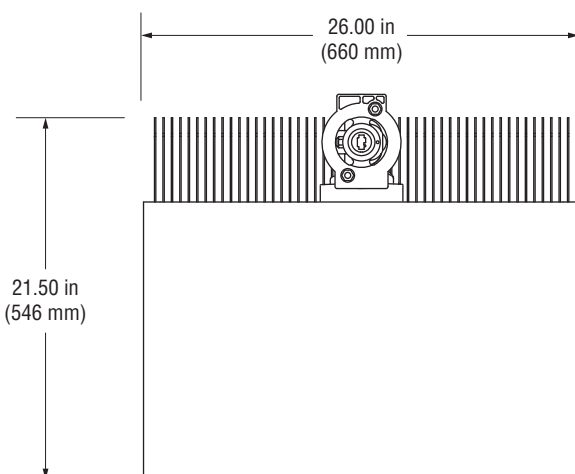
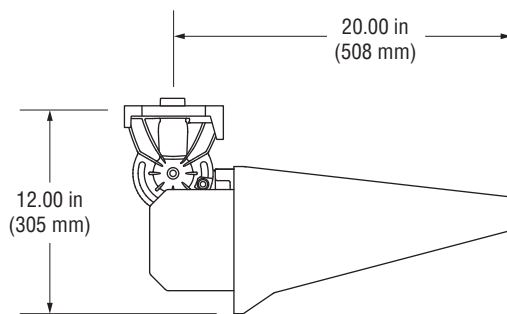
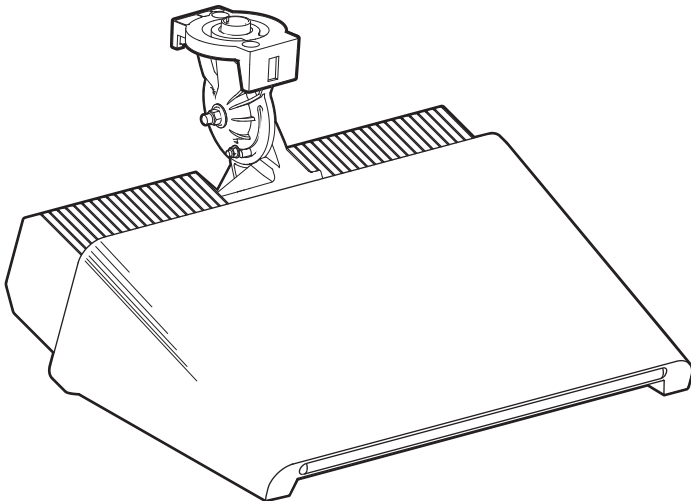



# Datasheet: **TLC-LED-900 Luminaire and Driver**

## Driver Data

### Electrical Data

Rated wattage <sup>1</sup>	
Per driver	890 W
Per luminaire	890 W
Number of luminaires per driver	1
Starting (inrush) current	<40 A, 256 $\mu$ s
Fuse rating	15 A
UL, IEC ambient temperature rating, electrical components enclosure	50°C (122°F)
Ingress protection, electrical components enclosure	IP54
Efficiency	95%
Dimming mode	optional
Range, energy consumption	25 – 100%
Range, light output	30 – 100%
Flicker	<2%
Total harmonic distortion (THD) at full output	<20%

### Typical Wiring

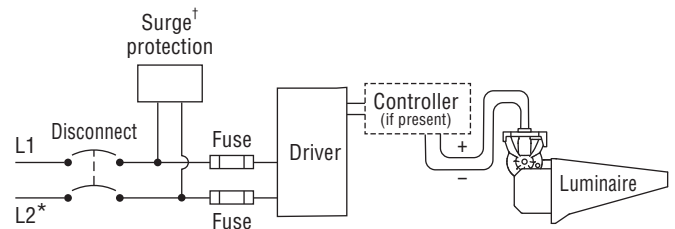

\* If L2 (com) is neutral then not switched or fused.

† Not present if indoor installation.

	200 Vac 50/60 Hz	208 Vac 60 Hz	220 Vac 50/60 Hz	230 Vac 50 Hz	240 Vac 50/60 Hz	277 Vac 60 Hz	347 Vac 60 Hz	380 Vac 50/60 Hz	400 Vac 50 Hz	415 Vac 50 Hz	480 Vac 60 Hz
<b>Max operating current per luminaire<sup>2</sup></b>	5.50 A	5.29 A	5.00 A	4.78 A	4.58 A	3.97 A	3.17 A	2.90 A	2.75 A	2.65 A	2.29 A

#### Footnotes:

- 1) Rated wattage is the power consumption, including driver efficiency losses, at stabilized operation in 25°C ambient temperature environment.
- 2) Operating current includes allowance for 0.90 minimum power factor, operating temperature, and LED light source manufacturing tolerances.

#### Notes

1. Use thermal magnetic HID-rated or D-curve circuit breakers.
2. See *Musco Control System Summary* for circuit information.



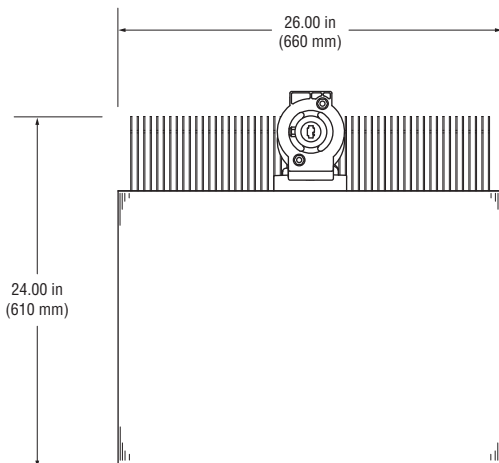
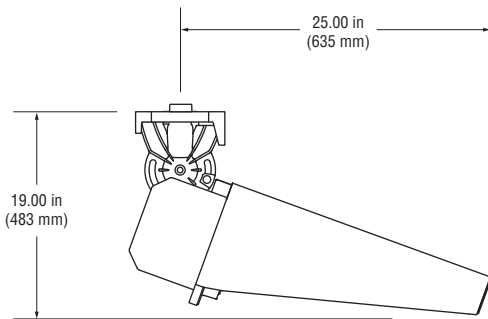
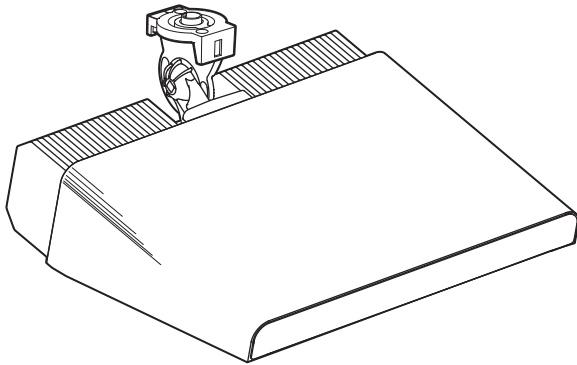

## Luminaire Data

Weight (luminaire)	45 lb (20 kg)
UL listing number	E338094
UL listed for USA / Canada	UL1598 CSA-C22.2 No.250.0
CE Declaration	LVD, EMC, RoHS
Ingress protection, luminaire	IP65
Impact rating	IK07
Material and finish	Aluminum, powder-coat painted
Wind speed rating (aiming only)	150 mi/h (67 m/s)
UL, IEC ambient temperature rating, luminaire	50°C (122°F)

## Photometric Characteristics

Projected lumen maintenance per IES TM-21-11

L90 (20k)	>120,000 h
L80 (20k)	>120,000 h
L70 (20k)	>120,000 h
Lumens <sup>1</sup>	136,000
CIE correlated color temperature	5700 K
Color rendering index (CRI)	75 typ, 70 min
LED binning tolerance	7-step MacAdam Ellipse

Footnotes:

1) Incorporates appropriate dirt depreciation factor for life of luminaire.

## Driver Data

## Typical Wiring

### Electrical Data

Rated wattage <sup>1</sup>	
Per driver	1170 W
Per luminaire	1170 W
Number of luminaires per driver	1
Starting (inrush) current	<40 A, 256 µs
Fuse rating	15 A
UL, IEC ambient temperature rating, electrical components enclosure	50°C (122°F)
Ingress protection, electrical components enclosure	IP54
Efficiency	95%
Dimming mode	optional
Range, energy consumption	14 – 100%
Range, light output	19 – 100%
Flicker	<2%
Total harmonic distortion (THD) at full output	<20%

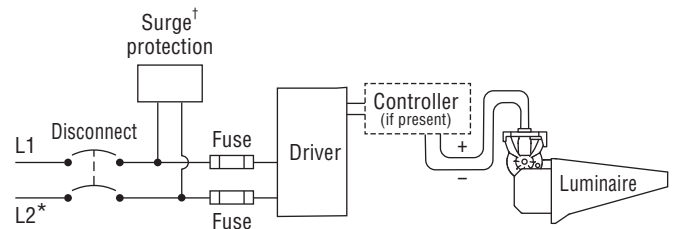

\* If L2 (com) is neutral then not switched or fused.

† Not present if indoor installation.

	200 Vac 50/60 Hz	208 Vac 60 Hz	220 Vac 50/60 Hz	230 Vac 50 Hz	240 Vac 50/60 Hz	277 Vac 60 Hz	347 Vac 60 Hz	380 Vac 50/60 Hz	400 Vac 50 Hz	415 Vac 50 Hz	480 Vac 60 Hz
<b>Max operating current per luminaire<sup>2</sup></b>	7.26 A	6.98 A	6.60 A	6.31 A	6.05 A	5.24 A	4.18 A	3.82 A	3.63 A	3.50 A	3.03 A

### Footnotes:

- 1) Rated wattage is the power consumption, including driver efficiency losses, at stabilized operation in 25°C ambient temperature environment.
- 2) Operating current includes allowance for 0.90 minimum power factor, operating temperature, and LED light source manufacturing tolerances.

### Notes

1. Use thermal magnetic HID-rated or D-curve circuit breakers.
2. See *Musco Control System Summary* for circuit information.



## Luminaire Data

Weight (luminaire)	67 lb (30 kg)
UL listing number	E338094
UL listed for USA / Canada	UL1598 CSA-C22.2 No.250.0
CE Declaration	LVD, EMC, RoHS
Ingress protection, luminaire	IP65
Impact rating	IK07
Material and finish	Aluminum, powder-coat painted
Wind speed rating (aiming only)	150 mi/h (67 m/s)
UL, IEC ambient temperature rating, luminaire	50°C (122°F)

## Photometric Characteristics

Projected lumen maintenance per IES TM-21-11

L90 (20k)	>120,000 h
L80 (20k)	>120,000 h
L70 (20k)	>120,000 h
Lumens <sup>1</sup>	160,000
CIE correlated color temperature	5700 K
Color rendering index (CRI)	75 typ, 70 min
LED binning tolerance	7-step MacAdam Ellipse

Footnotes:

1) Incorporates appropriate dirt depreciation factor for life of luminaire.

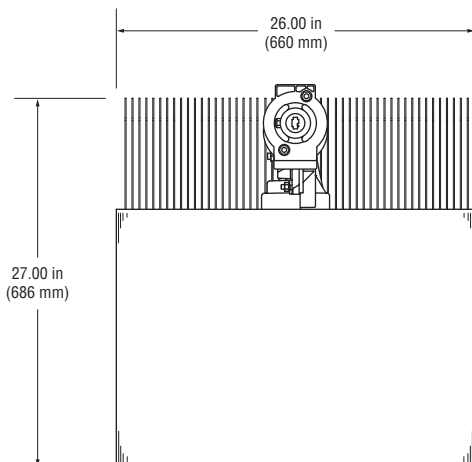
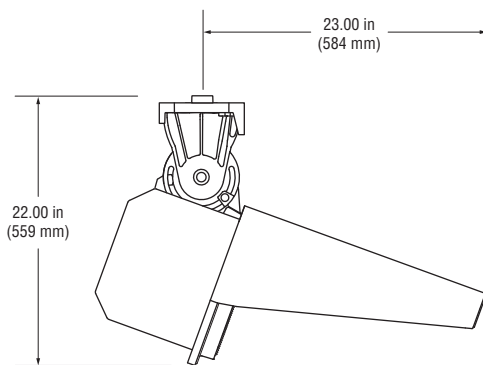
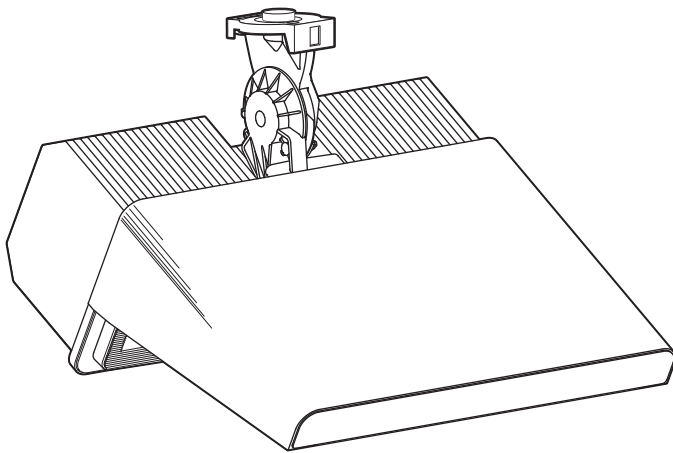

# Datasheet: TLC-LED-1500 Luminaire and Driver

## Driver Data

### Electrical Data

Rated wattage <sup>1</sup>	
Per driver	1430 W
Per luminaire	1430 W
Number of luminaires per driver	1
Starting (inrush) current	<40 A, 256 µs
Fuse rating	15 A
UL, IEC ambient temperature rating, electrical components enclosure	50°C (122°F)
Ingress protection, electrical components enclosure	IP54
Efficiency	95%
Dimming mode	optional
Range, energy consumption	12 – 100%
Range, light output	17 – 100%
Flicker	<2%
Total harmonic distortion (THD) at full output	<20%

### Typical Wiring

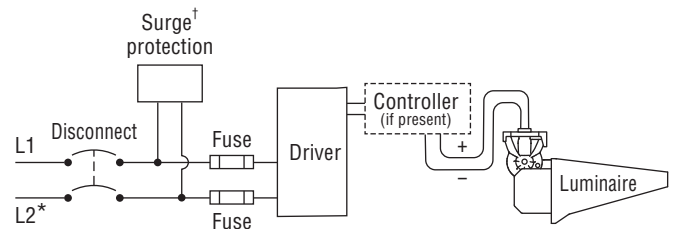

\* If L2 (com) is neutral then not switched or fused.

† Not present if indoor installation.

	200 Vac 50/60 Hz	208 Vac 60 Hz	220 Vac 50/60 Hz	230 Vac 50 Hz	240 Vac 50/60 Hz	277 Vac 60 Hz	347 Vac 60 Hz	380 Vac 50/60 Hz	400 Vac 50 Hz	415 Vac 50 Hz	480 Vac 60 Hz
Max operating current per luminaire <sup>2</sup>	8.86 A	8.52 A	8.06 A	7.71 A	7.39 A	6.40 A	5.11 A	4.67 A	4.43 A	4.27 A	3.70 A

#### Footnotes:

- 1) Rated wattage is the power consumption, including driver efficiency losses, at stabilized operation in 25°C ambient temperature environment.
- 2) Operating current includes allowance for 0.90 minimum power factor, operating temperature, and LED light source manufacturing tolerances.

#### Notes

1. Use thermal magnetic HID-rated or D-curve circuit breakers.
2. See *Musco Control System Summary* for circuit information.



# Affidavit of Notice

The undersigned Applicant, on oath states that the undersigned provided the Village of Oak Park, in writing, the list of owners of all property within 300 feet, excluding rights-of-way, in each direction of the property to which the petition relates; that documentation is from a reputable title company (or other approved agency) indicating the identity of all such owners required to receive notice has been submitted; that such list was prepared in sufficient time for the Applicant to provide notice no less than fifteen (15) days prior and no more than thirty (30) days in advance of such hearing; and that the owners so notified, are those shown on the last available tax records of the county. *(Please attach a list of the notified property owners)*

Ronald C. Anderson  
(Printed Name of Applicant)

  
(Signature of Applicant)

SUBSCRIBED AND SWORN TO BEFORE ME THIS

05 DAY OF July, 2022

  
(Notary Public)



Property Owner	Owner's Address	Owner's City, State and Zipcode	Property Address	Property City, State and Zipcode
W. CLARKE DOUGLAS	130 PERCY JULIAN SQUARE	OAK PARK, ILLINOIS 60302		
DANIEL & MEGHAN FERNANDEZ	132 PERCY JULIAN SQUARE	OAK PARK, ILLINOIS 60302		
HENRY M. PARRISH	134 PERCY JULIAN SQUARE	OAK PARK, ILLINOIS 60302		
ROSALYN ADELE FORD	53 W JACKSON BLVD - #430	OAK PARK, ILLINOIS 60302	136 PERCY JULIAN SQUARE	OAK PARK, ILLINOIS 60302
ROBERT MOY	138 PERCY JULIAN SQUARE	OAK PARK, ILLINOIS 60302		
ANTON COLBERT	140 PERCY JULIAN SQUARE	OAK PARK, ILLINOIS 60302		
S. CLEMENS & J. TENUTA	605 LAKE STREET	OAK PARK, ILLINOIS 60302		
ACADEMY OF MOVEMENT & MUSIC	605 LAKE STREET	OAK PARK, ILLINOIS 60302		
ANDREIA GOMES	100 BISHOP QUARTER LANE	OAK PARK, ILLINOIS 60302		
JASON ROBERT & ROSA COOPER	100 BISHOP QUARTER LANE	OAK PARK, ILLINOIS 60302		
MARTHA A. YOUNT	102 BISHOP QUARTER LANE	OAK PARK, ILLINOIS 60302		
CHERYL M. DAVID & BENJAMIN ROMANOS	104 BISHOP QUARTER LANE	OAK PARK, ILLINOIS 60302		
NANCY L. FLEHLER	106 BISHOP QUARTER LANE	OAK PARK, ILLINOIS 60302		
LISA MARIE VON ROENN	108 BISHOP QUARTER LANE	OAK PARK, ILLINOIS 60302		
WILLIAM H. BORK	108 BISHOP QUARTER LANE	OAK PARK, ILLINOIS 60302		
DAVID & SUSAN SCHUAB	110 BISHOP QUARTER LANE	OAK PARK, ILLINOIS 60302		
WENDY M. COLE	112 BISHOP QUARTER LANE	OAK PARK, ILLINOIS 60302		
DIEGO PEREZ MESA	112 BISHOP QUARTER LANE	OAK PARK, ILLINOIS 60302		
XIAOQUN MO & YIJUN SANG	114 BISHOP QUARTER LANE	OAK PARK, ILLINOIS 60302		
JUSTIN GRAY	100 FRANK LLOYD WRIGHT LANE	OAK PARK, ILLINOIS 60302	100 FRANK LLOYD WRIGHT LANE	OAK PARK, ILLINOIS 60302
JEFFREY E. GINGER	103 FRANK LLOYD WRIGHT LANE	OAK PARK, ILLINOIS 60302		
LYLE DEGARMO	102 FRANK LLOYD WRIGHT LANE	OAK PARK, ILLINOIS 60302		
CHRISTOPHER L. TEDIN & TINA M MINGO	103 FRANK LLOYD WRIGHT LANE	OAK PARK, ILLINOIS 60302		
TREVOR & LYNETTE CARDINAL	104 FRANK LLOYD WRIGHT LANE	OAK PARK, ILLINOIS 60302		
JAY KELLY	105 FRANK LLOYD WRIGHT LANE	OAK PARK, ILLINOIS 60302		

ELIZABETH K. NANCE	105 FRANK LLOYD WRIGHT LANE	OAK PARK, ILLINOIS 60302		
AARON ISHERWOOD	106 FRANK LLOYD WRIGHT LANE	OAK PARK, ILLINOIS 60302		
MARY L. ALTENBAUMER	107 FRANK LLOYD WRIGHT LANE	OAK PARK, ILLINOIS 60302		
MARSHA BORDERS & TRENACE FORD	108 FRANK LLOYD WRIGHT LANE	OAK PARK, ILLINOIS 60302		
YOUNG MEE KIM & SEOCK WON YOUN	109 FRANK LLOYD WRIGHT LANE	OAK PARK, ILLINOIS 60302		
CHERISE ROSEN	110 FRANK LLOYD WRIGHT LANE	OAK PARK, ILLINOIS 60302		
DARREN & JENNIFER ELLIS JACKSON	111 FRANK LLOYD WRIGHT LANE	OAK PARK, ILLINOIS 60302		
SHARON MOYER	112 FRANK LLOYD WRIGHT LANE	OAK PARK, ILLINOIS 60302		
SUE C. WIGGINS & SEAN V. PLUMMER	113 FRANK LLOYD WRIGHT LANE	OAK PARK, ILLINOIS 60302		
JENNIFER OBSZANSKI & CHARLES FOX	114 FRANK LLOYD WRIGHT LANE	OAK PARK, ILLINOIS 60302		
EISUKE SEGAWA & AIWEN ZHOU	115 FRANK LLOYD WRIGHT LANE	OAK PARK, ILLINOIS 60302		
STEVEN MYERS & JIA PIN WEN	116 FRANK LLOYD WRIGHT LANE	OAK PARK, ILLINOIS 60302		
ROBERT L. & ARLEATHA KELLY	121 FRANK LLOYD WRIGHT LANE	OAK PARK, ILLINOIS 60302		
DR ROBERT F. BAIMA & CATHERINE C. BAUMANN	128 N SCOVILLE AVE	OAK PARK, ILLINOIS 60302	122 FRANK LLOYD WRIGHT LANE	OAK PARK, ILLINOIS 60302
MICHAEL & JANORISE ROBINSON	123 FRANK LLOYD WRIGHT LANE	OAK PARK, ILLINOIS 60302		
MONICA L PHILLIPS	124 FRANK LLOYD WRIGHT LANE	OAK PARK, ILLINOIS 60302		
YVONNE HARRIS	125 FRANK LLOYD WRIGHT LANE	OAK PARK, ILLINOIS 60302		
AMY ROMBERG	126 FRANK LLOYD WRIGHT LANE	OAK PARK, ILLINOIS 60302		
THOMAS & MARGARET RYAN	126 FRANK LLOYD WRIGHT LANE	OAK PARK, ILLINOIS 60302		
LESLIE Z. MOOREHEAD VITTONI	127 FRANK LLOYD WRIGHT LANE	OAK PARK, ILLINOIS 60302		
CONSTANCE R. STEWART	128 FRANK LLOYD WRIGHT LANE	OAK PARK, ILLINOIS 60302		
ELIZABETH BRICKSON & GORAN IVANOVIC	129 FRANK LLOYD WRIGHT LANE	OAK PARK, ILLINOIS 60302		
TORY REDMOND	130 FRANK LLOYD WRIGHT LANE	OAK PARK, ILLINOIS 60302		
EILEEN CURRAN	130 FRANK LLOYD WRIGHT LANE	OAK PARK, ILLINOIS 60302		
AL & DOROTHY HILL	131 FRANK LLOYD WRIGHT LANE	OAK PARK, ILLINOIS 60302		
MARK J BLOOMBERG	132 FRANK LLOYD WRIGHT LANE	OAK PARK, ILLINOIS 60302		



ROGETTE S. PATTERSON	133 FRANK LLOYD WRIGHT LANE	OAK PARK, ILLINOIS 60302		
AMY J. MERRICK	134 FRANK LLOYD WRIGHT LANE	OAK PARK, ILLINOIS 60302		
SHARI L FILONI	135 FRANK LLOYD WRIGHT LANE	OAK PARK, ILLINOIS 60302		
STEPHEN & ELLEN ALLSTEADT	136 FRANK LLOYD WRIGHT LANE	OAK PARK, ILLINOIS 60302		
SHERMAN YEE & ELAINE CHIN	137 FRANK LLOYD WRIGHT LANE	OAK PARK, ILLINOIS 60302		
JOSH M. CRAMER	138 FRANK LLOYD WRIGHT LANE	OAK PARK, ILLINOIS 60302		
SILVIA CASTANEDA	139 FRANK LLOYD WRIGHT LANE	OAK PARK, ILLINOIS 60302		
JACK BERLINSKI	140 FRANK LLOYD WRIGHT LANE	OAK PARK, ILLINOIS 60302		
SOPHY PACHONPHAI	141 FRANK LLOYD WRIGHT LANE	OAK PARK, ILLINOIS 60302		
WICKLOW DEVELOPMENT GROUP	453 SOUTH BOULEVARD	OAK PARK, ILLINOIS 60302		
EROL FERATOVIC	P.O. BOX 1303	OAK PARK, ILLINOIS 60304	459 SOUTH BOULEVARD	OAK PARK, ILLINOIS 60302
515 S. BOULEVARD LLC	741 GUNDERSON	OAK PARK, ILLINOIS 60304	515 SOUTH BOULEVARD	OAK PARK, ILLINOIS 60302
PARK EAST CONDO FLINN	112 S. EAST AVENUE	OAK PARK, ILLINOIS 60302	517 SOUTH BOULEVARD	OAK PARK, ILLINOIS 60302
CHAD & NICOLE WHELEN	519 SOUTH BOULEVARD	OAK PARK, ILLINOIS 60302		
MARY LEDOUX & ROERT J. MORISSEY JR.	521 SOUTH BOULEVARD	OAK PARK, ILLINOIS 60302		
HOWARD A. RAIK	523 SOUTH BOULEVARD	OAK PARK, ILLINOIS 60302		
SUSAN ZOLOTO	525 SOUTH BOULEVARD	OAK PARK, ILLINOIS 60302		
ALBERT DAVID & LIBBY AVANZADO	527 SOUTH BOULEVARD	OAK PARK, ILLINOIS 60302		
JOSEPH& MICHELLE MAXWELL	529 SOUTH BOULEVARD	OAK PARK, ILLINOIS 60302		
JJAIDIEP SABINA MINOCHA	601 SOUTH BOULEVARD - UNIT A	OAK PARK, ILLINOIS 60302		
NICOLAS E. BENSON	601 SOUTH BOULEVARD - UNIT B	OAK PARK, ILLINOIS 60302		
WINSTON REGINALD	601 SOUTH BOULEVARD - UNIT C	OAK PARK, ILLINOIS 60302		
DARLA DEWOLFE & STEVE VEJICK	610 SOUTH BOULEVARD - UNIT D	OAK PARK, ILLINOIS 60302		
GRES PAT FIGUEROA	601 SOUTH BOULEVARD - UNIT E	OAK PARK, ILLINOIS 60302		
MELISSA H. CLARK	601 SOUTH BOULEVARD - UNIT F	OAK PARK, ILLINOIS 60302		
BER YUI HUANG	601 SOUTH BOULEVARD - UNIT F	OAK PARK, ILLINOIS 60302		

MARY D. TELIOS	605 SOUTH BOULEVARD - UNIT A	OAK PARK, ILLINOIS 60302		
RENEE BELL	605 SOUTH BOULEVARD - UNIT A	OAK PARK, ILLINOIS 60302		
TERESA M. CARLTON	605 SOUTH BOULEVARD - UNIT B	OAK PARK, ILLINOIS 60302		
CHARLES T. BARLOW	605 SOUTH BOULEVARD - UNIT C	OAK PARK, ILLINOIS 60302		
REBECCA GROBER	605 SOUTH BOULEVARD - UNIT C	OAK PARK, ILLINOIS 60302		
DANIEL FRANK	605 SOUTH BOULEVARD - UNIT D	OAK PARK, ILLINOIS 60302		
CRAIG CARDOSI	605 SOUTH BOULEVARD - UNIT E	OAK PARK, ILLINOIS 60302		
THOMAS QUALL JR. & KATHLEEN QUAIL	605 SOUTH BOULEVARD - UNIT E	OAK PARK, ILLINOIS 60302		
PEDRO & MARIA LOURDES REYES	605 SOUTH BOULEVARD - UNIT F	OAK PARK, ILLINOIS 60302		
XIAOYIN TANG	609 SOUTH BOULEVARD - UNIT A	OAK PARK, ILLINOIS 60302		
SWATI BHATTACHARYYA	609 SOUTH BOULEVARD - UNIT B	OAK PARK, ILLINOIS 60302		
ROGER & MARY BONINE	609 SOUTH BOULEVARD - UNIT C	OAK PARK, ILLINOIS 60302		
MATTHEW & ANNE GOOD	609 SOUTH BOULEVARD - UNIT C	OAK PARK, ILLINOIS 60302		
DELTON LONG & ROSSANA BLANCO PRADO	609 SOUTH BOULEVARD - UNIT D	OAK PARK, ILLINOIS 60302		
DAVID HARBAUGH	609 SOUTH BOULEVARD - UNIT E	OAK PARK, ILLINOIS 60302		
MATTHEW & JENNIE RYPL	609 SOUTH BOULEVARD - UNIT F	OAK PARK, ILLINOIS 60302		
PATRICIA HARRISON	609 SOUTH BOULEVARD - UNIT F	OAK PARK, ILLINOIS 60302		
ERIC SERRANO	104 S. SCOVILLE AVENUE - UNIT GN	OAK PARK, ILLINOIS 60302		
KAREN H. BRONSON	104 S. SCOVILLE AVENUE - UNIT 1A	OAK PARK, ILLINOIS 60302		
SUMMER FIELDS	104 S. SCOVILLE AVENUE - UNIT 2A	OAK PARK, ILLINOIS 60302		
PATRICK A. SCHWARZ	104 S. SCOVILLE AVENUE - UNIT 2A	OAK PARK, ILLINOIS 60302		
CHERYL T. VARGAS	71 BLUFF AVENUE	LAGRANGE, ILLINOIS 60525	104 S. SCOVILLE AVENUE - UNIT 3A	OAK PARK, ILLINOIS 60302
MIKAL & JANICE MATTHEWS RASHEED	105 S. SCOVILLE AVENUE	OAK PARK, ILLINOIS 60302		
JULIAN OVERBECK	106 S. SCOVILLE AVENUE - UNIT 1B	OAK PARK, ILLINOIS 60302		
NANCY K. TECLAW & INGRID K SCHIMNOSKI	106 S. SCOVILLE AVENUE - UNIT 1B	OAK PARK, ILLINOIS 60302		
PADRAIG B. O'SHEA	106 S. SCOVILLE AVENUE - UNIT 2B	OAK PARK, ILLINOIS 60302		

KELSEY KLEIDON	106 S. SCOVILLE AVENUE - UNIT 3B	OAK PARK, ILLINOIS 60302		
ELIZAETH A. HOM	106 S. SCOVILLE AVENUE - UNIT 3B	OAK PARK, ILLINOIS 60302		
BETH R. HARVEY	107 S. SCOVILLE AVENUE	OAK PARK, ILLINOIS 60302		
MARK R. WISMER	108 S. SCOVILLE AVENUE - UNIT 1C	OAK PARK, ILLINOIS 60302		
WHITNEY REYNOLDS	108 S. SCOVILLE AVENUE - UNIT 1C	OAK PARK, ILLINOIS 60302		
RUTH ELLEN WILLIAMS	108 S. SCOVILLE AVENUE - UNIT 2C	OAK PARK, ILLINOIS 60302		
YOLANDA L. BOOT	108 S. SCOVILLE AVENUE - UNIT 3C	OAK PARK, ILLINOIS 60302		
FAISAL ALABSY & MELISA BURTON	109 S. SCOVILLE AVENUE	OAK PARK, ILLINOIS 60302		
GERALD KESSEL	110 S. SCOVILLE AVENUE - UNIT 1D	OAK PARK, ILLINOIS 60302		
GENEVA MANLEY & JANICE MATTHEWS RASHEED	110 S. SCOVILLE AVENUE - UNIT 1D	OAK PARK, ILLINOIS 60302		
RENEE & JILLIAN OVERBECK	479 N. HARLEM AVENUE	OAK PARK, ILLINOIS 60301	110 S. SCOVILLE AVENUE - UNIT 2D	OAK PARK, ILLINOIS 60302
YAKIRA LOVE	110 S. SCOVILLE AVENUE - UNIT 3D	OAK PARK, ILLINOIS 60302		
MARK KRZESZOWIEC	110 S. SCOVILLE AVENUE - UNIT 3D	OAK PARK, ILLINOIS 60302		
STEPHEN K. HARPER & ODALYS ACOSTA	108 S. EAST AVENUE - UNIT 1	OAK PARK, ILLINOIS 60302		
KAREN G. BARDEEN	108 S. EAST AVENUE - UNIT 2	OAK PARK, ILLINOIS 60302		
KTALIA SIMON	108 S. EAST AVENUE - UNIT 3	OAK PARK, ILLINOIS 60302		
KAREN HEINIG	108 S. EAST AVENUE - UNIT 4	OAK PARK, ILLINOIS 60302		
AVA LEWIS	110 S. EAST AVENUE - UNIT 1	OAK PARK, ILLINOIS 60302		
MATTHEW SMERAGLIA	110 S. EAST AVENUE - UNIT 2	OAK PARK, ILLINOIS 60302		
DENICE W. MARKHAM	110 S. EAST AVENUE - UNIT 2	OAK PARK, ILLINOIS 60302		
AFFSAR MAOVI & SHIRIN HASAN	110 S. EAST AVENUE - UNIT 3	OAK PARK, ILLINOIS 60302		
PILGRIM CONGREGATIONAL CHURCH OF OAK PARK	406 LAKE STREET	OAK PARK, ILLINOIS 60302		
LINAS & KATHLEEN SMULKSTYS	150 N. SCOVILLE AVENUE	OAK PARK, ILLINOIS 60302		
WILFRIDO VASQUEZ	150 N. SCOVILLE AVENUE	OAK PARK, ILLINOIS 60302		