

One Parkview Plaza
17W110 22nd Street, Suite 200
Oakbrook Terrace, Illinois 60181
Tel. 630 - 573 - 5149
Fax 630 - 573 - 5176

RUSH
OAK PARK HOSPITAL
SPONSORED BY THE WHEATON FRANCISCAN SISTERS

RUSH OAK PARK HOSPITAL
EMERGENCY DEPARTMENT
ADDITION
520 SOUTH MAPLE AVENUE
OAK PARK, IL 60304

IMEG
1100 WARRENVILLE ROAD, SUITE 400W
NAPERVILLE, ILLINOIS 60563
630.527.2320 FAX: 630.527.2321
www.imeg.com

ERIKSSON
ENGINEERING
ASSOCIATES, LTD.

KLOA
Kenigs, Lindgren, O'Hara, Aboonoo, Inc.

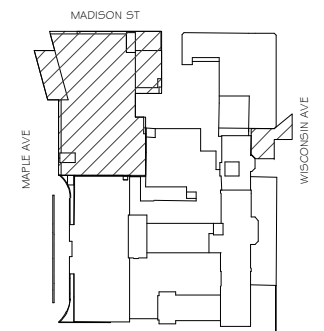

KEY PLAN

COPYRIGHT © AMA 2017

03/2017 1/1/15	50% REVIEW ISSUED FOR DESIGN DEVELOPMENT	
DATE	NO.	DESCRIPTION
<hr/>		
DATE: 00/00/00	SCALE: 1" = 1'-0"	
<hr/>		
DRAWN: Author	JOB NO. 16250.00	
<hr/>		
CHECKED: Checker		
<hr/>		
APPROVED: DEM		



PROPOSED ZONING MAP

A1-1A



2016 Zoning Map
Village of Oak Park, IL

Development Customer Services
Amended to February 29, 2016
The Property Centered in March 16, 2007
Road Center Line Centered in March 28, 2007

Legend

Zoning Districts

- B-1/B-2 General Business
- B-3 Central Business
- B-4 Downtown Business
- C Commercial
- MS Madison Street District
- H Hospital
- R-1 Single Family (10,000sf)
- R-2 Single Family (6,200sf or 10,000sf)
- R-3 Single Family (5,000sf or 10,000sf)
- R-4 Single Family (3,500sf or 10,000sf)
- R-5 Two Family (Single Family 3,500sf, Two Family 5,000sf or 10,000sf)
- R-6 Multiple Family
- R-7 Multiple Family

Historic Districts

- Frank Lloyd Wright Historic District
- Gunderson Historic District
- Ridgeland - Oak Park Historic District

Overlay Districts

- Perimeter Overlay District
- Transit-Related Retail Overlay District
- Downtown Lake Street Building Height and Massing Overlay District
- Marion Street Overlay District
- Roosevelt Road Form Based Overlay District

Planned Developments

- Euclid Place 1985-O-70
- 100 Forest Place 1994-O-30
- Elmwood Avenue Townhomes 2000-O-42
- Madison Street Townhomes 2001-O-110, 2003-O-25
- Euclid Terrace 2001-O-14, 2002-O-15, 2003-O-22
- Maple Square Townhomes 2001-O-80
- Ridgeland Station Parcel B 2002-O-06, 2003-O-41
- Belmont Village 2003-O-12
- The Ridgeland 2003-O-26
- The Oak Park Opera Club 2004-O-56, 2007-O-13, 2007-O-14
- WhiteCo Residential 2005-O-14, 2008-O-11 [Oak Park Place]
- Clarence Square Townhomes 2005-O-43
- Madison Street Townhomes 2005-O-46
- Garden Grove Townhomes 2007-O-21
- The Home Avenue Townhomes 2007-O-42, 2013-O-26
- Walgreens Development 2009-O-51, 2013-O-07
- Highland Place ORD 16-001
- Lake and Forest Development 2010-O-14, 2010-O-91, 2012-O-44
- Grove Avenue Apartments 2011-O-26, 2012-O-17
- Residences of Maple Place 2014-O-32
- Oak Park Oasis 2014-O-83
- Oak Park Station ORD 15-135

Transportation

- CTA Stations
- Blue Line - CTA Train
- Green Line - CTA Train
- I-290
- P-R Public ROW

Points of Interest

- High School
- Middle School
- Elementary School
- Park
- Hospital
- Library
- Post Office
- Village Hall
- Public Works Building

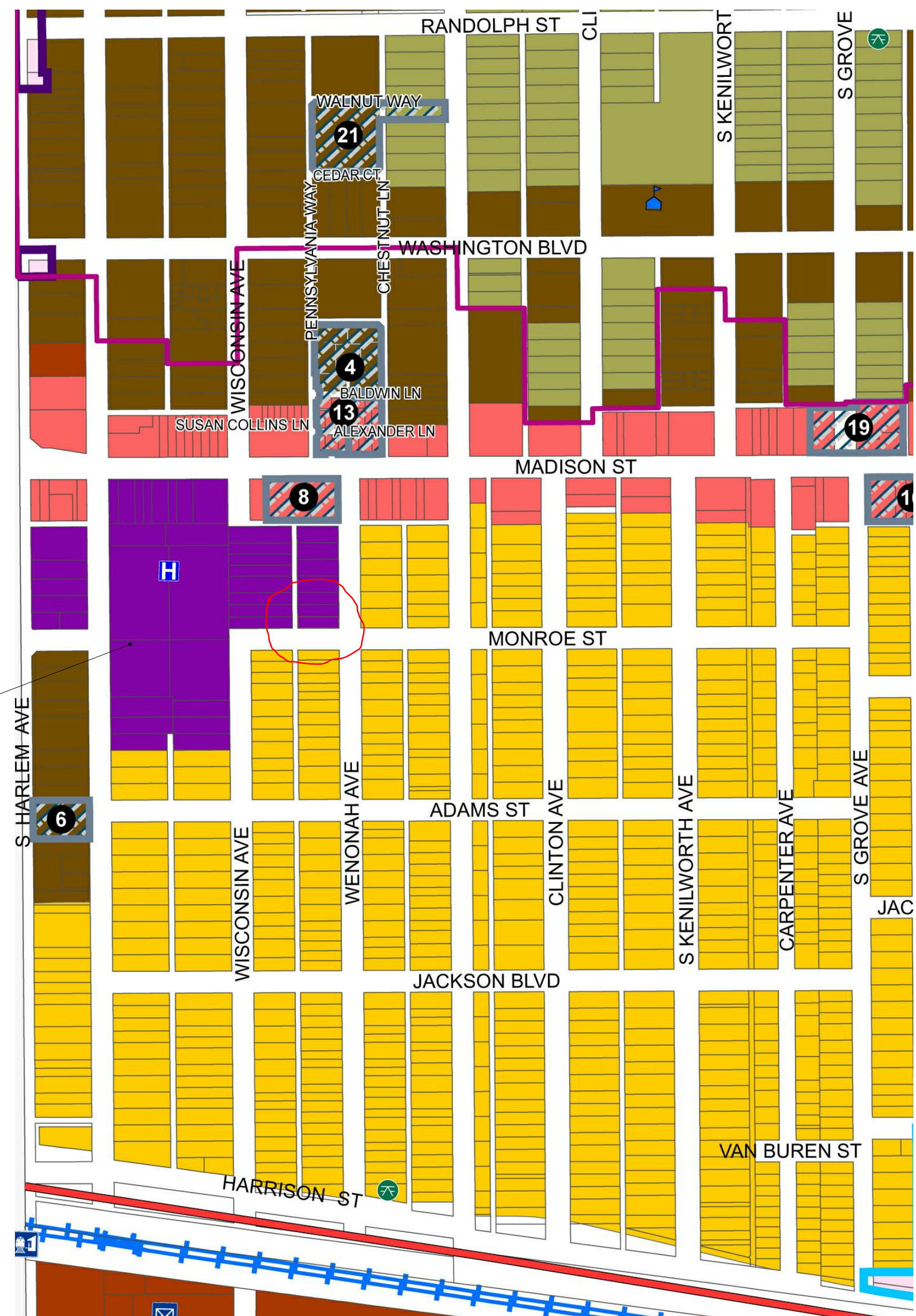

RUSH OAK PARK HOSPITAL