

**VILLAGE OF OAK PARK
2018 SIDEWALK POWER WASHING
INVITATION TO BID
18-111 PUBLIC WORKS
Issued April 25th, 2018**

The Village of Oak Park is seeking proposals from qualified power washing contractors for sidewalk power washing at various locations in the Village. Work is divided into three areas of work, Area A, Area B and Area C. Contractors may bid on one or two or all three areas.

Bids will be accepted at the Public Works Center, 201 South Blvd., Oak Park, IL 60302, Monday through Friday, 7:30 a.m. to 4:00 p.m., until 4:00 p.m. local time on Friday, May 4th, 2018.

Specifications and Bid forms may be obtained at the Public Works Center at the address listed above or by calling 708-358-5700. Information is also available from the Streets Superintendent, Scott Brinkman, sbrinkman@oak-park.us or on the Village's website <http://www.oak-park.us/your-government/finance-department>.

Do not detach any portion of this document. Upon formal award to the successful Contractor, a written agreement will be executed for the work.

The Village reserves the right to accept or reject any and all bids or to waive technicalities, or to accept any item of any bid.

Submission of Bids:

The Bid shall be submitted on the Bid form included herewith. The Bid shall be submitted in a sealed envelope marked "BID: 2018 Sidewalk Power Washing", shall bear the return address of the bidder, and shall be addressed as follows:

TO: Scott Brinkman, Streets Superintendent
Department of Public Works
201 South Blvd.
Oak Park, IL 60302

**VILLAGE OF OAK PARK
18-111 PUBLIC WORKS
2018 SIDEWALK POWER WASHING
SCOPE OF WORK**

General Scope of Work A:

1. Contractor will provide cleaning of the sealed, mortared bluestone (heated) sidewalks (a penetrating sealer was applied to these bluestone sidewalks), on the east and west side of Marion Street from Lake Street to North Boulevard and Westgate west for ½ block from Marion Street to the end of the pavers.
 2. Contractor will provide cleaning of the sealed, mortared bluestone sidewalks, (these are not heated sidewalks) east and west sides of Marion Street from the beginning of the pavers just south of Pleasant Street to North Boulevard. (Including under the viaduct).
 3. Contractor will provide cleaning of the sealed, mortared bluestone (not heated) sidewalks on the south side of Lake Street starting just west of 1119 Lake and continue west until Maple Ave. Shown in Exhibit A.
 4. Contractor will provide cleaning of the sealed, mortared bluestone (not heated) sidewalks on both north and south sides of Westgate at Maple Ave starting approximately 20' (north side) and 15' (south side) east of overhead walkway west to Maple Ave and continuing north (35') and south (75') on the east side of Maple. Locations Shown in Exhibit A.
 5. Contractor will provide cleaning of the sealed, mortared bluestone (not heated) sidewalks at the north east corner of North Blvd and Maple Avenue. Location shown in Exhibit A.
 6. Contractor will provide cleaning of the decorative blue sidewalks on the north and south sides of Chicago Ave between Harlem Ave and Marion St at specific locations. This is brand new sidewalk with inlay that needs to have special care in order to not be damaged. Locations shown in Exhibit B.
- Contractor must have a minimum of 5 years verifiable experience with cleaning sidewalks treated with PROSOCO SLX 100 sealer, a list of projects completed, and a list of references. This is to retain the Village's PROSOCO sealer warranty.
 - The required product for cleaning these sidewalks is PROSOCO's EnviroKlean 2010 All Surface Cleaner. This product is close to pH neutral and will not adversely affect the PROSOCO SLX 100 sealer. This cleaning will consist of applying this material via an applicator pump to the sidewalks followed by surface brush agitation then a low pressure hot water rinse to remove all chewing gum, grease, dirt, debris, surface contaminations and stains. Low pressure rinse is **mandatory to avoid any damage to the electric heat mat** under the heated mortared bluestone sidewalks. The Village shall approve the contractor's method and equipment prior to use.

- Contractor shall complete sidewalk washing in a professional manner and take caution to prevent damage to the sidewalk surface, and from removing sidewalk grout during the cleaning operation.
- Contractor shall ensure that adjacent windows to sidewalk areas are kept clean and any debris from the cleaning operation will be removed and work area cleaned at the end of the work.
- Work will be performed at night to minimize disruption to building, business and foot traffic.

General Scope of Work B:

- Contractor will provide cleaning of the sealed, mortared bluestone (not heated) sidewalks (a penetrating sealer was applied to these bluestone sidewalks), on the north side of Lake St from Forest Ave east to the Grace Episcopal Church parking lot entrance and also on the east side of Forest from Lake St north to the 19th Century Women's Club parking lot entrance. Approximate square footage equals 10,500 sf.
- Contractor must have a minimum of 5 years verifiable experience with cleaning sidewalks treated with PROSOCO SLX 100 sealer, a list of projects completed, and a list of references. This is to retain the Village's PROSOCO sealer warranty.
- The required product for cleaning these sidewalks is PROSOCO's EnviroKlean 2010 All Surface Cleaner. This product is close to pH neutral and will not adversely affect the PROSOCO SLX 100 sealer. This cleaning will consist of applying this material via an applicator pump to the sidewalks followed by surface brush agitation then a low pressure hot water rinse to remove all chewing gum, grease, dirt, debris, surface contaminations and stains. The Village shall approve the contractor's method and equipment prior to use.
- Contractor shall complete sidewalk washing in a professional manner and take caution to prevent damage to the sidewalk surface, and from removing sidewalk grout during the cleaning operation.
- Contractor shall ensure that adjacent windows to sidewalk areas are kept clean and any debris from the cleaning operation will be removed and work area cleaned at the end of the work.
- Work will be performed at night to minimize disruption to building, business and foot traffic.

General Scope of Work C:

- Contractor will provide sidewalk power washing services at the following locations:
1. Lake Street (north and south side): from Harlem Avenue east to Forest Avenue **with the exception of the blue stone sidewalk on the south side of Lake Street between Maple Avenue east to 1119**

Lake. See Exhibit A. Forest is an offset street at Lake Street; the north sidewalk goes further east than the south sidewalk. Also Marion Street (west side only) from Lake Street to Ontario.

2. **Maple Avenue (east side) from Lake Street to North Blvd where there is no decorative blue stone. See Exhibit A.**
3. **North Boulevard: north sidewalks in front of the shops from Marion to Forest Avenue adjacent to parking lot area.**
4. **Chicago Avenue (north and south sides) from Harlem Ave to Marion Street where there is no decorative blue sidewalk. See Exhibit B.** Also, east side of Marion St south of Chicago Ave until first parking lot entrance.
5. **Lake Street (north side): from Oak Park Avenue east to the first alley (before the AT&T building). Lake Street (south side) from Oak Park Avenue east, the sidewalk up to and including the 715 Lake Street building.**

Oak Park Avenue (west side): from Lake Street south to Pleasant Street, including sidewalk under the viaduct. Oak Park Avenue (east side): from Lake Street south to Pleasant Street, including sidewalk under the viaduct and from Lake Street north to 150 N. Oak Park Avenue.

North Boulevard: the north side of North Boulevard from Oak Park Avenue west to Cucina Paradiso restaurant including front sidewalk patio area of restaurant.

6. **Lake Street (north and south side) from Austin Boulevard to Humphrey Avenue. Austin Boulevard (west side) from first alley north of Lake Street to North Boulevard.**
 7. **Chicago Avenue (north and south side) from Austin Boulevard to Humphrey Avenue. Austin Boulevard (west side) from first alley north of Chicago Avenue to first alley south of Chicago Avenue.**
 8. **Madison Street (north and south side) from Austin Boulevard to Humphrey Avenue. Austin Boulevard (west side) from first alley north of Madison Street to first alley south of Madison Street.**
 9. **Oak Park Avenue (east and west side) from Van Buren Street to Harrison Street and from Garfield Street to first alley south. Harrison Street (north side) from first alley east of Oak Park Avenue to first alley west of Oak park Avenue. Garfield Street (north side) from east edge of Sign Express business to first alley west of Oak Park Avenue.**
- **Contractor will clean sidewalks of chewing gum, grease, dirt, debris, surface contaminates and stains. This will consist of applying a biodegradable cleaner/degreaser to the sidewalks followed by surface agitation, if necessary, to loosen debris and surface staining.**
 - **Contractor will complete sidewalk power washing in a professional manner and take caution to prevent damage to sidewalk surface.**

- Contractor will ensure that adjacent windows to sidewalk areas are kept clean and any non-liquid debris from the cleaning operation will be removed and work area cleaned at the end of the work.
- Brick paver sidewalk areas shall be re-sanded as needed.
- Work will be performed at night to minimize disruption to building, business and foot traffic.
- Contractors who do not wish to come to the Public Works Center building to fill their water tanks may place a \$1,500.00 deposit with the Finance Water Billing Department and be issued an appropriately sized hydrant meter from the Pumping Station. The cost for the water will be paid for by the Village.
- Upon formal award to the successful Contractor, a written agreement will be executed for the services.

Contractor will be required to obtain and maintain in force during the performance of the contract, insurance as required by the Village.

**VILLAGE OF OAK PARK
BID FORM
18-111 PUBLIC WORKS
2018 SIDEWALK POWER WASHING**

COST TO COMPLETE THE WORK AS DESCRIBED ABOVE: Area A \$ _____
Area B \$ _____
Area C \$ _____
Total: \$ _____

Please include in your bid a separate on-call rate per hour for sidewalk cleaning, throughout the year, and minimum number of hours.

Cost/ per hour \$ _____
Minimum no. of hours _____

Company Name: _____

Company Representative: _____

Phone: _____

FAX: _____

E-mail: _____

Signature of Company Representative: _____

Date: _____

Please contact Streets Superintendent, Scott Brinkman at 708-358-5743 or sbrinkman@oak-park.us with any questions.

Exhibit A

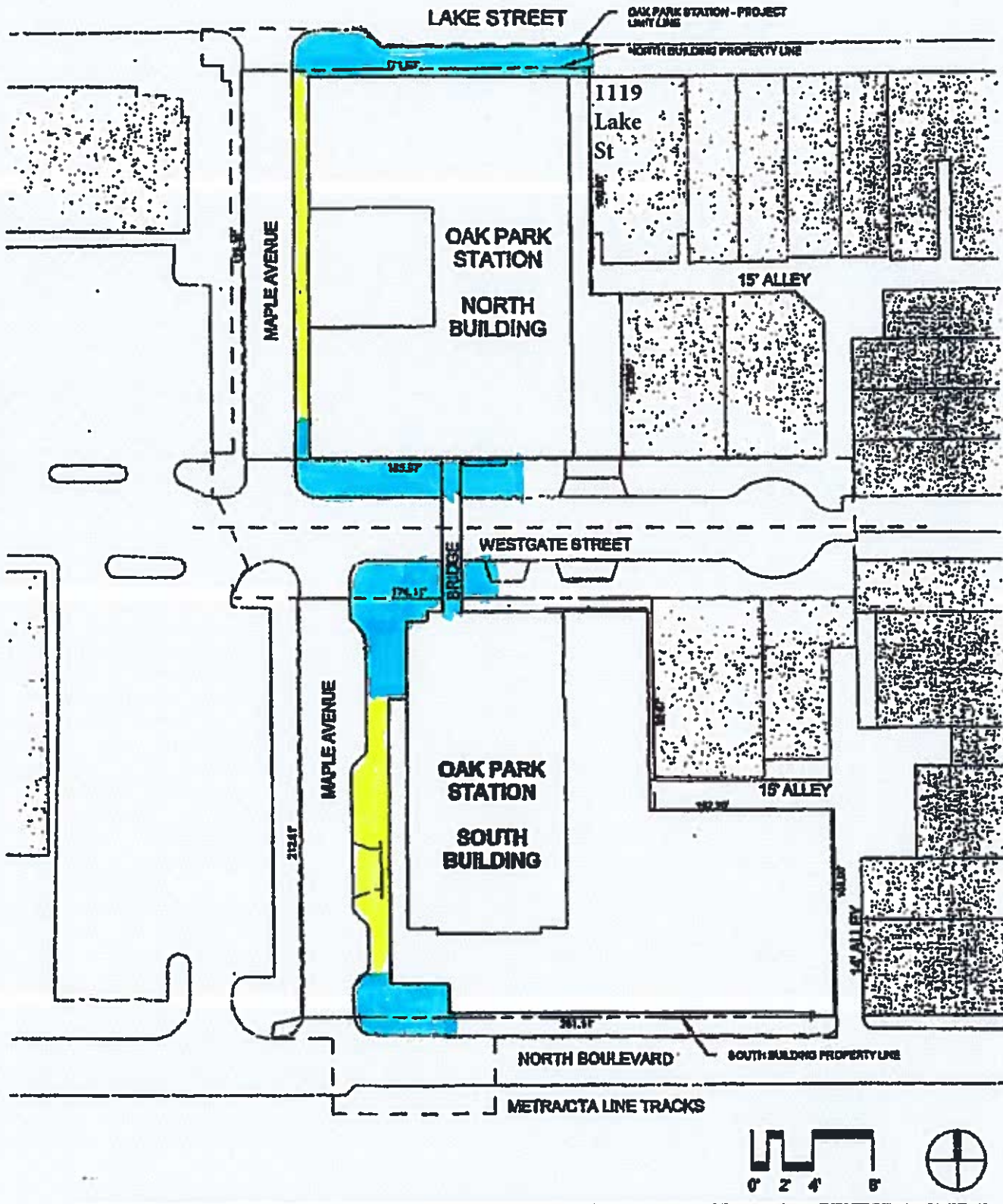
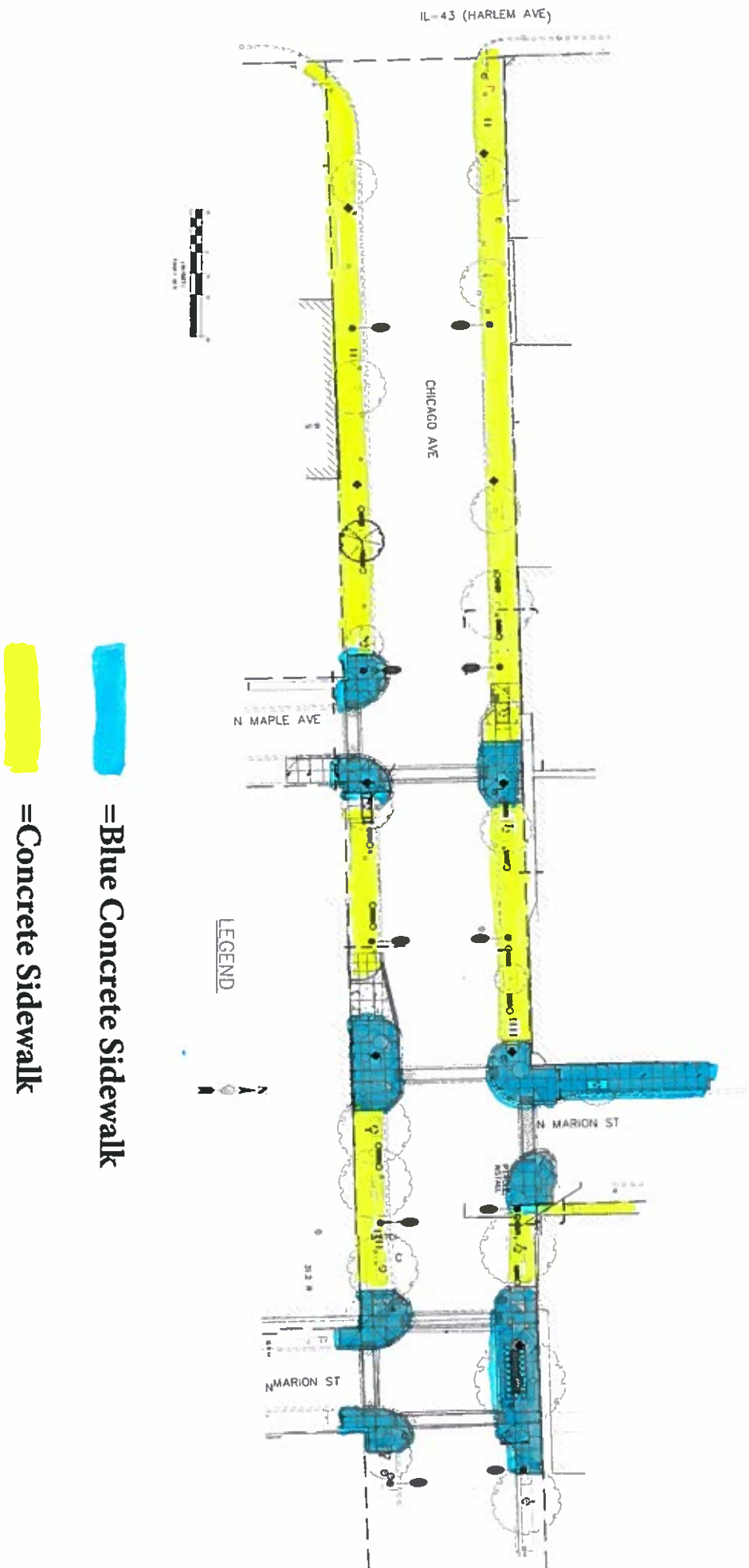

Exhibit B





2010 All Surface Cleaner

multiple-use cleaner and degreaser

OVERVIEW

Enviro Klean® 2010 All Surface Cleaner is a "next-generation" product for cleaning and degreasing light-to-heavily soiled stone, tile, masonry and much more.

Powerful enough for industrial use, flexible enough for jobs around the home, space-saving EK 2010 replaces a host of individual cleaning agents. It's dilutable for home-use on windows, bathroom tub and tile, counter tops and more. It's concentrated for the toughest industrial cleaning jobs on concrete, metal and many other plant and warehouse surfaces. EK 2010 also removes Sure Klean® Weather Seal Siloxane PD over spray from windows.

Easy-to-use EK 2010 All Surface Cleaner is water-rinsable and contains no harsh acids, caustics or solvents.

SPECIFICATIONS

For all PROSOCO product specifications visit www.prosoco.com and click on "SpecBuilder" or "Solution Finder."

ADVANTAGES

- Cleans and degreases light-to-heavily soiled stone, tile, masonry and much more.
- Effectively removes moderate biological staining.
- Dilutable for jobs around the home.
- Replaces a host of individual cleaning agents.
- Effective cleaner for windows, bathroom tub and tile, counter tops and more.
- Easy-to-use and water-rinsable.
- Contains no harsh acids, caustics or solvents.

Limitation

- Repeated use may dull polished carbonate surfaces, including but not limited to limestone, marble and travertine.

REGULATORY COMPLIANCE

VOC Compliance

Enviro Klean® 2010 All Surface Cleaner is compliant with all national, state and district regulations.

TYPICAL TECHNICAL DATA

FORM	clear green liquid
SPECIFIC GRAVITY	1.070
pH	10.5 7.8 – 8.2 Typical Rinsewater
WT/GAL	8.90 lbs
ACTIVE CONTENT	Not applicable
TOTAL SOLIDS	Not applicable
VOC CONTENT	Not applicable
FLASH POINT	>200°F (>93°C) ASTM D 3278
FREEZE POINT	32°F (0°C)
SHELF LIFE	3 years in tightly sealed, unopened container

2010 All Surface Cleaner

PREPARATION

Protect people, vehicles, property, plants and all surfaces not set for cleaning from the product, splash, rinse, residue, fumes and wind drift. Test all surfaces that may come in contact for compatibility. Immediately rinse non target materials with large quantities of water. Grass and plantings may be protected with sprinklers. Divert pedestrian and auto traffic if necessary. Clean when traffic is at a minimum.

Surface and Air Temperatures

Cleaning when temperatures are below freezing or will be overnight may harm masonry. Best air and surface temperatures for cleaning are 50°F (10°C) or above. If freezing conditions exist before application, let masonry thaw.

Equipment

Apply with low-pressure sprayer, brush or heavy nap roller. Scrub heavily soiled surfaces with a nonabrasive brush or synthetic scrubbing pad.

Rinse with enough water and pressure to flush spent cleaner and dissolved soiling from the masonry surface and surface pores without damage. Masonry-washing equipment generating 400–1000 psi with a water flow rate of 6–8 gpm is the best water/pressure combination for rinsing porous masonry. Use a 15–45° fan spray tip. Heated water (150–180°F; 65–82°C) may improve cleaning efficiency.

Use adjustable equipment for reducing water flow rates and rinsing pressure for sensitive surfaces. Rinsing pressures greater than 1000

psi and fan spray tips smaller than 15° may permanently damage sensitive masonry. Water flow rates less than 6 gpm may reduce cleaning productivity and contribute to uneven cleaning results.

Storage and Handling

Keep from freezing. Store in a cool, dry place. Always seal container after dispensing. Do not alter or mix with other chemicals. Published shelf life assumes upright storage of factory-sealed containers in a dry place. Maintain temperature of 45–100°F (7–38°C). Do not double stack pallets. Dispose of in accordance with local, state and federal regulations.

ALWAYS TEST

ALWAYS TEST a small area of each surface to confirm suitability and desired results before starting overall application. Test with the same equipment, recommended surface preparation and application procedures planned for general application.

APPLICATION

Before use, read "Preparation" and "Safety Information."

ALWAYS TEST each type of surface and each type of stain for suitability, dilution, dwell-time and results. Use the following application instructions.

Dilution

Use in concentrate to remove heavy soiling. When used as a light-duty cleaner, dilute up to 1 part cleaner to 10 parts clean water.

Application Instructions

1. Working from the bottom to the top, prewet the surface with clean water.
2. Apply the appropriately diluted solution to the masonry surface using a brush or low-pressure spray.
3. Let the cleaner stay on the surface 1–10 minutes, based on testing. Gently scrub heavily soiled areas.
NOTE: Do not let EK 2010 dry on the surface. If drying occurs, lightly wet surfaces with fresh water and reapply the cleaner in a gentle scrubbing manner.
4. Working from the bottom to the top, rinse the surface thoroughly with clean water.
5. Repeat steps 1 through 4 if necessary.

Cleanup

Clean tools and equipment using fresh water.

Recommended for these substrates. Always test. Coverage is in sq.ft./m. per gallon of concentrate.			
Substrate	Type	Use?	Coverage
Architectural Concrete Block	Burnished	yes	50–150 sq.ft. 5–14 sq.m.
	Smooth	yes	
	Split-faced	yes	
	Ribbed	yes	
Concrete	Brick	yes	50–150 sq.ft. 5–14 sq.m.
	Tile	yes	
	Precast Panels	yes	
	Pavers	yes	
	Cast-in-place	yes	
Fired Clay	Brick	yes	150–500 sq.ft. 14–46 sq.m.
	Tile	yes	
	Terra Cotta	yes	
	Pavers	yes	
Marble, Travertine, Limestone	Polished	yes	500–1000 sq.ft. 46–93 sq.m.
	Unpolished	yes	150–500 sq.ft. 14–46 sq.m.
Granite	Polished	yes	500–1000 sq.ft. 46–93 sq.m.
	Unpolished	yes	150–500 sq.ft. 14–46 sq.m.
Sandstone	Unpolished	yes	150–500 sq.ft. 14–46 sq.m.
Slate	Unpolished	yes	150–500 sq.ft. 14–46 sq.m.
Always test to ensure desired results. Coverage estimates depend on surface texture and porosity.			



2010 All Surface Cleaner

PRODUCT DATA SHEET
PROSOCO
SINCE 1939

SAFETY INFORMATION

Enviro Klean® 2010 All Surface Cleaner is a water-reduced cleaning product. Use appropriate safety equipment and job site controls during handling and application. Read the full label and MSDS for precautionary instructions before use.

First Aid

Ingestion: If conscious, give large amounts of water and call a physician, emergency room or poison control center immediately. Induce vomiting with instruction by medical personnel.

Eye Contact: Rinse thoroughly for 15 minutes. Get medical assistance if irritation persists.

Skin Contact: Remove contaminated clothing and rinse thoroughly. Get medical attention if irritation persists. Launder contaminated clothing before reuse.

Inhalation: Remove to fresh air. Get medical attention as necessary.

24-Hour Emergency Information:
INFOTRAC at 800-535-5053

WARRANTY

The information and recommendations made are based on our own research and the research of others, and are believed to be accurate. However, no guarantee of their accuracy is made because we cannot cover every possible application of our products, nor anticipate every variation encountered in masonry surfaces, job conditions and methods used. The purchasers shall make their own tests to determine the suitability of such products for a particular purpose.

PROSOCO, Inc. warrants this product to be free from defects. Where permitted by law, PROSOCO makes no other warranties with respect to this product, express or implied, including without limitation the implied warranties of merchantability or fitness for particular purpose. The purchaser shall be responsible to make his own tests to determine the suitability of this product for his particular purpose. PROSOCO's liability shall be limited in all events to supplying sufficient product to re-treat the specific areas to which defective product has been applied. Acceptance and use of this product absolves PROSOCO from any other liability, from whatever source, including liability for incidental, consequential or resultant damages whether due to breach of warranty, negligence or strict liability. This warranty may not be modified or extended by representatives of PROSOCO, its distributors or dealers.

CUSTOMER CARE

Factory personnel are available for product, environment and job-safety assistance with no obligation. Call 800-255-4255 and ask for Customer Care - technical support.

Factory-trained representatives are established in principal cities throughout the continental United States. Call Customer Care at 800-255-4255, or visit our web site at www.prosoco.com, for the name of the Enviro Klean® representative in your area.

BEST PRACTICES

Rinse with enough water and pressure to flush spent cleaner and dissolved soiling from the masonry surface and surface pores without damage. Masonry-washing equipment generating 400–1000 psi with a water flow rate of 6–8 gpm is the best water/pressure combination for rinsing porous masonry. Use a 15–45° fan spray tip. Heated water may improve cleaning efficiency.

Do not let EK 2010 dry on the surface. If drying occurs, lightly wet surfaces with fresh water and reapply the cleaner in a gentle scrubbing manner.

Repeated use may dull polished carbonate surfaces, including but not limited to limestone, marble and travertine.

Never go it alone. For problems or questions, contact your local PROSOCO distributor or field representative. Or call PROSOCO technical Customer Care toll-free at 800-255-4255.

CONSOLIDECK®
HIGH PERFORMANCE CONCRETE

SLX100® Water & Oil Repellent

deep penetrating water, oil & stain blocker

OVERVIEW

Consolideck® SLX100® Water & Oil Repellent combines water and oil repellency on most substrates to prevent staining by waterborne and oily substances. This modified "neat" silane system offers invisible protection and low volatility.

The small molecular structure of SLX100® allows for maximum penetration at coverage rates higher than that of conventional silanes. Depth of penetration is controlled by the application rate (loading rate). This makes SLX100® ideal for protecting concrete. Additionally, SLX100® forms an effective chloride screen that reduces surface erosion and corrosion of rebar in reinforced concrete caused by water and water-carried salts.

SPECIFICATIONS

For all PROSOCO Product specifications visit www.prosoco.com and click on "Specbuilder" or "Solution Finder".

ADVANTAGES

- Normally will not create color change, even on dense surfaces.
- Provides long-lasting protection.
- Compatible with lithium silicate hardeners and densifiers.
- Treated surfaces "breathe" — does not trap moisture.
- Coverage rate higher than typical water repellents or other stain-resistant impregnators.
- Resists oil and food stains. Does not form a surface film or gloss.
- Excellent surface beading when compared with conventional "neat" silanes.
- Appropriate for application to concrete which is cured, cured and honed, cured and polished or cured and highly polished.
- Safe for use on surfaces subjected to vehicular traffic.

Limitations

- Not recommended for asphalt or other non masonry materials.
- Not recommended for below-grade applications or for use under hydrostatic pressure.
- Always pretest to ensure desired results before application to floors previously treated with Consolideck® LSGuard®. See "Best Practices" on page 3.
- Not available in all air quality management jurisdictions, except in regulation-exempt small container sizes.

REGULATORY COMPLIANCE

VOC Compliance

Consolideck® SLX100® Water & Oil Repellent is compliant with the following national, state and district AIM VOC regulations:

- ☒ US Environmental Protection Agency
- ☐ California Air Resources Board SCM Districts*
- ☐ South Coast Air Quality Management District*
- ☒ Maricopa County, AZ
- ☒ Northeast Ozone Transport Commission

*Before application, verify product conformance with local and state codes.

TYPICAL TECHNICAL DATA

FORM	clear liquid, slight solvent odor
SPECIFIC GRAVITY	0.913
pH	Not applicable
WT/GAL	7.60 lbs
ACTIVE CONTENT	93%
TOTAL SOLIDS	58%
VOC CONTENT	400 g/L maximum
FLASH POINT	80°F (27°C) ASTM D 3278
FREEZE POINT	No data
SHELF LIFE	1 year in tightly-sealed, unopened container

SLX100® Water & Oil Repellent

PREPARATION

Protect passersby, building occupants, people, vehicles, property, glass, plants and all non masonry from product, residue, splash, fumes, mist and wind drift. Divert and/or protect auto and pedestrian traffic.

Ensure fresh air entry and cross ventilation during application and drying. Extinguish all flames, pilot lights and other potential sources of ignition during use and until all vapors are gone. When applying to exteriors of occupied buildings, make sure all windows, exterior intakes and air conditioning vents are covered and air handling equipment are shut down during application and until vapors have dissipated.

If possible, install all caulking, patching and joint sealants before applying. If impractical, special joint preparation may be required to ensure caulk adhesion.

For maximum penetration, clean surfaces thoroughly with appropriate Consolideck® cleaner. Cure new concrete thoroughly before applying. Surfaces may be damp but should be absorbent for good penetration.

NOTE: Some floor and wall systems incorporate asphaltic or other crack suppression membranes. This deeply penetrative protective treatment may penetrate through exposed surfaces and react with the membrane to mobilize objectionable staining. Always test for desired results.

Specifier's Note — Curing New Concrete: Blanket or water curing is recommended whenever possible. If a chemical curing agent is required, dissipating curing agents are recommended. Avoid over application of the curing agent. Remove all surface films and contaminants before application.

Surface and Air Temperatures

Should be 40–90°F (4–32°C) during application. Do not apply over 90°F (32°C). Avoid application on hot, windy days.

Equipment

Preferred method of application is with low-pressure (<50 psi), pump type spray equipment. Adjust tip to prevent atomization during application. Battery powered pump sprayers should be rated as explosion proof. Sprayers should be fitted with solvent-resistant hoses and gaskets to avoid discoloration. Solvent-resistant brushes and rollers, or lamb's wool applicators are okay for small-scale applications.

Storage and Handling

Store in a cool, dry place away from potential ignition sources. Keep tightly closed when not dispensing. Published shelf life assumes upright storage of factory-sealed containers in a dry place. Maintain temperatures of 45–100°F (7–38°C). Do not double stack pallets. Dispose of unused product and container in accordance with local, state and federal regulations.

APPLICATION

Before use, read "Preparation" and "Safety Information."

ALWAYS TEST each type of surface for suitability and desired results before overall application. Test using the following application instructions. Let test dry thoroughly before inspection.

Dilution

Use in concentrate. Do not dilute or alter material. Stir or mix well before use.

Coverage Rates

Coverage varies based on porosity and texture. Always test.

- 200–600 square feet per US gallon
- 19–56 square meters per US gallon
- 8–14 square meters per liter

ALWAYS TEST

ALWAYS TEST a small area of each surface to confirm suitability and desired results before starting overall application. Test with the same equipment, recommended surface preparation and application procedures planned for general application.

Application Instructions

Horizontal Surfaces

1. Apply in a single application. Use enough material to keep the surface wet for about a minute before penetrating.
2. Broom out all puddles thoroughly until they completely penetrate the surface.
3. Wipe down excess with a clean, absorbent towel.

On extremely porous substrates, two applications will provide superior protection. Apply the second coat within a few minutes after the first coat has penetrated and appears dry.

Drying Time

Protect treated surfaces from rain, foot and vehicular traffic for at least 4 hours after application. SLX100® gains its oil resistance properties in 24 hours and water repellency properties in 72 hours.

SLX100® Water & Oil Repellent

Cleanup

Clean tools and equipment immediately with mineral spirits or equivalent cleaning solvent. Remove rundown and spills as soon as possible. Container may retain residues. Keep from ignition sources. Do not reuse.

Maintenance

Do not buff or burnish until at least 24 hours after application. Burnishing equipment must be fitted with an active vacuum particulate capture system. Remove surface dust and debris daily using a micro fiber pad or dry dust mop. Maintain the floor with Consolideck® LS-Klean Super Concentrate. This product was developed to further enhance the long-term performance of your finished concrete floor.

Do not use acidic cleaners. Though Consolideck® SLX100® will improve the resistance of concrete surfaces to staining, acid concentrates and acidic foods may etch the floor and leave a residual stain. Clean up all spills quickly to minimize any potential for damage.

SAFETY INFORMATION

Consolideck® SLX100® Water & Oil Repellent is a solvent-carried product and may cause symptoms typical with organic solvent exposure. This product contains a material that can cause serious lung damage or impairment if inhaled as an aerosol or fine mist. **DO NOT ATOMIZE DURING APPLICATION.** Use approved respiratory protection if aerosols or mists are present and as necessary for solvent exposure. This is a flammable material. Use appropriate ventilation, safety equipment, and job site controls during application and handling. Read the full label and MSDS for precautionary instructions before use.

First Aid

Ingestion: Call physician immediately. Treat as methanol ingestion.

Eye Contact: Rinse eyes thoroughly for 15 minutes. Get medical attention.

Skin Contact: Rinse thoroughly. Get medical attention if irritation persists.

Inhalation: Remove to fresh air. Give artificial respiration if not breathing. Get immediate medical attention.

24 Hour Emergency Information:
INFOTRAC at 800-535-5053

BEST PRACTICES

Surfaces to be treated must be clean, dry and absorbent.

Remove all loose construction debris and foreign materials from surfaces to be treated using a dry broom. Remove all curing compounds, coatings, paint, wax, embedded soiling, rust, grease and oil using the appropriate Consolideck® surface preparation cleaner.

Acid-stained concrete must be thoroughly neutralized and rinsed prior to application.

Floor may be treated with Consolideck® LS® or LS/CS® prior to application of Consolideck® SLX100® Water & Oil Repellent.

Preferred method of application is with low-pressure (<50 psi), pump type spray equipment. Adjust tip to prevent atomization during application. Sprayers should be fitted with solvent-resistant hoses and gaskets.

Maintain Consolideck® hardened floors with Consolideck® LS-Klean Super Concentrate.

Floors treated and burnished with Consolideck® LS-Guard® may be treated with a light coat of SLX100®. Always perform a test area first to ensure desired results.

Never go it alone. If you have problems or questions, contact your local PROSOCO distributor or field representative. Or call PROSOCO technical Customer Care, toll-free, at 800-255-4255.

SLX100® Water & Oil Repellent

WARRANTY

The information and recommendations made are based on our own research and the research of others, and are believed to be accurate. However, no guarantee of their accuracy is made because we cannot cover every possible application of our products, nor anticipate every variation encountered in masonry surfaces, job conditions and methods used. The purchasers shall make their own tests to determine the suitability of such products for a particular purpose.

PROSOCO, Inc. warrants this product to be free from defects. Where permitted by law, PROSOCO makes no other warranties with respect to this product, express or implied, including without limitation the implied

warranties of merchantability or fitness for particular purpose. The purchaser shall be responsible to make his own tests to determine the suitability of this product for his particular purpose. PROSOCO's liability shall be limited in all events to supplying sufficient product to re-treat the specific areas to which defective product has been applied. Acceptance and use of this product absolves PROSOCO from any other liability, from whatever source, including liability for incidental, consequential or resultant damages whether due to breach of warranty, negligence or strict liability. This warranty may not be modified or extended by representatives of PROSOCO, its distributors or dealers.

CUSTOMER CARE

Factory personnel are available for product, environment and job-safety assistance with no obligation. Call 800-255-4255 and ask for Customer Care - technical support.

Factory-trained representatives are established in principal cities throughout the continental United States. Call Customer Care at 800-255-4255, or visit our web site at www.prosoco.com, for the name of the Consolideck® representative in your area.