

Parking Permit Map

RIVER FOREST

FOREST PARK

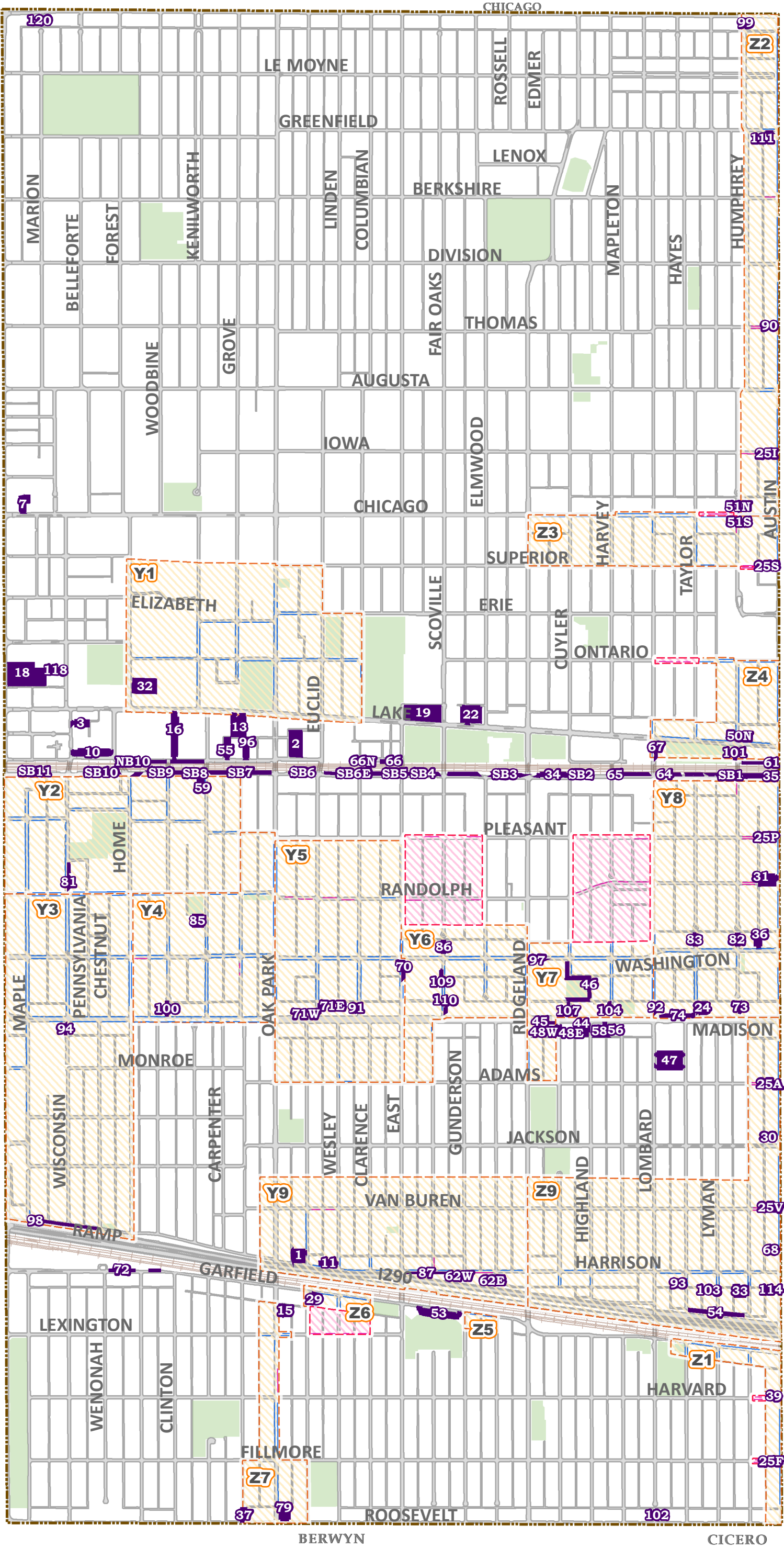

Legend

- On-Street Permit Parking
- On-Street Permit Parking - Extended Area
- Multi-Family dwellings eligible for overnight zone permit Extended Area
- 0 Off-Street Lot
- 0 Multi-Family dwellings eligible for overnight zone permit

Please refer to specific permit lot/zone guidelines for additional information.

*For the interactive, online map use
www.oak-park.us/parkingmap

** This map is a graphic representation of the parking areas. Always park in areas designated by signs in the field and follow applicable guidelines.

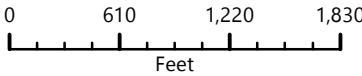
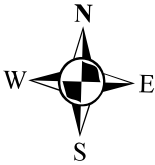

1:12,750

DISCLAIMER: This drawing is neither a legally recorded map nor a survey, and is not intended to be used as such. This drawing is a compilation of records, information and data located in various village, county and state offices, and other sources, affecting the land area displayed and is to be used for reference purposes only. The Village of Oak Park shall not be responsible for any inaccuracies herein contained. If discrepancies are found, please contact Parking and Mobility Services.

Parking Permit Map - Y1

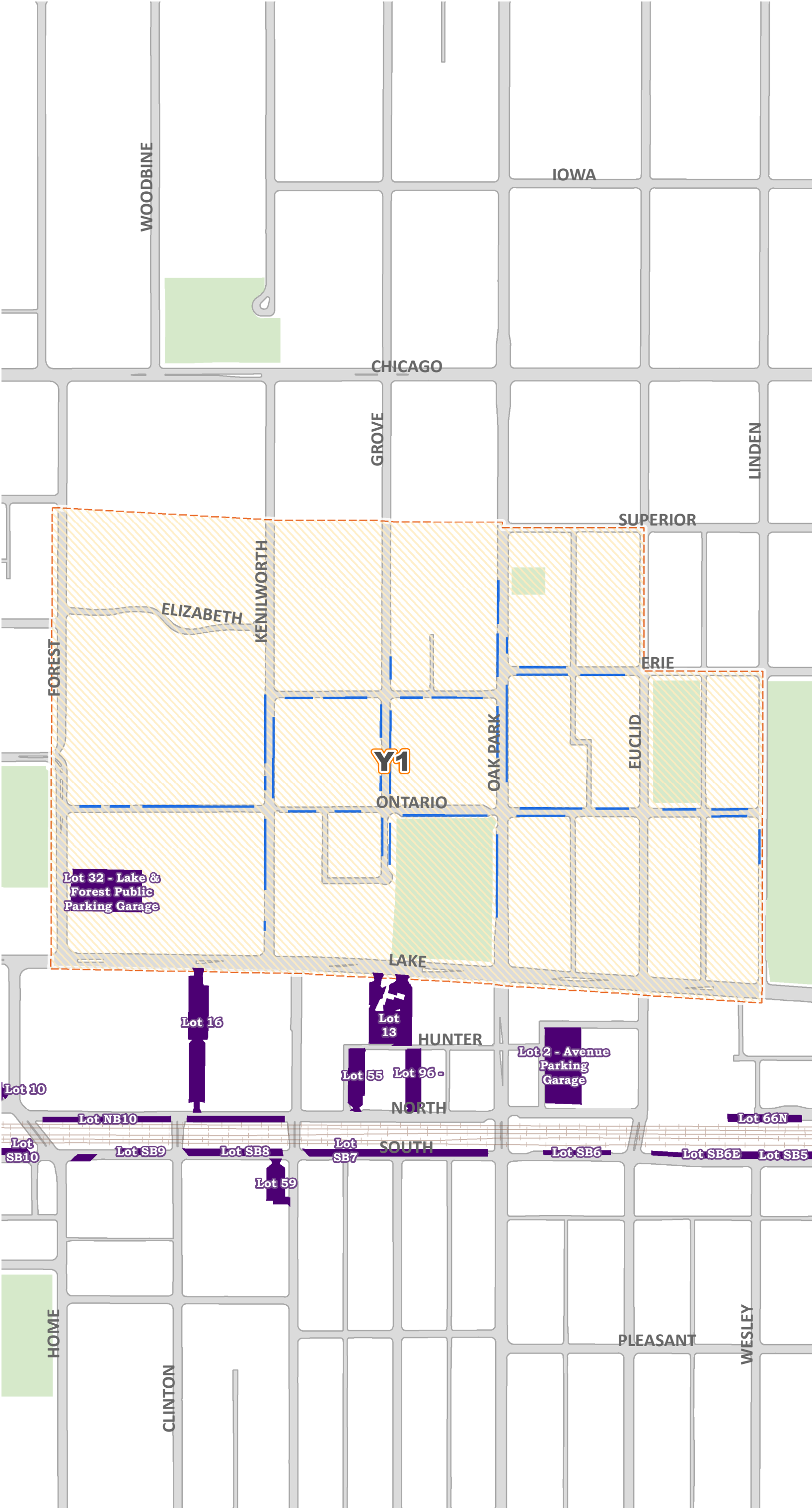

Legend

Y1 On-Street Permit Parking

Y1 On-Street Permit Parking - Extended Area

Multi-Family dwellings eligible for overnight zone permit Extended Area

0

Off-Street Lot

Multi-Family dwellings eligible for overnight zone permit

Please refer to specific permit lot/zone guidelines for additional information.

*For the interactive, online map use
www.oak-park.us/parkingmap

** This map is a graphic representation of the parking areas. Always park in areas designated by signs in the field and follow applicable guidelines.



1:4,009

DISCLAIMER: This drawing is neither a legally recorded map nor a survey, and is not intended to be used as such. This drawing is a compilation of records, information and data located in various village, county and state offices, and other sources, affecting the land area displayed and is to be used for reference purposes only. The Village of Oak Park shall not be responsible for any inaccuracies herein contained. If discrepancies are found, please contact Parking and Mobility Services.



Parking Permit Map - Y2

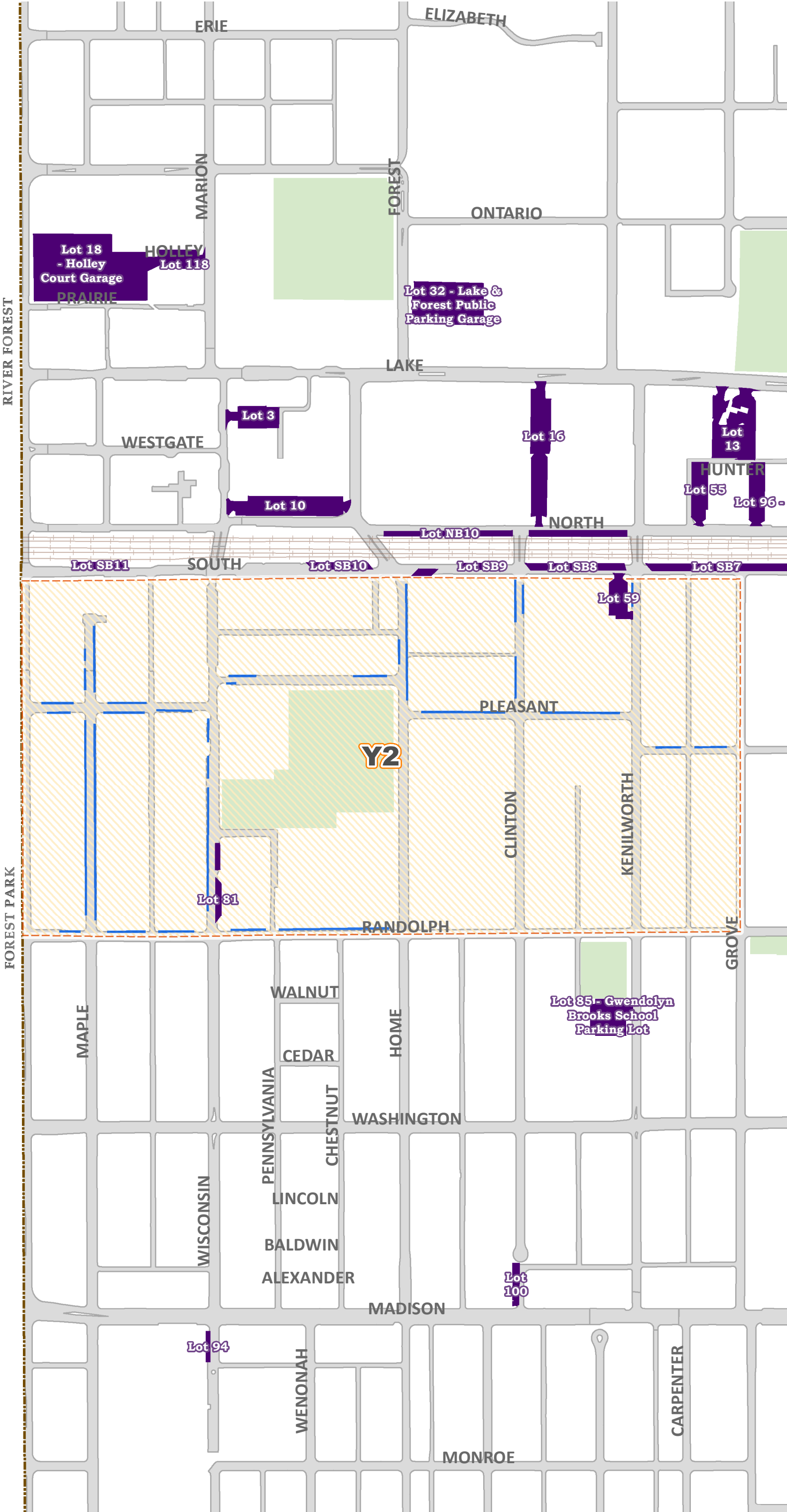

Legend

Y2 On-Street Permit Parking

Y2 On-Street Permit Parking - Extended Area

Multi-Family dwellings eligible for overnight zone permit Extended Area

Off-Street Lot

Multi-Family dwellings eligible for overnight zone permit

Please refer to specific permit lot/zone guidelines for additional information.

*For the interactive, online map use www.oak-park.us/parkingmap

** This map is a graphic representation of the parking areas. Always park in areas designated by signs in the field and follow applicable guidelines.

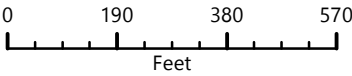

1:3,993

DISCLAIMER: This drawing is neither a legally recorded map nor a survey, and is not intended to be used as such. This drawing is a compilation of records, information and data located in various village, county and state offices, and other sources, affecting the land area displayed and is to be used for reference purposes only. The Village of Oak Park shall not be responsible for any inaccuracies herein contained. If discrepancies are found, please contact Parking and Mobility Services.



Parking Permit Map - Y4

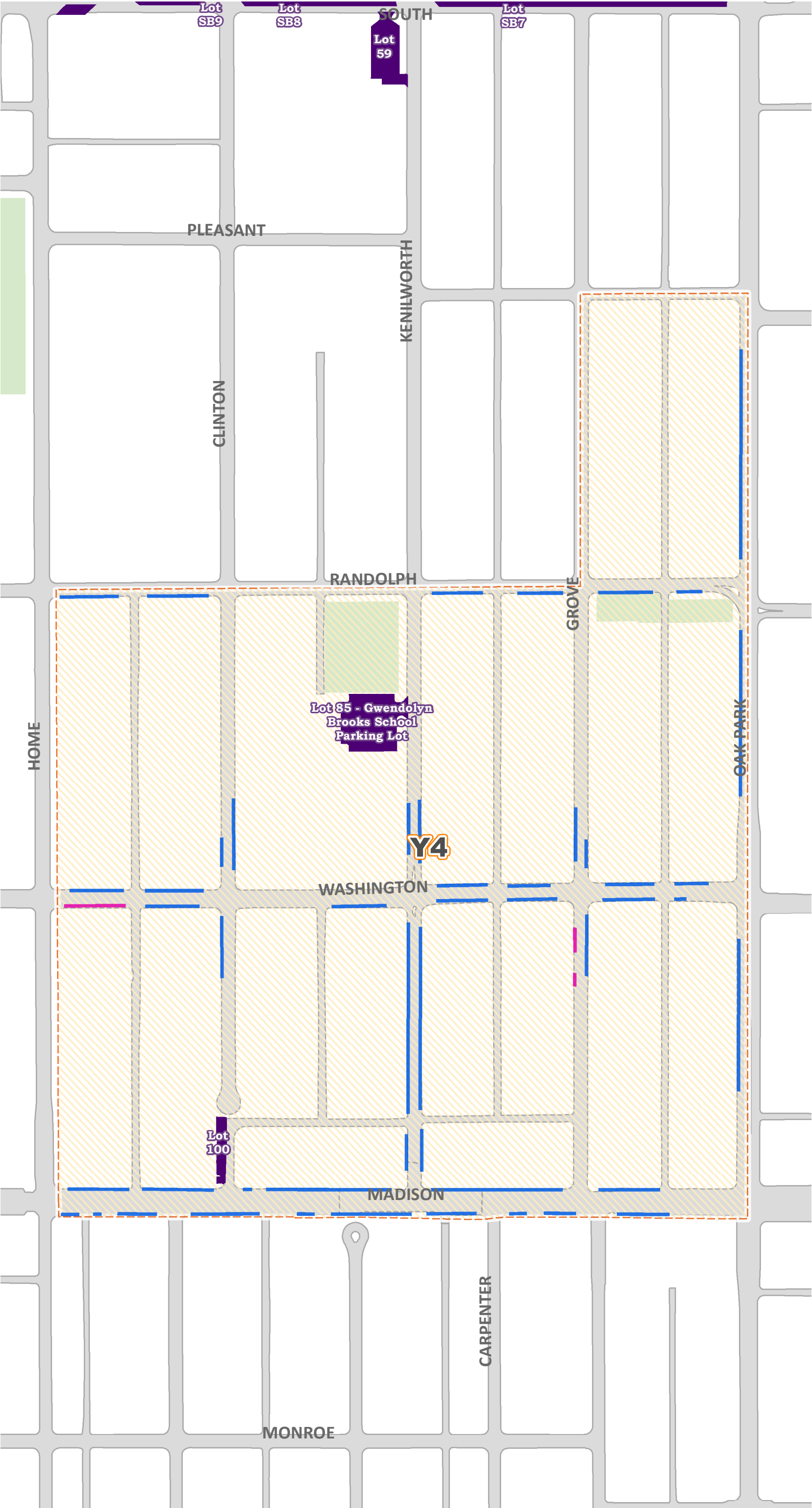

Legend

Y4 On-Street Permit Parking

Y4 On-Street Permit Parking - Extended Area

Multi-Family dwellings eligible for overnight zone permit Extended Area

Off-Street Lot

Multi-Family dwellings eligible for overnight zone permit

Please refer to specific permit lot/zone guidelines for additional information.

*For the interactive, online map use
www.oak-park.us/parkingmap

** This map is a graphic representation of the parking areas. Always park in areas designated by signs in the field and follow applicable guidelines.

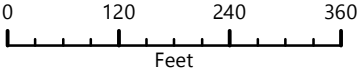

1:2,486

DISCLAIMER: This drawing is neither a legally recorded map nor a survey, and is not intended to be used as such. This drawing is a compilation of records, information and data located in various village, county and state offices, and other sources, affecting the land area displayed and is to be used for reference purposes only. The Village of Oak Park shall not be responsible for any inaccuracies herein contained. If discrepancies are found, please contact Parking and Mobility Services.

Parking Permit Map - Y5

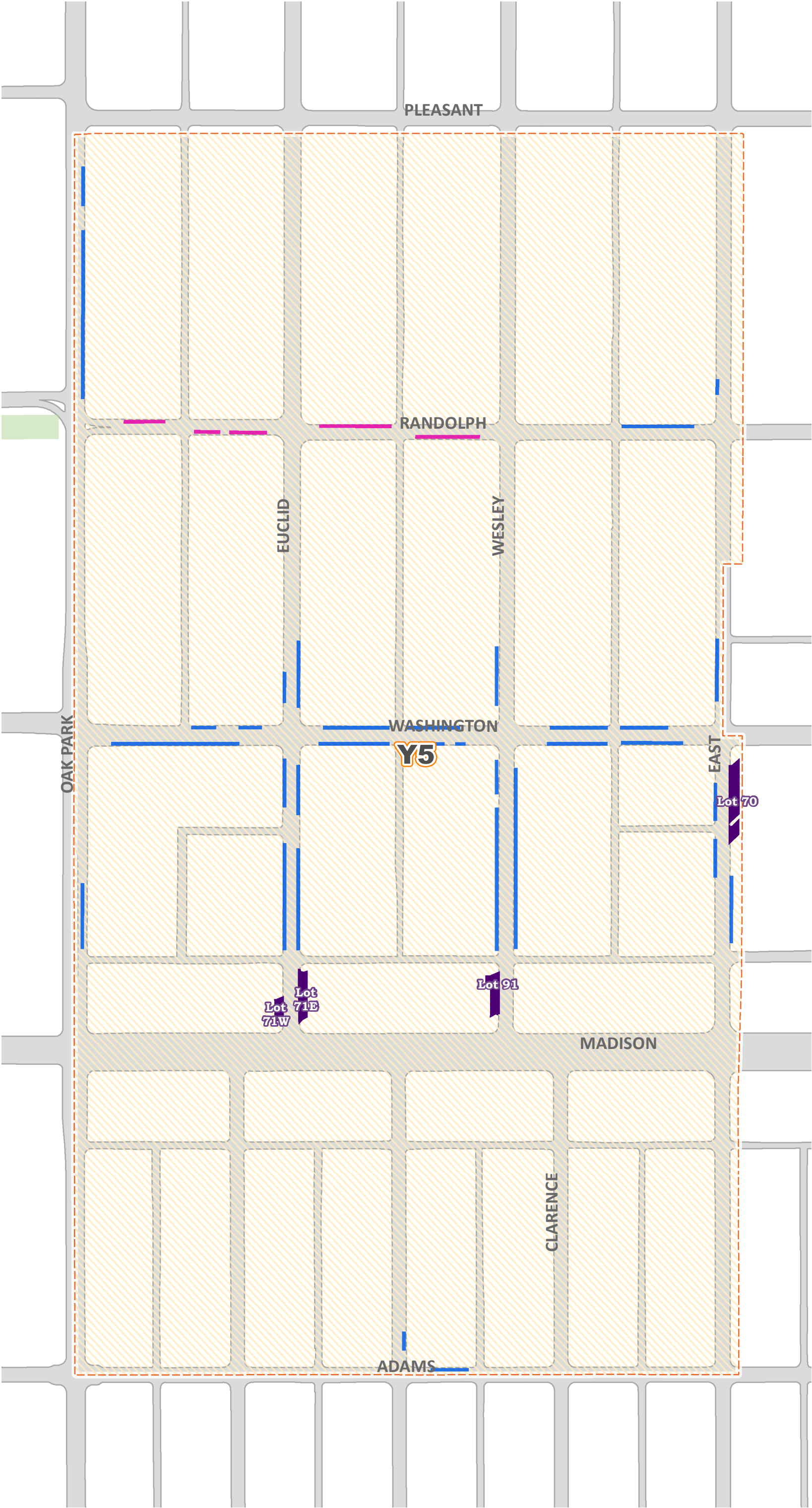

Legend

Y5 On-Street Permit Parking

Y5 On-Street Permit Parking - Extended Area

Multi-Family dwellings eligible for overnight zone permit Extended Area

0

Off-Street Lot

Multi-Family dwellings eligible for overnight zone permit

Please refer to specific permit lot/zone guidelines for additional information.

*For the interactive, online map use
www.oak-park.us/parkingmap

** This map is a graphic representation of the parking areas. Always park in areas designated by signs in the field and follow applicable guidelines.

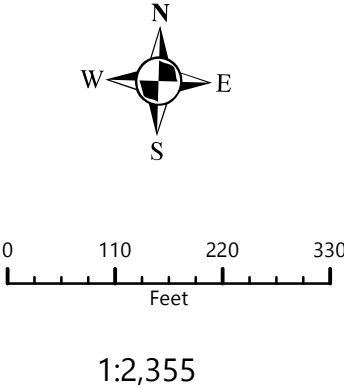

DISCLAIMER: This drawing is neither a legally recorded map nor a survey, and is not intended to be used as such. This drawing is a compilation of records, information and data located in various village, county and state offices, and other sources, affecting the land area displayed and is to be used for reference purposes only. The Village of Oak Park shall not be responsible for any inaccuracies herein contained. If discrepancies are found, please contact Parking and Mobility Services.

Parking Permit Map - Y6

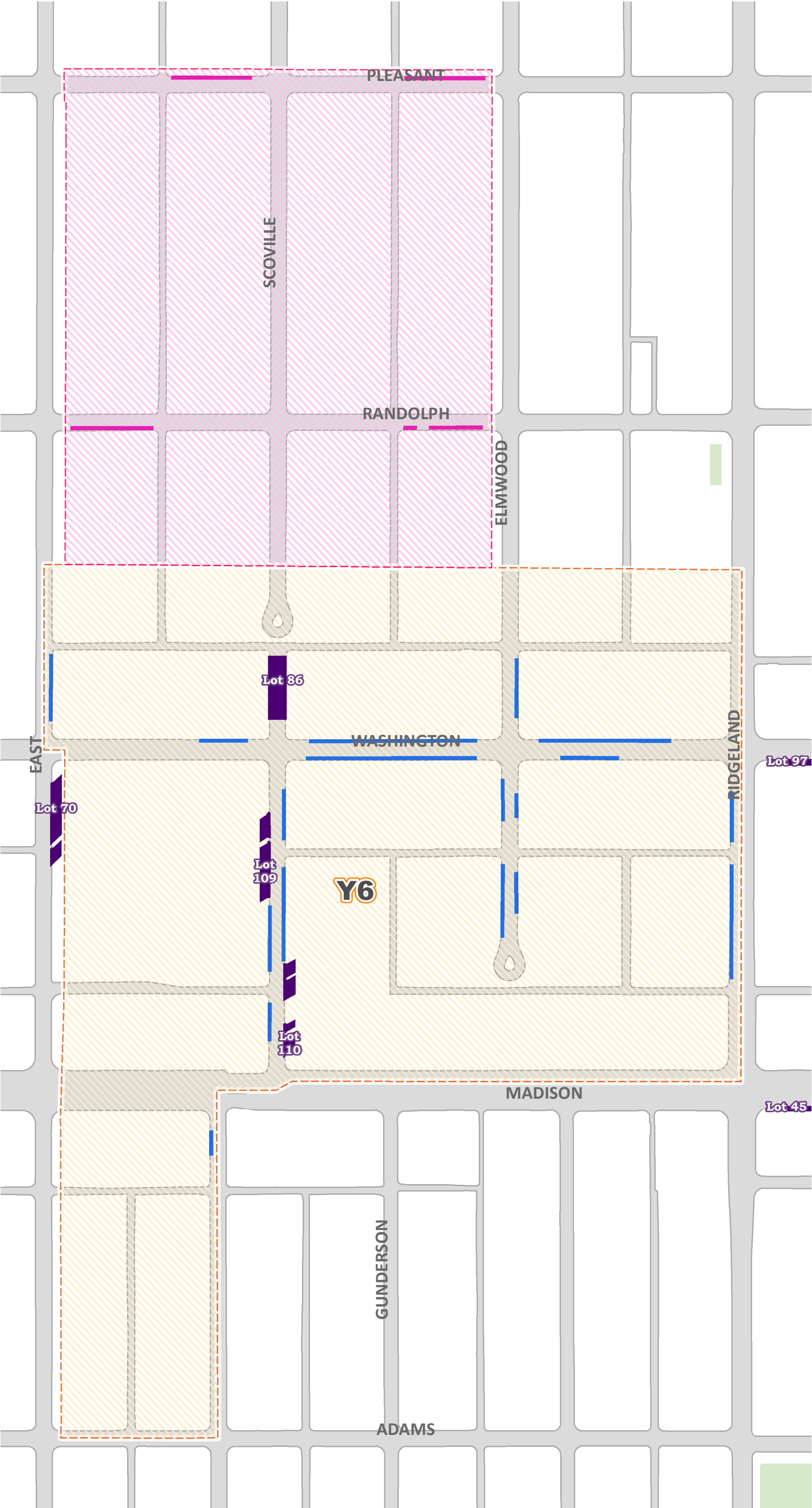

Legend

Y6 On-Street
Permit Parking

Y6 On-Street
Permit Parking -
Extended Area

Multi-Family
dwellings eligible
for overnight zone
permit Extended
Area

0

Off-Street Lot

Multi-Family
dwellings eligible
for overnight zone
permit

*Please refer to specific
permit lot/zone guidelines
for additional information.*

*For the interactive, online
map use
www.oak-park.us/parkingmap

** This map is a graphic
representation of the
parking areas. Always park
in areas designated by signs
in the field and follow
applicable guidelines.

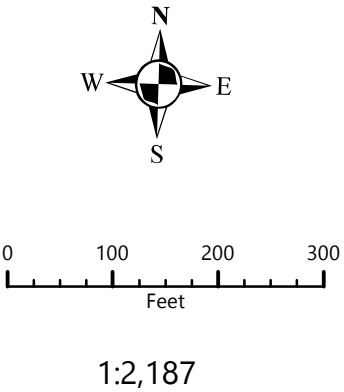

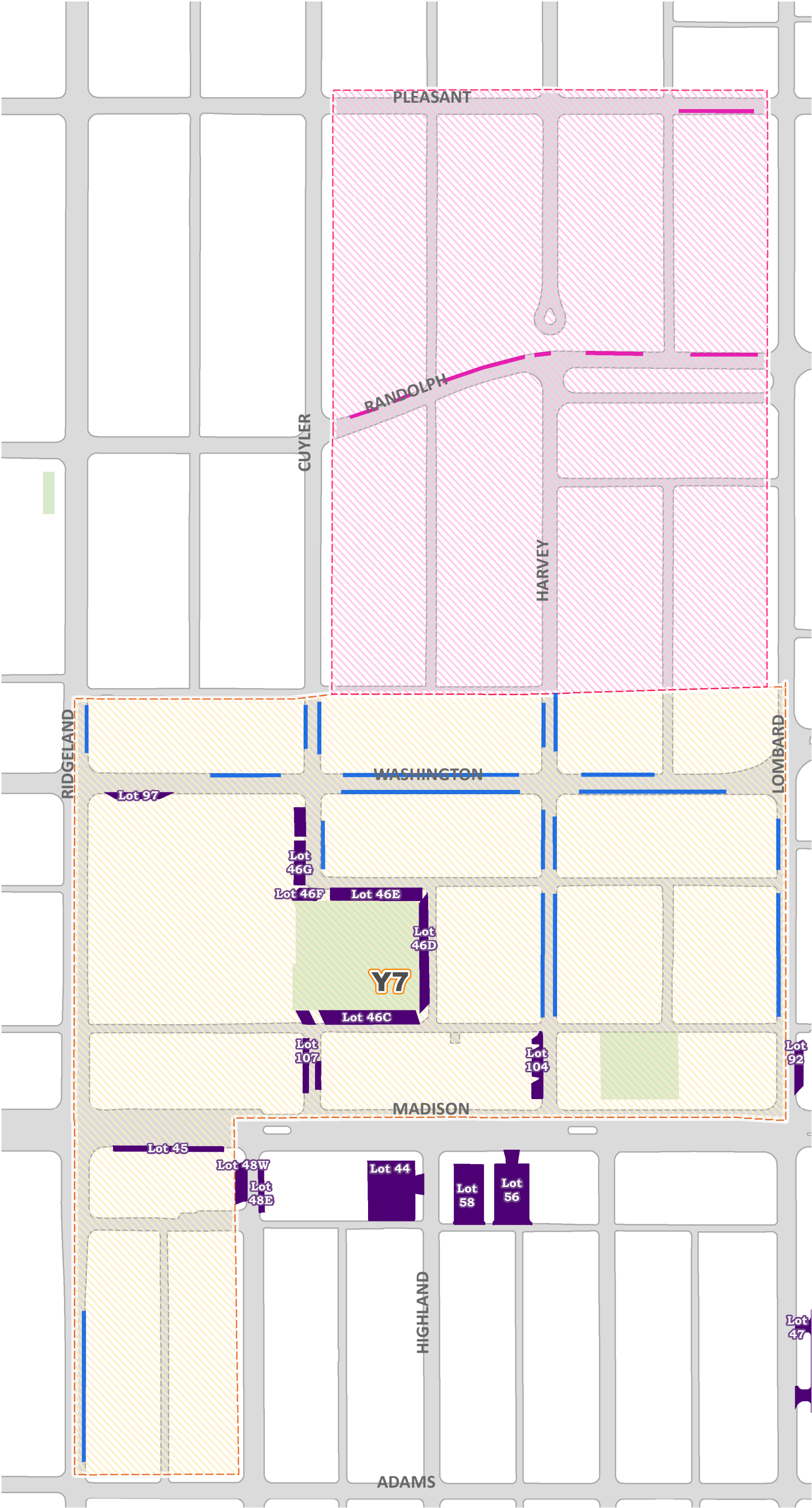

DISCLAIMER: This drawing is neither a legally
recorded map nor a survey, and is not intended
to be used as such. This drawing is a
compilation of records, information and data
located in various village, county and state
offices, and other sources, affecting the land
area displayed and is to be used for reference
purposes only. The Village of Oak Park shall not
be responsible for any inaccuracies herein
contained. If discrepancies are found, please
contact Parking and Mobility Services.

Parking Permit Map - Y7



 Y7 On-Street Permit Parking

 Y7 On-Street Permit Parking - Extended Area

 Multi-Family dwellings eligible for overnight zone permit Extended Area

 Off-Street Lot

 Multi-Family dwellings eligible for overnight zone permit

Please refer to specific permit lot/zone guidelines for additional information.

*For the interactive, online map use
www.oak-park.us/parkingmap

** This map is a graphic representation of the parking areas. Always park in areas designated by signs in the field and follow applicable guidelines.

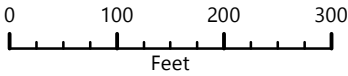

1:2,146

DISCLAIMER: This drawing is neither a legally recorded map nor a survey, and is not intended to be used as such. This drawing is a compilation of records, information and data located in various village, county and state offices, and other sources, affecting the land area displayed and is to be used for reference purposes only. The Village of Oak Park shall not be responsible for any inaccuracies herein contained. If discrepancies are found, please contact Parking and Mobility Services.



Parking Permit Map - Y8

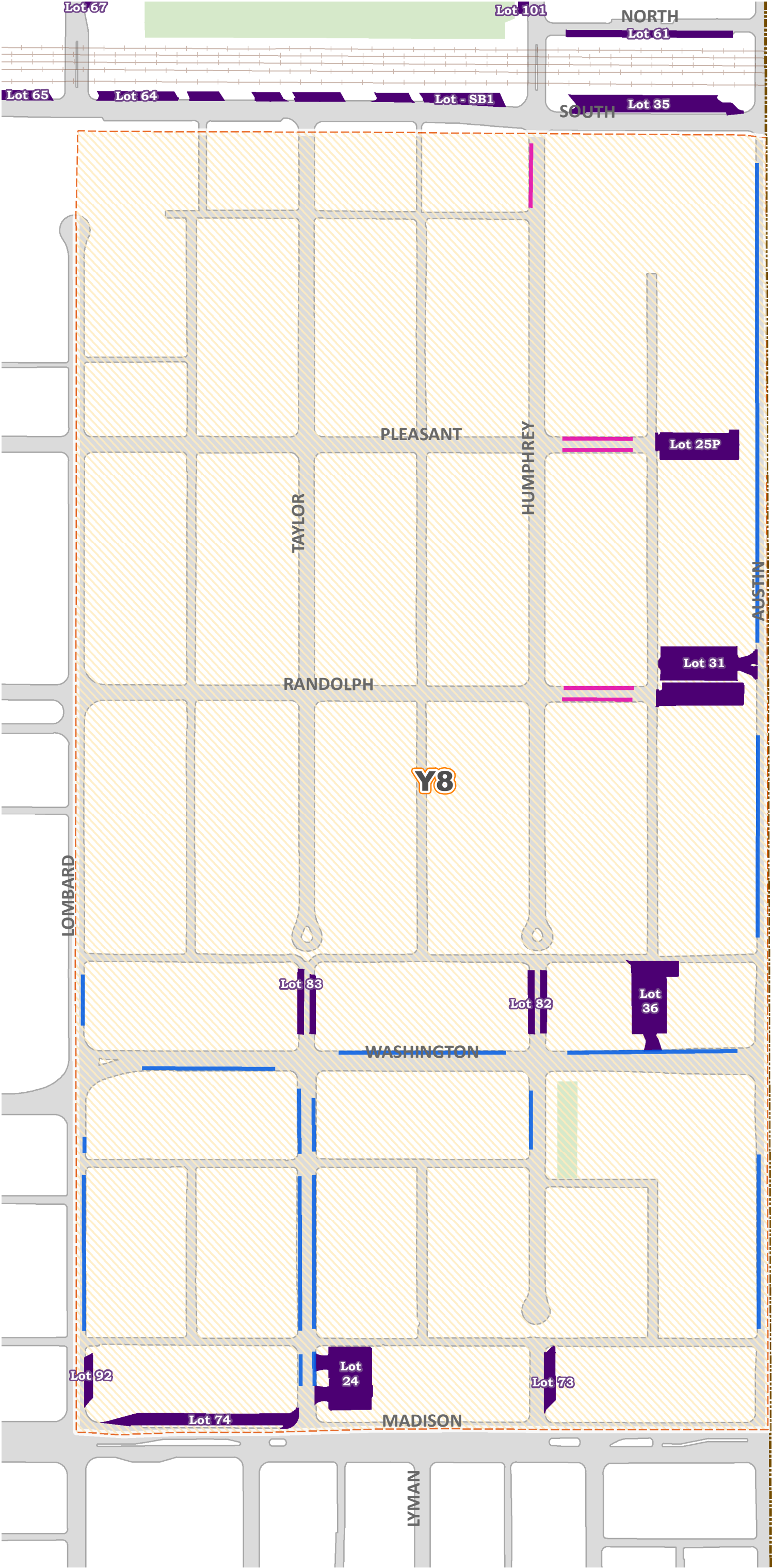

Legend

Y8 On-Street Permit Parking

Y8 On-Street Permit Parking - Extended Area

Multi-Family dwellings eligible for overnight zone permit Extended Area

0

Off-Street Lot

Multi-Family dwellings eligible for overnight zone permit

Please refer to specific permit lot/zone guidelines for additional information.

*For the interactive, online map use
www.oak-park.us/parkingmap

** This map is a graphic representation of the parking areas. Always park in areas designated by signs in the field and follow applicable guidelines.

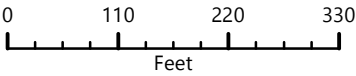

1:2,293

DISCLAIMER: This drawing is neither a legally recorded map nor a survey, and is not intended to be used as such. This drawing is a compilation of records, information and data located in various village, county and state offices, and other sources, affecting the land area displayed and is to be used for reference purposes only. The Village of Oak Park shall not be responsible for any inaccuracies herein contained. If discrepancies are found, please contact Parking and Mobility Services.

Parking Permit Map - Y9

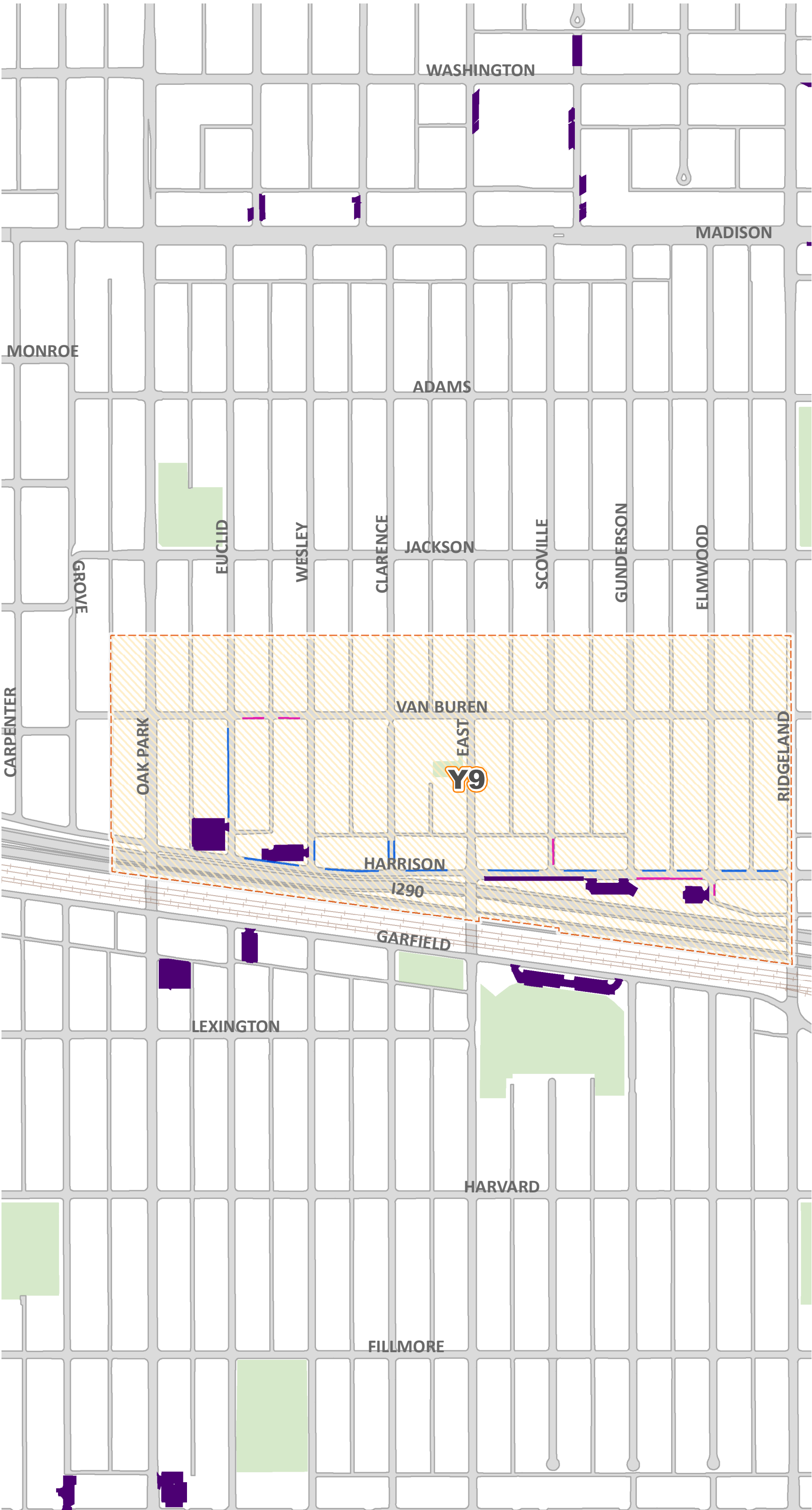

Legend

Y9 On-Street Permit Parking

Y9 On-Street Permit Parking - Extended Area

Multi-Family dwellings eligible for overnight zone permit Extended Area

0

Off-Street Lot

Multi-Family dwellings eligible for overnight zone permit

Please refer to specific permit lot/zone guidelines for additional information.

*For the interactive, online map use
www.oak-park.us/parkingmap

** This map is a graphic representation of the parking areas. Always park in areas designated by signs in the field and follow applicable guidelines.

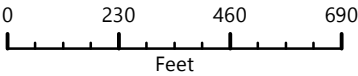
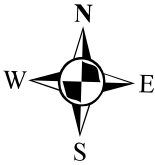

1:4,760

DISCLAIMER: This drawing is neither a legally recorded map nor a survey, and is not intended to be used as such. This drawing is a compilation of records, information and data located in various village, county and state offices, and other sources, affecting the land area displayed and is to be used for reference purposes only. The Village of Oak Park shall not be responsible for any inaccuracies herein contained. If discrepancies are found, please contact Parking and Mobility Services.



Parking Permit Map - Z1

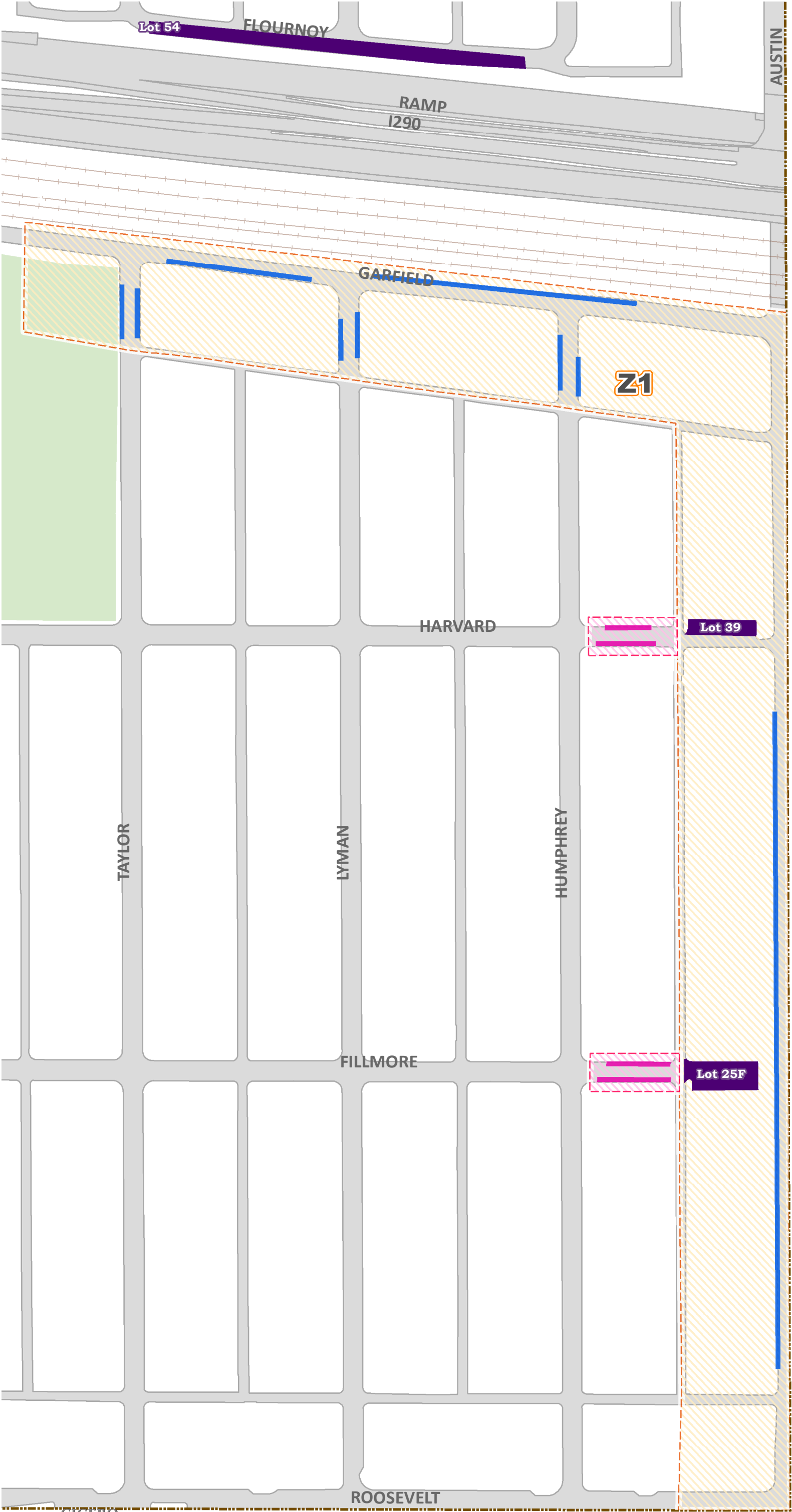

- Z1 On-Street Permit Parking
 - Z1 On-Street Permit Parking - Extended Area
 - Multi-Family dwellings eligible for overnight zone permit Extended Area
 - Off-Street Lot
 - Multi-Family dwellings eligible for overnight zone permit
- Please refer to specific permit lot/zone guidelines for additional information.*

*For the interactive, online map use
www.oak-park.us/parkingmap

** This map is a graphic representation of the parking areas. Always park in areas designated by signs in the field and follow applicable guidelines.

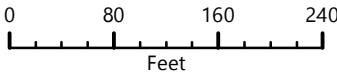

1:1,765

DISCLAIMER: This drawing is neither a legally recorded map nor a survey, and is not intended to be used as such. This drawing is a compilation of records, information and data located in various village, county and state offices, and other sources, affecting the land area displayed and is to be used for reference purposes only. The Village of Oak Park shall not be responsible for any inaccuracies herein contained. If discrepancies are found, please contact Parking and Mobility Services.

Parking Permit Map - Z2

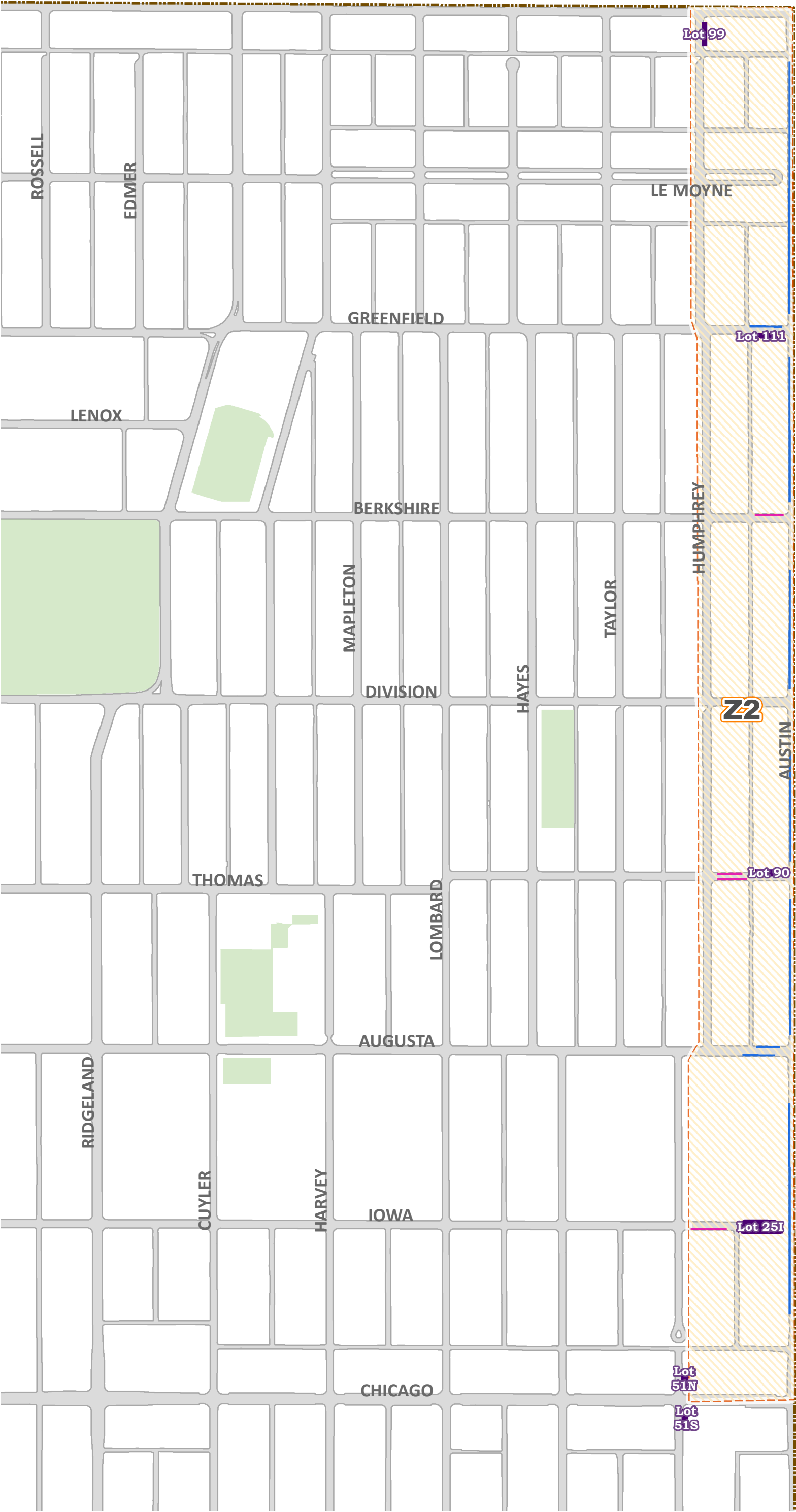

Legend

Z2 On-Street Permit Parking

Z2 On-Street Permit Parking - Extended Area

Multi-Family dwellings eligible for overnight zone permit Extended Area

0

Off-Street Lot

Multi-Family dwellings eligible for overnight zone permit

Please refer to specific permit lot/zone guidelines for additional information.

*For the interactive, online map use
www.oak-park.us/parkingmap

** This map is a graphic representation of the parking areas. Always park in areas designated by signs in the field and follow applicable guidelines.

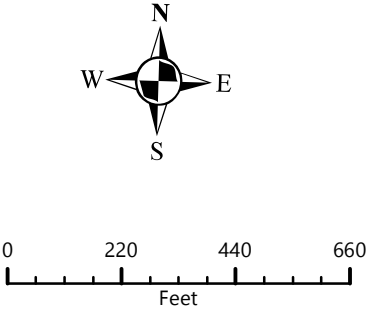

1:4,442

DISCLAIMER: This drawing is neither a legally recorded map nor a survey, and is not intended to be used as such. This drawing is a compilation of records, information and data located in various village, county and state offices, and other sources, affecting the land area displayed and is to be used for reference purposes only. The Village of Oak Park shall not be responsible for any inaccuracies herein contained. If discrepancies are found, please contact Parking and Mobility Services.

Parking Permit Map - Z3

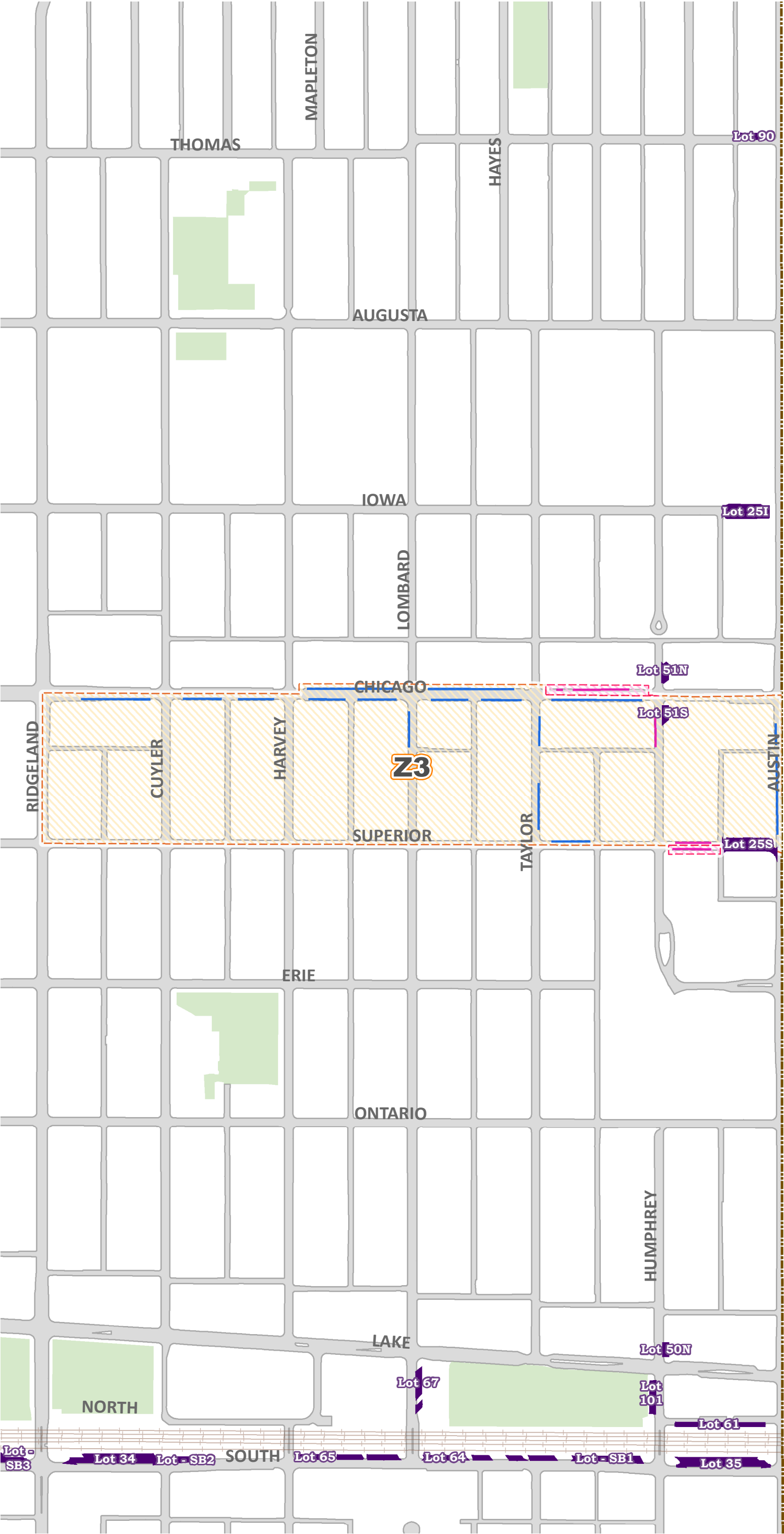

Legend

Z3 On-Street Permit Parking

Z3 On-Street Permit Parking - Extended Area

Multi-Family dwellings eligible for overnight zone permit Extended Area

0

Off-Street Lot

Multi-Family dwellings eligible for overnight zone permit

Please refer to specific permit lot/zone guidelines for additional information.

*For the interactive, online map use
www.oak-park.us/parkingmap

** This map is a graphic representation of the parking areas. Always park in areas designated by signs in the field and follow applicable guidelines.

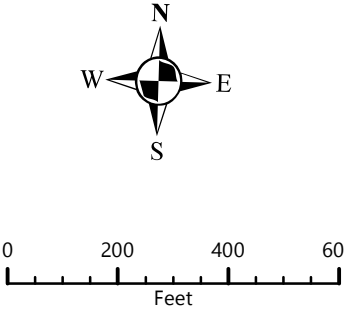

1:4,172

DISCLAIMER: This drawing is neither a legally recorded map nor a survey, and is not intended to be used as such. This drawing is a compilation of records, information and data located in various village, county and state offices, and other sources, affecting the land area displayed and is to be used for reference purposes only. The Village of Oak Park shall not be responsible for any inaccuracies herein contained. If discrepancies are found, please contact Parking and Mobility Services.

Parking Permit Map - Z4

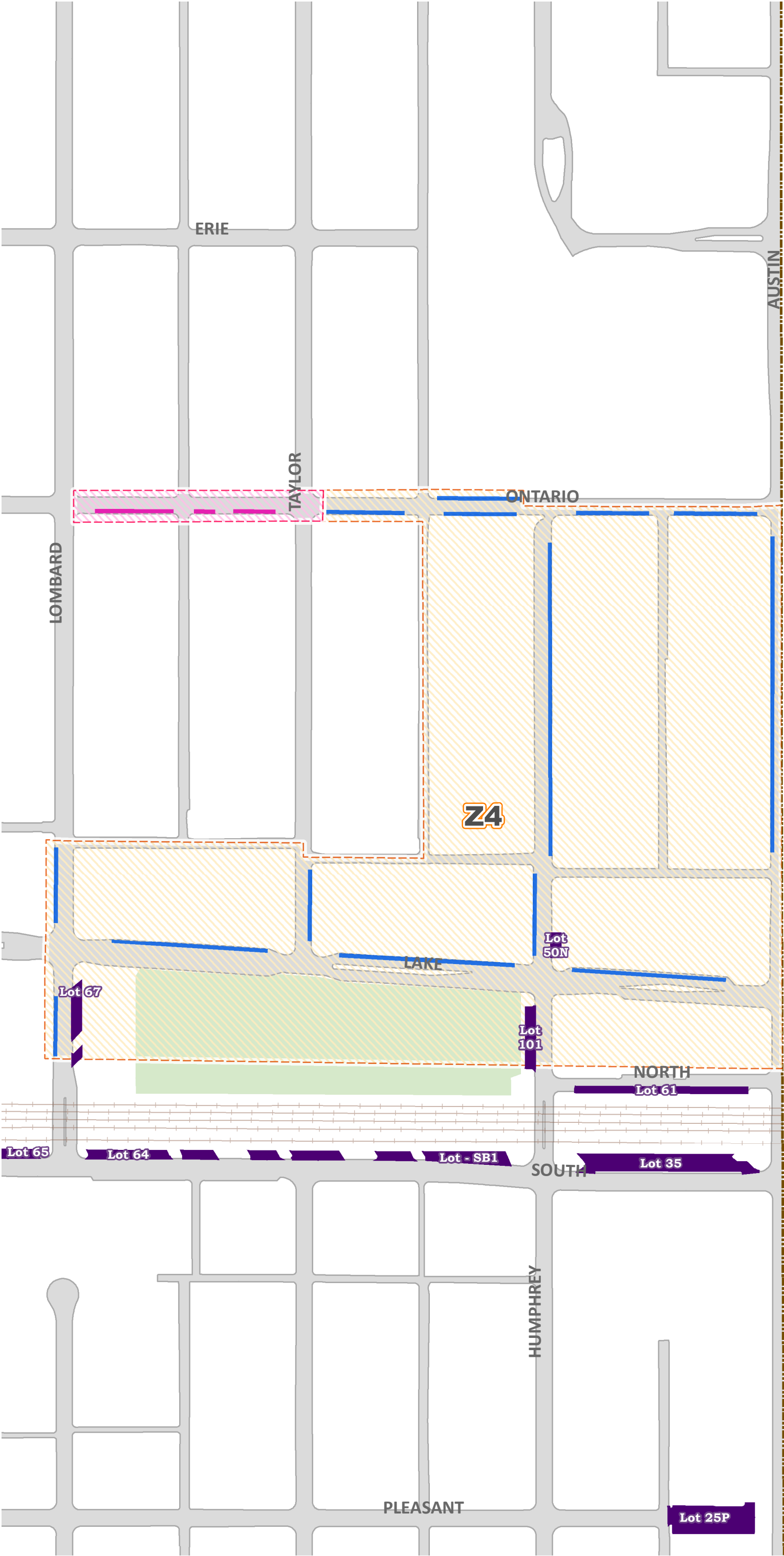

Legend

Z4 On-Street Permit Parking

Z4 On-Street Permit Parking - Extended Area

Multi-Family dwellings eligible for overnight zone permit Extended Area

0

Off-Street Lot

Multi-Family dwellings eligible for overnight zone permit

Please refer to specific permit lot/zone guidelines for additional information.

*For the interactive, online map use
www.oak-park.us/parkingmap

** This map is a graphic representation of the parking areas. Always park in areas designated by signs in the field and follow applicable guidelines.

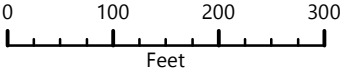



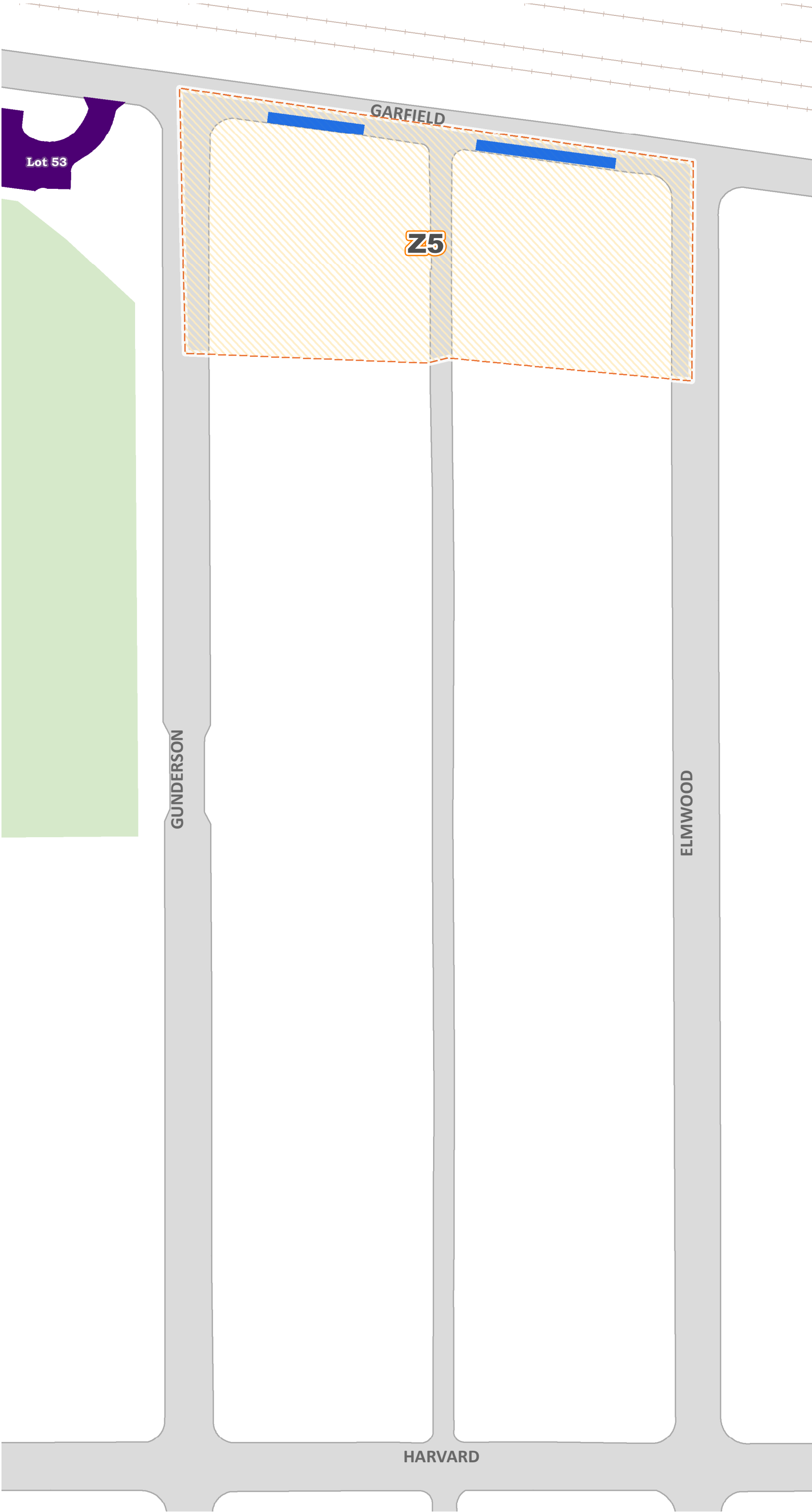

1:2,182

DISCLAIMER: This drawing is neither a legally recorded map nor a survey, and is not intended to be used as such. This drawing is a compilation of records, information and data located in various village, county and state offices, and other sources, affecting the land area displayed and is to be used for reference purposes only. The Village of Oak Park shall not be responsible for any inaccuracies herein contained. If discrepancies are found, please contact Parking and Mobility Services.

Parking Permit Map - Z5



-  Z5 On-Street Permit Parking
 -  Z5 On-Street Permit Parking - Extended Area
 -  Multi-Family dwellings eligible for overnight zone permit Extended Area
 -  Off-Street Lot
 -  Multi-Family dwellings eligible for overnight zone permit
- Please refer to specific permit lot/zone guidelines for additional information.*

*For the interactive, online map use
www.oak-park.us/parkingmap

** This map is a graphic representation of the parking areas. Always park in areas designated by signs in the field and follow applicable guidelines.

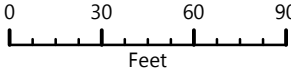
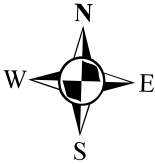

1:750

DISCLAIMER: This drawing is neither a legally recorded map nor a survey, and is not intended to be used as such. This drawing is a compilation of records, information and data located in various village, county and state offices, and other sources, affecting the land area displayed and is to be used for reference purposes only. The Village of Oak Park shall not be responsible for any inaccuracies herein contained. If discrepancies are found, please contact Parking and Mobility Services.

Parking Permit Map - Z6

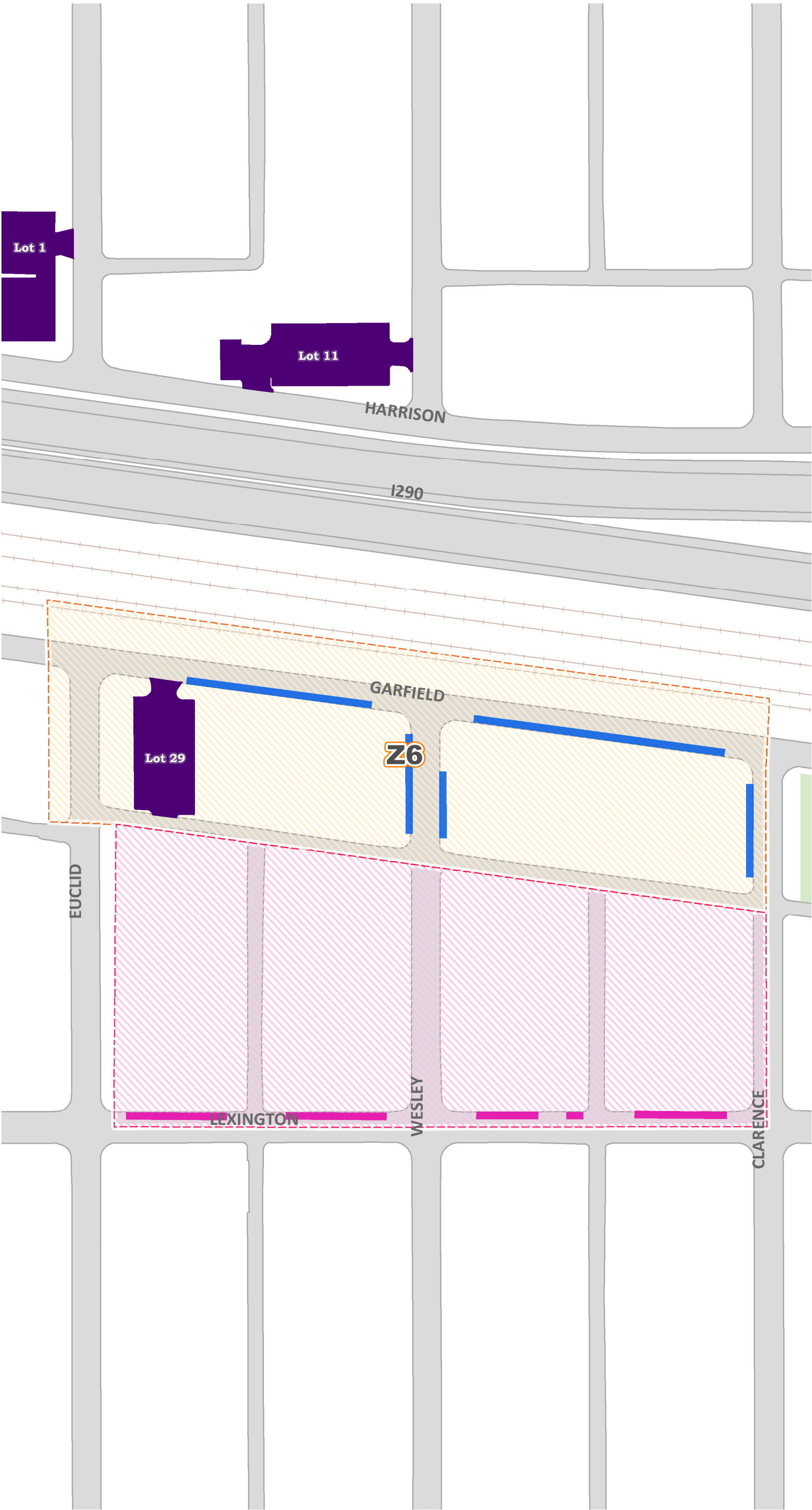

Legend

Z6 On-Street Permit Parking

Z6 On-Street Permit Parking - Extended Area

Multi-Family dwellings eligible for overnight zone permit Extended Area

0

Off-Street Lot

Multi-Family dwellings eligible for overnight zone permit

Please refer to specific permit lot/zone guidelines for additional information.

*For the interactive, online map use
www.oak-park.us/parkingmap

** This map is a graphic representation of the parking areas. Always park in areas designated by signs in the field and follow applicable guidelines.

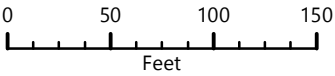

1:1,118

DISCLAIMER: This drawing is neither a legally recorded map nor a survey, and is not intended to be used as such. This drawing is a compilation of records, information and data located in various village, county and state offices, and other sources, affecting the land area displayed and is to be used for reference purposes only. The Village of Oak Park shall not be responsible for any inaccuracies herein contained. If discrepancies are found, please contact Parking and Mobility Services.

Parking Permit Map - Z7

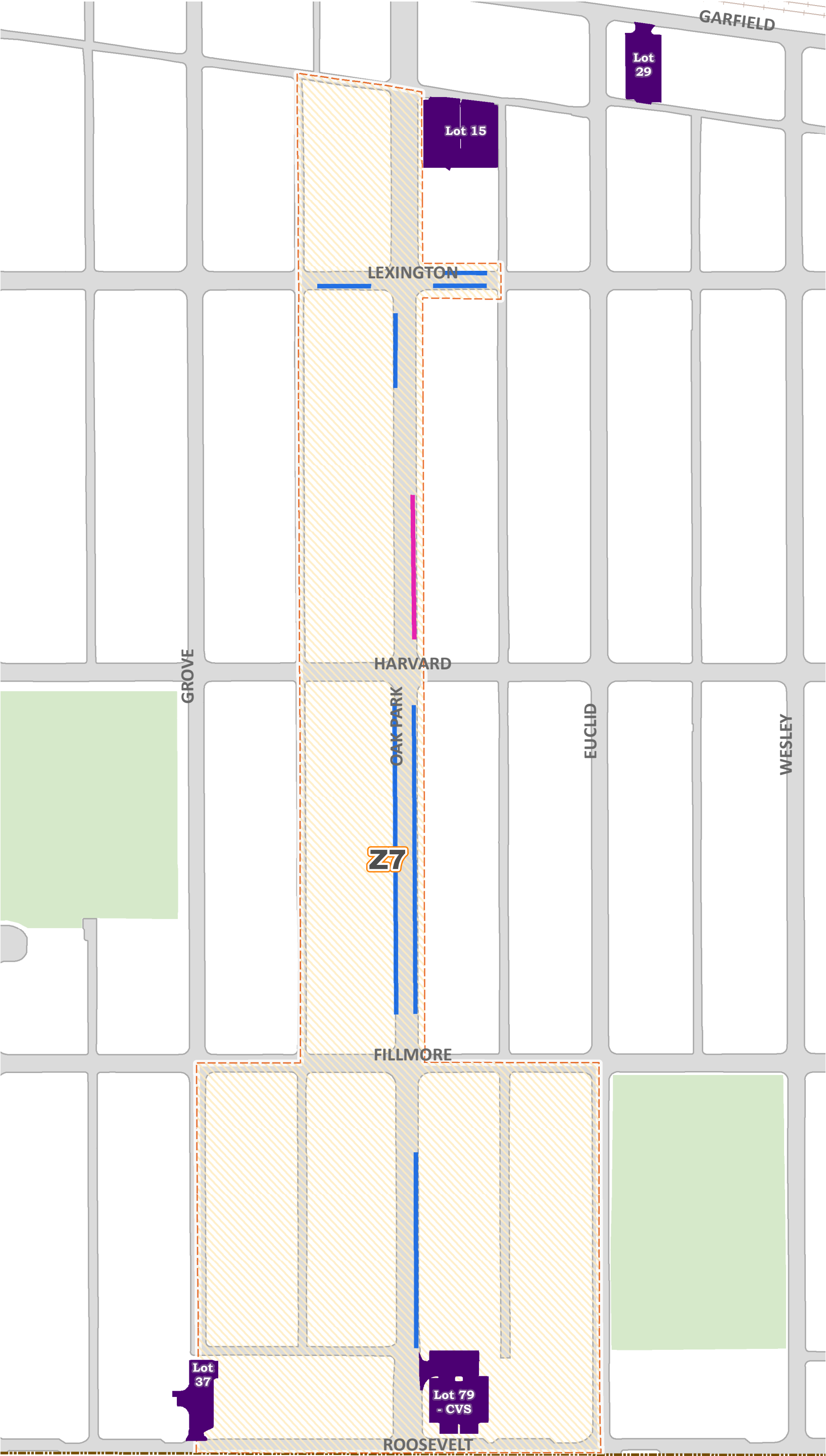

Legend

Z7 On-Street Permit Parking

Z7 On-Street Permit Parking - Extended Area

Multi-Family dwellings eligible for overnight zone permit Extended Area

Off-Street Lot

Multi-Family dwellings eligible for overnight zone permit

Please refer to specific permit lot/zone guidelines for additional information.

*For the interactive, online map use
www.oak-park.us/parkingmap

** This map is a graphic representation of the parking areas. Always park in areas designated by signs in the field and follow applicable guidelines.

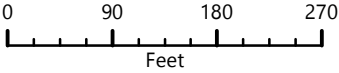

1:1,978

DISCLAIMER: This drawing is neither a legally recorded map nor a survey, and is not intended to be used as such. This drawing is a compilation of records, information and data located in various village, county and state offices, and other sources, affecting the land area displayed and is to be used for reference purposes only. The Village of Oak Park shall not be responsible for any inaccuracies herein contained. If discrepancies are found, please contact Parking and Mobility Services.

Parking Permit Map - Z9

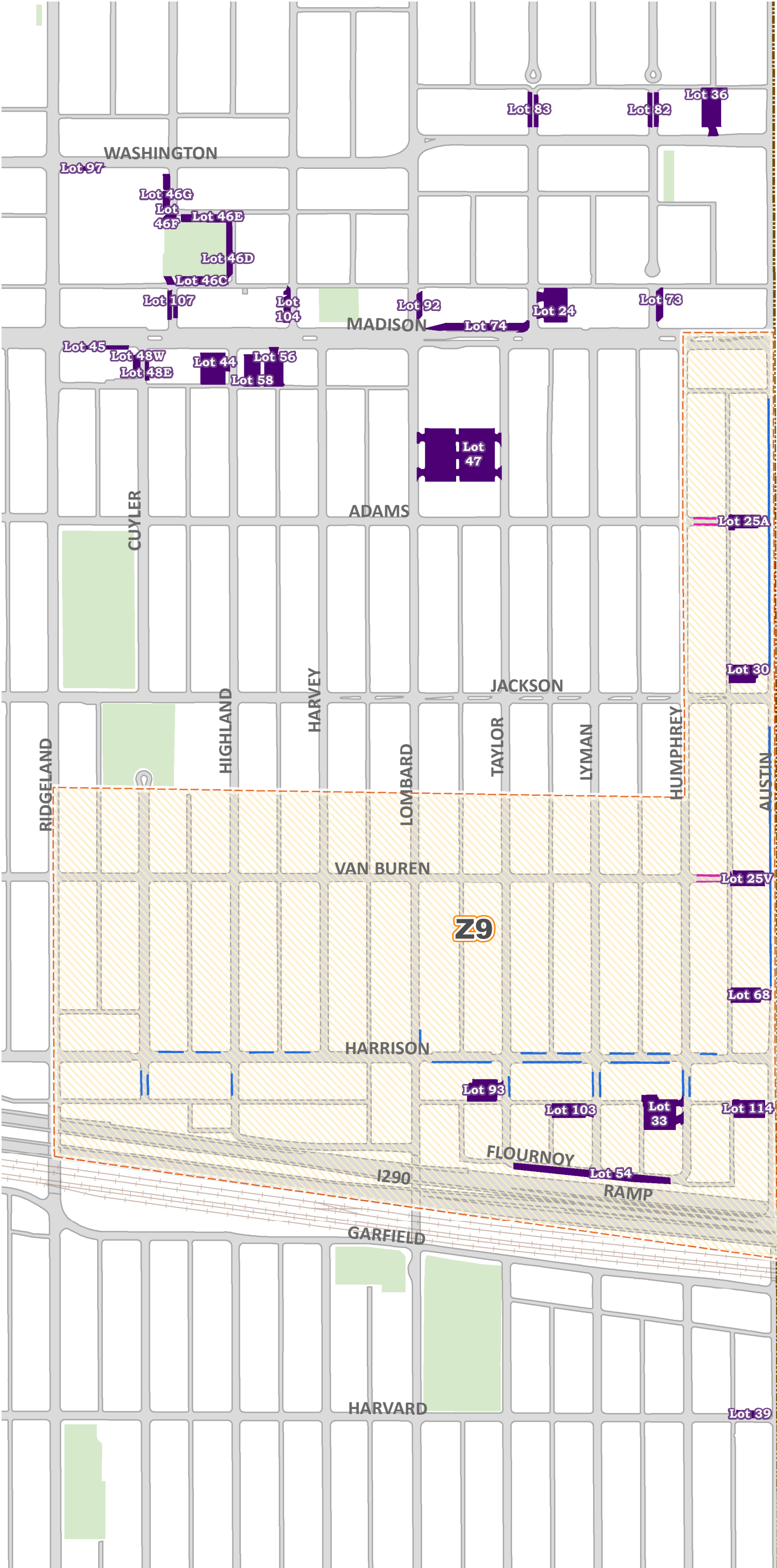

Legend

Z9 On-Street Permit Parking

Z9 On-Street Permit Parking - Extended Area

Multi-Family dwellings eligible for overnight zone permit Extended Area

Off-Street Lot

Multi-Family dwellings eligible for overnight zone permit

Please refer to specific permit lot/zone guidelines for additional information.

*For the interactive, online map use
www.oak-park.us/parkingmap

** This map is a graphic representation of the parking areas. Always park in areas designated by signs in the field and follow applicable guidelines.

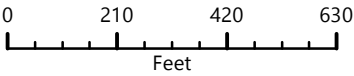

1:4,409

DISCLAIMER: This drawing is neither a legally recorded map nor a survey, and is not intended to be used as such. This drawing is a compilation of records, information and data located in various village, county and state offices, and other sources, affecting the land area displayed and is to be used for reference purposes only. The Village of Oak Park shall not be responsible for any inaccuracies herein contained. If discrepancies are found, please contact Parking and Mobility Services.